

E-Pay Taxes Online

https://payments.municipalpay.com/nc_brunswick

ACH/E-check payments are free,
 Visa/Mastercard/Amex/Discover fee will be 2.65%
 (minimum fee \$2.00).

Brunswick County Tax Office (North Carolina) - Tax Bill Search



Return to Brunswick County Website

[Basic Search](#) [Real Estate Search](#) [Tax Bill Search](#) [Sales Search](#) [Help](#)

Hide

Owner Last Name: Horton Owner First Name: Gregory Account #:

Parcel #: PARCEL ALPHA PIN

Tax Year: Bill #: Unpaid Bills Only: Sort By:

Search Results

click on a tax bill below to continue

Hide

Year Bill#	Account#	Owner Name	Owner Name2	Orig Levy	Balance	Disc	Year	Property ID	Property Address
2025 074254	80136040	HORTON GREGORY WAYNE ETUX		2,003.32	2,039.38	0		157KC006	930 PALMETTO RD SOUTHPORT

[Selected Tax Bill Info](#) [View Appraisal Card](#)

Account#: 80136040	Bill#: 074254	Last Trans Date:	Building Value: 231,190	Current Bala
HORTON GREGORY WAYNE ETUX	Parcel#: 157KC006	Last Payment :	Outbuilding Value: 28,220	Original Levy
HORTON DIANE MAXWELL	Pin#: 219017221474		Land Value: 35,250	Personal Val
930 PALMETTO RD	Status:		Parcel Value Total: 294,660	Total Valuati
SOUTHPORT NC 28461-9664	Legal Description: L-21R B-PART-1 S-20 BOILING SPRING LAKES PL 130/94 1.000LT		Deferred Value: 0	Exemption:
930 PALMETTO RD SOUTHPORT	View Parcel Profile		Taxable Value: 294,660	

Taxes and Fees Billed By County

Description	Levied	Interest/Fees	Released	Collected
BOILING SPRING LAKES AD VALOREM INTEREST	0.00	15.91	0.00	0.00
COUNTY AD VALOREM INTEREST	0.00	20.15	0.00	0.00
BSL FIRE	200.00	0.00	0.00	0.00
BOILING SPR LAKES	795.58	0.00	0.00	0.00
BRUNSWICK COUNTY	1,007.74	0.00	0.00	0.00
Totals	2,003.32	36.06	0.00	0.00

Payment History

No Payment History found for this tax bill

All information on this site is prepared for the inventory of real and personal property found within Brunswick County. All data is compiled from recorded deeds, plats, and other public records and data. Users of this data are hereby notified that the aforementioned public information sources should be consulted for verification of the information. All information contained herein was created for the Brunswick County's internal use. Brunswick County, its employees and agents make no warranty as to the correctness or accuracy of the information set forth on this site whether express or implied, in fact or in law, including without limitation the implied warranties of merchantability and fitness for a particular use.

If you have any questions about the data displayed on this website please contact the Brunswick County Tax Administration at (910) 253-2829.

1.7.96.276



Brunswick NC - Property Record Card

Brunswick NC - Property Record Card

Parcel # 157KC006
930 PALMETTO RD

HORTON GREGORY WAYNE ETUX,
HORTON DIANE MAXWELL,
- 109 NE 1ST ST -,
OAK ISLAND, NC, 28465

KEY INFORMATION

Township	02
Neighborhood	205E / BSL SOUTH OF 50 LAKES
Legal Land Type	LT
Legal Land units	1.0000

ASSESSMENT DETAILS

Revaluation Year	2023
Tax Year	2026
Land Value	\$35,250
Building Value	\$231,190
Outbuilding or Extra Features	\$28,220
Total Market Value	\$294,660
Deferred Value	\$0
Total Assessed Value	\$294,660

BUILDING DETAILS

BUILDING 1

Building Number	1
Improvement Type	01 - SINGLE FAMILY RESIDENTIAL
Valuation Model	01 - SFR CONSTRUCTION
Quality	3 - AVERAGE
Actual Year Built	2013
Heated Area	1,495 sqft
Bedrooms	3
Full Bath	2
Half Bath	0

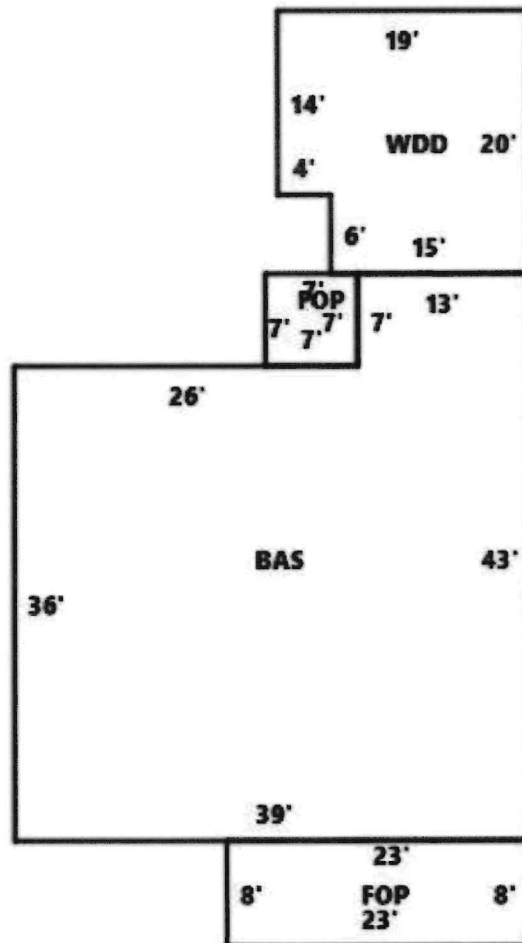

OUTBUILDINGS AND EXTRA FEATURES

CODE	DESCRIPTION	ACTUAL YEAR BUILT
------	-------------	-------------------

DEED DATE	DEED BOOK/PAGE	SAL
10/27/2022	04930/ 0645	\$36,
10/27/2022	04930/ 0637	\$0
06/14/2021	04640/ 0233	\$20,
06/14/2021	04640/ 0820	\$25
07/25/2014	03549/ 1380	\$14
11/28/2012	03340/ 0790	\$0
11/09/2012	03334/ 0325	\$7,0
03/02/2010	03024/ 0965	\$0
12/15/2006	02524/ 0714	\$0
10/01/2002	01641/ 1149	\$7,0
04/01/2002	01575/ 0354	\$0
08/01/2001	01491/ 0442	\$0
01/01/1753	00401/ 0172	\$0

