

MOORE COUNTY HEALTH DEPARTMENT
ENVIRONMENTAL HEALTH SECTION
SUBSURFACE SEWAGE DISPOSAL SYSTEM
PERMANENT RECORD

LRK 00054827
228 Windy Hill Rd
Riley, Jean
3 Bedroom Septic

Installer R. Crissman Phone 647-5648
Address W. Hope
Tank Capacity exit Tank I.D. # —
Nitrification Line Dimensions 2 @ 75x35
Distribution Box ye Gravel Depth 12"
Depth To: Top of Tank — Trench Bottom (Average) 24"
Pump — Size — Brand Name — Pump Tank Capacity —

Diagram of Actual Installation (Depict Property Boundaries, Driveways, Trees, Water Lines, Water Supplies, Etc.)

Comments: Install to layout with one step down @ oak tree
20' into lowest line

Approved By: Charles [Signature] Date: 3/22/03



MOORE COUNTY HEALTH DEPARTMENT ENVIRONMENTAL HEALTH SECTION

P. O. BOX 279, Carthage, N. C. 28327

Phone: 947-2858

Repair IMPROVEMENT PERMIT

Property Identification # _____

Owner Johnny & Jean Riley

Address P.O. Box 279 Windy Hill Road Phone No. 919-281-5511

Exact Directions to Property 1st House on Rt - Windy Hill Rd - off Hwy #1

Lot Area 1.92 ACRES Maximum Long-Term Acceptance Rate 0.8
(From Site Evaluation)

Daily Design Sewage Flow Rate (From Application) 360

Septic Tank Capacity ±1000 - existing Pump -

Distribution Box yes Pump Tank Capacity -

Depth of Gravel 12' Maximum-Trench Depth 19"-36"

Dimensions of Nitrification Lines 2 @ 75X3'

Type of Water Supply well If Well, What Type drill - 300+

Distance To: Water Supplies > 100 Lakes, Streams, Etc. -

Easement Obtained (If Necessary) - Repair Area Required -

Diagram of Proposed Installation

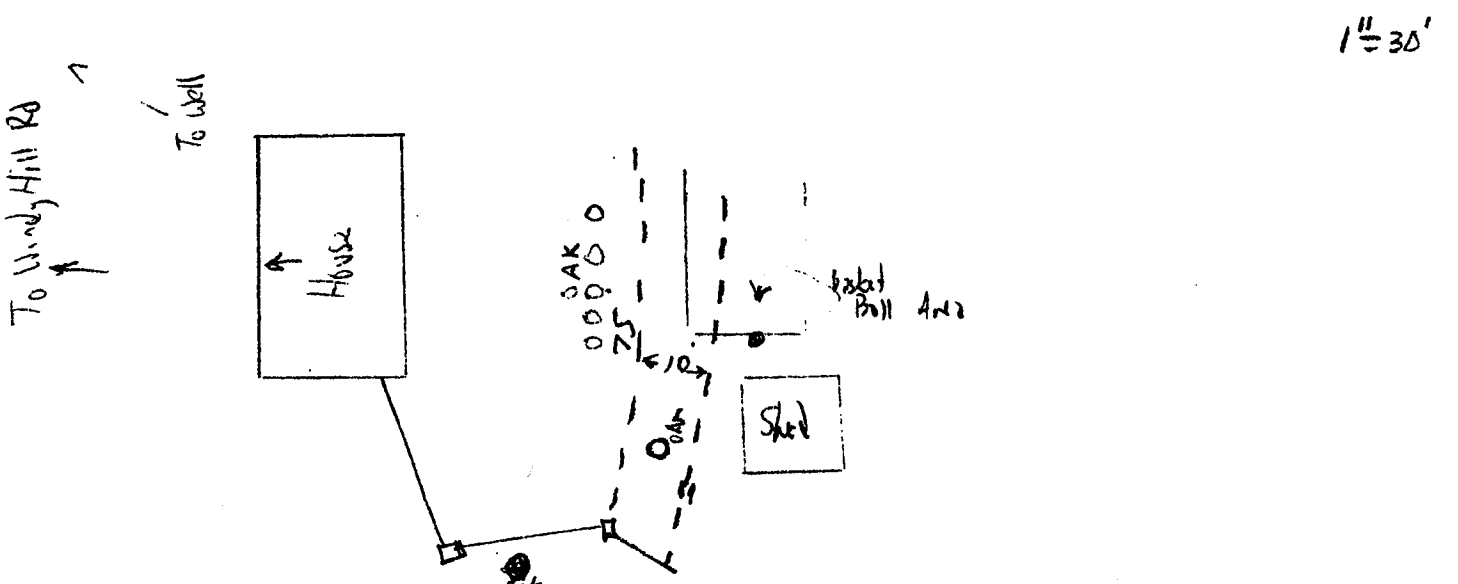

Comments/Conditions:

Permit Issued By: [Signature] Date: 4/7/92

Approved By: [Signature] Date: 3/22/92

This Permit Expires 60 Months From Date of Issuance and is Subject to Revocation if Site Plans or the intended use of the Property Changes.

White Copy (Owner's Copy)

Pink Copy (Electrical Inspector)

Hard Copy (Office)