

Wilson County Parcel Report

PIN:	3743-67-5463.000
Parcel Number:	3743675463.000
Current Owner ID:	
Owner & Address:	MANNA BIBLE COLLEGE INC PO BOX 4734
Date Sold:	1624233600000
Deed Reference:	2799 - 494
Deed Year:	2021
Plat Reference:	-
Deed Acres:	12.48
Actual Year Built:	
Effective Year Built:	
Main Improvement	
Finished Area:	
Tax Year:	2026
Assessed Current	
Land Value:	\$32,900
Assessed Current	
Improvement Value:	\$0
Total Assessed	
Current Value:	\$32,900
Current Land Use	
Yes or No:	Y
Current Land Use Value:	\$32,900
Current Land	
Fair Market Value:	\$88,300
Current Improvement	
Fair Market Value:	\$0
Current Total	
Fair Market Value:	\$88,300
Grantor:	MANNA BIBLE COLLEGE INC ,
Previous ParcelNumber:	
Previous Deed Reference:	2799 494
Plat Book/Page:	42-29
Legal Description:	4713 A ROSEBUD CHURCH RD GLOVER LD 12.48
Sales Amount:	\$0
Sales Instrument:	SPL
Sales Instrument Description:	SPLIT
Sales Disqualification Code:	Y
Sales Disqualification Code Description:	SPLIT/COMBINATION
Date Sold:	20210621
Vacant Improved Code:	Y
Land Current Usage Code:	
Land Rate:	-
Fair Market Value	
Land Rate Code:	
Parcel Description Code 1:	-
Parcel Description Code 2:	R - RESIDENTIAL
Multiple Land Segments:	
GIS Calculated Acres	
of Selected Polygon:	12.48

Quantity:	
Road Frontage:	-
Current Use Code Main Improvement:	
Main Improvement Description Code:	-
Main Improvement Description:	RESIDENTIAL -
Construction Quality Grade Description Code:	-
Depreciation Table:	
Number of Bedrooms:	
Number of Full Bathrooms:	
Number of Half Bathrooms:	
HVAC:	- SF
Fireplace Yes or No:	N -
Basement Yes or No:	N -
Attached Garage Yes or No:	N -
Percent of Construction Complete:	%
Number of Improvements:	0
Neighborhood Code:	8121 - GARDNERS
City:	-
Tax District:	23 - C/SW/TOISNOT FD
Township:	8 - GARDNERS
Area:	23 - C/SW/TOISNOT FD

Vicinity Map

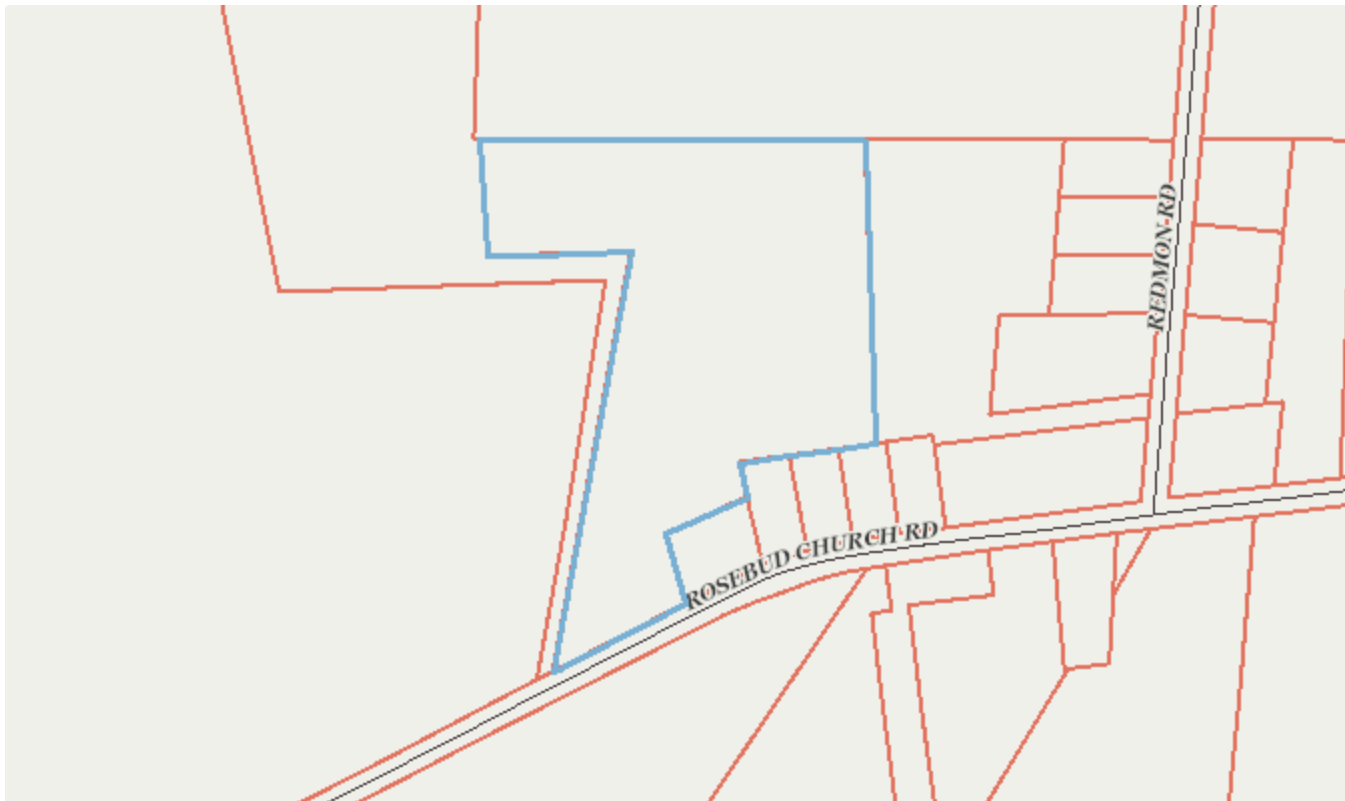

Orthophotography Map

