



Brunswick County Environmental Health Services
Water Protection Section

BCHS File Number: 2000055922A1

Tax Parcel: 173BN012

New Repair Abandonment

Owner's Name: FLCI HOLDINGS LLC

Property Address: _____

Subdivision: BOILING SPRING LAKES Lot: 5 Block: C Section: 5

Project Type: Residential or Commercial

Well Permit

Well must be installed in accordance with 15A NCAC 02C and/or 15A NCAC 18A.1700

• The following items shall be completed and inspected prior to the issuance of the Certificate of Completion (COC):

- Well construction record (GW-1a) submitted to BCHS
 - Well contractor identification plate installed
 - Threadless sample tap turned downward and at least 12 inches above the land surface installed
 - The well head should be sealed
 - Pump installation plate installed
 - A 12 inch minimum casing height above the land surface shall be provided
- Maintain the following setback to any septic system: 50 feet or 100 feet
 - Maintain the following setback to any structure: 25 feet or 50 feet
 - Maintain the following setback to any animal barn: 50 feet or 100 feet
 - Search has been completed per 15A NCAC 02C.0304(b).
 - Maintain 50 feet to any pond, lake, and/or reservoir.
 - Maintain 25 feet to brooks, creeks, streams, rivers, sounds, bays, and/or tidal estuaries.
 - The existing well shall be properly abandoned. A well abandonment record (GW-30) shall be submitted to BCHS.
 - The well shall be installed in accordance with the attached variance.
 - A 4 inch thick concrete floor, extending at least three feet horizontally around the outside of the casing, shall be provided.
 - Other: _____

- Permit action may be required if the well location is changed or information submitted in the application was inaccurate.
- Issuance of Certificate of Completion is not to be taken as a guarantee of the quality of water obtained from the well.

Well Permit Issuance Date: 12/31/2025 Well Permit Expires 5 Years From Issuance Date

REHS Signature: *Dustin S.* REHS Registration Number: 2816

See Well Permit Site Plan for Well Location and Further Detail

Grout Inspection

Grout Inspection Witnessed By REHS Grout Inspection Not Witnessed By REHS
REHS Signature: *[Signature]* Date Of Grout Placement: 4/29/26

Well Abandonment

Well Abandoned By: _____ Date of Well Abandonment: _____

Certificate of Completion

Well Installer Name: Tommy Robinson Well Driller Certification Number: 2689
Date Well Installed: 4/29/26 GPS Coordinates: 34.0178° N 78.0407° W
REHS Signature: *[Signature]* Date Of COC: 5/11/26

Owner/Authorized Agent must contact BCHS (910-253-2150) for water sample collection once the well has been properly disinfected and power is provided



Location Requirements For Domestic Drinking Water Wells

15A NCAC 02C .0107 STANDARDS OF CONSTRUCTION: WATER SUPPLY WELLS

(a) Location

(1) A water supply well shall not be located in any area where surface water or runoff will accumulate around the well due to depressions, drainage ways, and other landscapes that will concentrate water around the well.

(2) The horizontal separation between a water supply well and potential sources of groundwater contamination that exist at the time the well is constructed shall be no less than as follows unless otherwise specified in Subparagraph (a)(3) of this Rule:

- A. Single-family dwelling with septic tank and drainfield, including the drainfield repair area: 50 feet
B. Single-family dwelling with septic tank and drainfield, including the drainfield repair area in saprolite system as described in 15A NCAC 18A .1956: 100 feet
C. All other facilities with septic tank and drainfield, including drainfield repair area: 100 feet
D. Other subsurface ground absorption waste disposal system: 100 feet
E. Industrial or municipal residuals disposal or wastewater-irrigation sites: 100 feet
F. Industrial or municipal sewage or liquid-waste collection or sewer main, constructed to water main standards in the American Water Works Association (AWWA) Standards C600 and/or C900, which can be obtained from AWWA at American Water Works Association, 6666 West Quincy Avenue, Denver, CO 80235, at a cost of one hundred and four dollars (\$104.00): 50 feet
G. Water-tight sewer lateral line from a residence or other non-public system to a sewer main or other wastewater disposal system: 25 feet
H. Other sewage and liquid-waste collection or transfer facility: 100 feet
I. Cesspools and privies: 100 feet
J. Animal feedlots, as defined by G.S. 143-215.10B(5), or manure or litter piles: 100 feet
K. Fertilizer, pesticide, herbicide, or other chemical storage areas: 100 feet
L. Non-hazardous waste storage, treatment, or disposal lagoons: 100 feet
M. Sanitary landfills, municipal solid waste landfill facilities, incinerators, construction and demolition (C&D) landfills, and other disposal sites except Land Clearing and Inert Debris landfills: 500 feet
N. Land Clearing and Inert Debris (LCID) landfills: 100 feet
O. Animal barns: 100 feet
P. Building perimeters, including any attached structures that need a building permit, such as garages, patios, or decks, regardless of foundation construction type: 25 feet
Q. Surface water bodies that act as sources of groundwater recharge, such as ponds, lakes, and reservoirs: 50 feet
R. All other surface water bodies, such as brooks, creeks, streams, rivers, sounds, bays, and tidal estuaries: 25 feet
S. Chemical or petroleum fuel underground storage tank systems regulated under 15A NCAC 02N: (i) with secondary containment: 50 feet (ii) without secondary containment: 100 feet
T. Above ground or underground storage tanks that contain petroleum fuels used for heating equipment, boilers, or furnaces, with the exception of tanks used solely for storage of propane, natural gas, or liquefied petroleum gas: 50 feet
U. All other petroleum or chemical storage tank systems: 100 feet
V. Gravesites: 50 feet
W. Coal ash landfills or impoundments: 200 feet
X. All other potential sources of groundwater contamination 50 feet

(3) For a water supply well as defined in G.S. 87-85(13) on a lot serving a single-family dwelling and intended for domestic use, where lot size or other fixed conditions preclude the separation distances specified in Subparagraph (a)(2) of this Rule, the required horizontal separation distances shall be the maximum possible but shall in no case be less than the following:

(A) Industrial or municipal sewage or liquid-waste collection or sewer main, constructed to water main standards as stated in the AWWA Standards C600 and/or C900: 25 feet

(B) Animal barns: 50 feet



Brunswick County Environmental Health Services

BCHS File Number: 2000055922A1

Onsite Wastewater

Tax Parcel: 173BN012

- Proposal
- Improvement Permit
- Construction Authorization
- Operation Permit
- Well Permit
- Well Abandonment Permit
- Existing System Approval
- Other: _____

SITE PLAN ONLY. THIS IS NOT A PERMIT

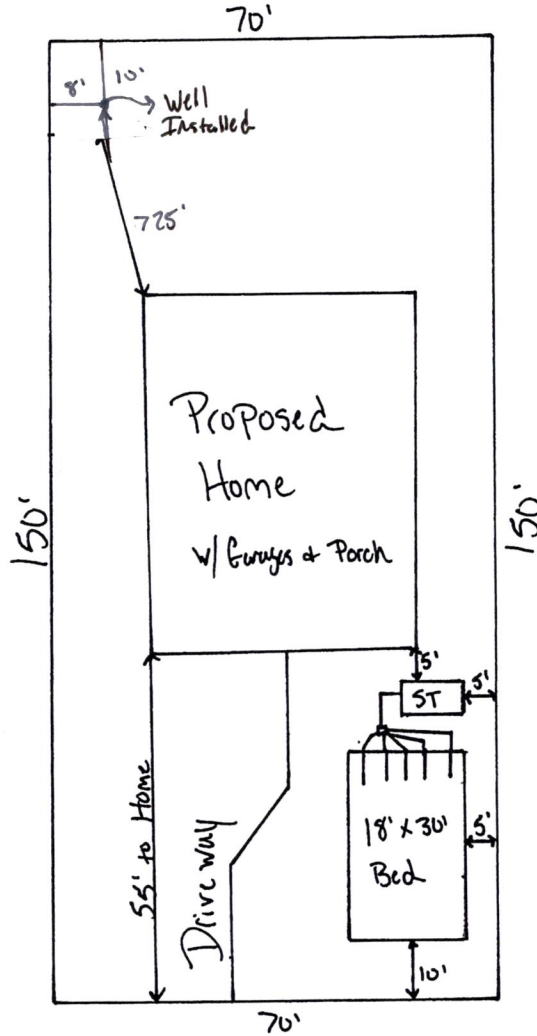

— — — — — Jefferson Rd. — — — — —

Onsite Wastewater System Design Criteria

Type of Initial Wastewater System: <u>2-A</u>	Number of Occupants/Employees (Max): <u>6</u>
Number of Bedrooms (Max.): <u>3</u>	LTAR of Initial Wastewater System (gpd/ft ²): <u>1.0</u>
Design Flow (GPD): <u>360</u>	Length of Lines (Feet): <u>30'</u>
Number of Lines: <u>6</u>	Width of Lines (Feet): <u>3'</u>
Trench Bottom Depth From Top of Final Cover (Max. Inches): <u>24</u>	Drainfield Square Feet: <u>540</u>
Min. Size of Septic Tank (Gal.): <u>1000</u>	Bed Dimensions (Feet x Feet): _____
Min. Size of Pump Tank (Gal.): _____	Type of Repair System: <u>Exempt</u>
Min. Size of Grease Trap (Gal.): _____	Repair System Trench Bottom Depth (Max. Inches): _____
Other Information: _____	LTAR of Repair System (gpd/ft ²): _____

 DUSTIN S.
 REHS Signature

12/31/2025
 Date