

Building Sketch

Borrower	Sketch - Tessa Denton					
Property Address	106 E New Hope Rd					
City	Goldsboro	County	State	NC	Zip Code	27534
Lender/Client	Sketch - Tessa Denton					

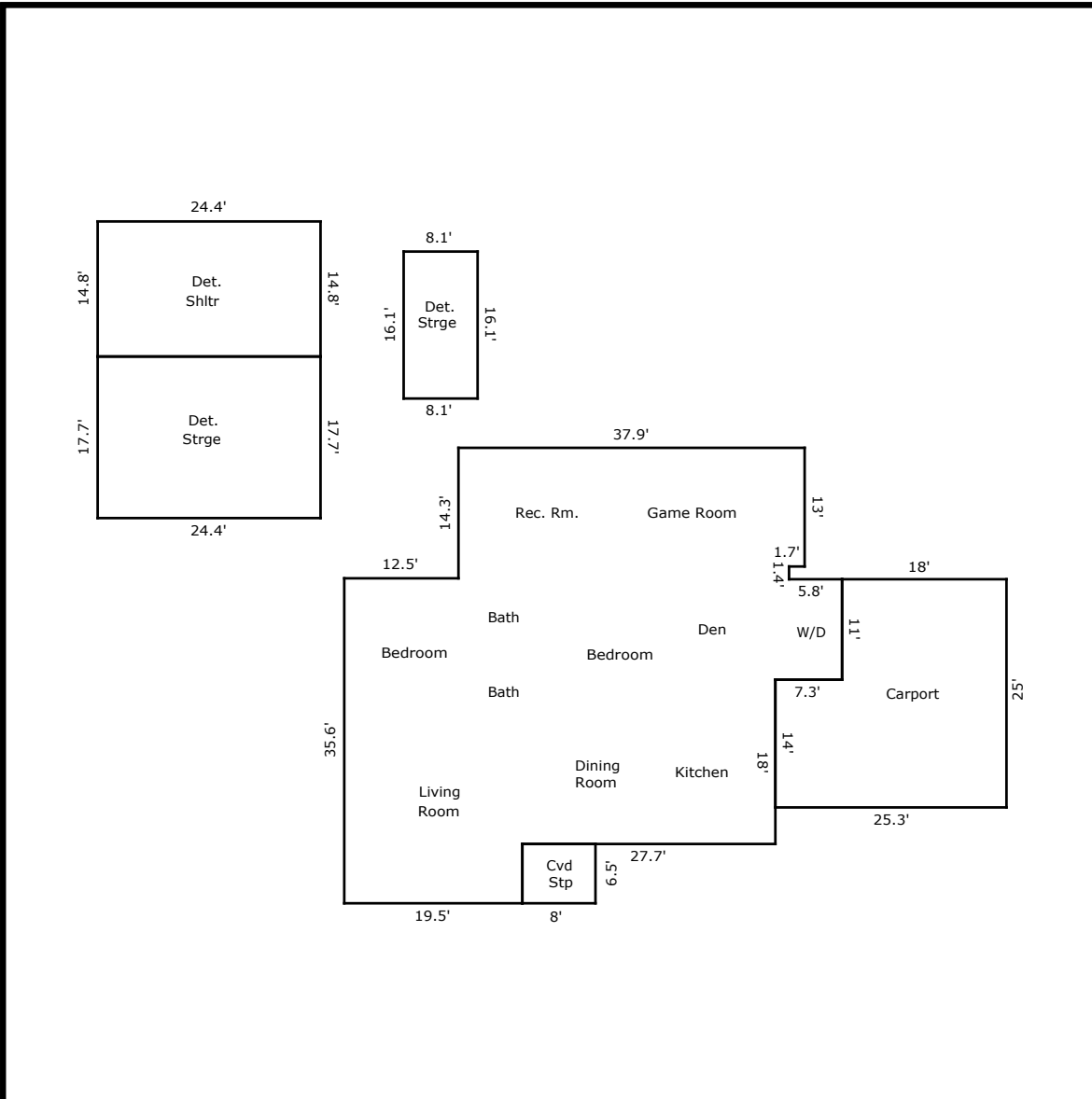

TOTAL Sketch by a la mode		Area Calculations Summary	
Living Area		Calculation Details	
First Floor	2120.48 Sq ft	$11 \times 5.8 =$	63.8
		$35.6 \times 12.5 =$	445
		$7 \times 6.5 =$	45.5
		$43.4 \times 34.7 =$	1505.98
		$3.2 \times 13 =$	41.6
		$12.4 \times 1.5 =$	18.6
Total Living Area (Rounded):		2120 Sq ft	
Non-living Area			
Carport	552.2 Sq ft	$25 \times 18 =$	450
		$14 \times 7.3 =$	102.2
Det Strge	431.88 Sq ft	$17.7 \times 24.4 =$	431.88
Cvd Stp	52 Sq ft	$6.5 \times 8 =$	52
Det Shltr	361.12 Sq ft	$14.8 \times 24.4 =$	361.12
Det Strge	130.41 Sq ft	$16.1 \times 8.1 =$	130.41