

INVOICE

FROM:

House Appraisals (252) 943-1231
 House Appraisals (252) 943-1231
 1089 US Hwy 64
 Robersonville, NC 27871

Telephone Number: (252) 943-1231 Fax Number: (252) 946-1101

TO:

Beth Wilder

E-Mail: bethwildersellshomes@gmail.com

Telephone Number: 252-531-7564 Fax Number:
 Alternate Number:

INVOICE NUMBER

402 Lawson.09.25

DATES

Invoice Date: 09/05/2025
 Due Date: Upon Receipt

REFERENCE

Internal Order #:
 Lender Case #:
 Client File #:
 FHA/VA Case #:
 Main File # on form:
 Other File # on form:
 Federal Tax ID:
 Employer ID:

DESCRIPTION

Lender:	Client:
Purchaser/Borrower:	
Property Address: 402 Lawson Rd	
City: Washington	
County:	State: NC Zip: 27889
Legal Description:	

FEES

AMOUNT

Measurement services	125.00
SUBTOTAL	
	125.00

PAYMENTS

AMOUNT

Check #:	Date:	Description:	
Check #:	Date:	Description:	
Check #:	Date:	Description:	
SUBTOTAL			
TOTAL DUE			\$ 125.00

Building Sketch

Borrower				
Property Address 402 Lawson Rd				
City	Washington	County	State	NC Zip Code 27889
Lender/Client				

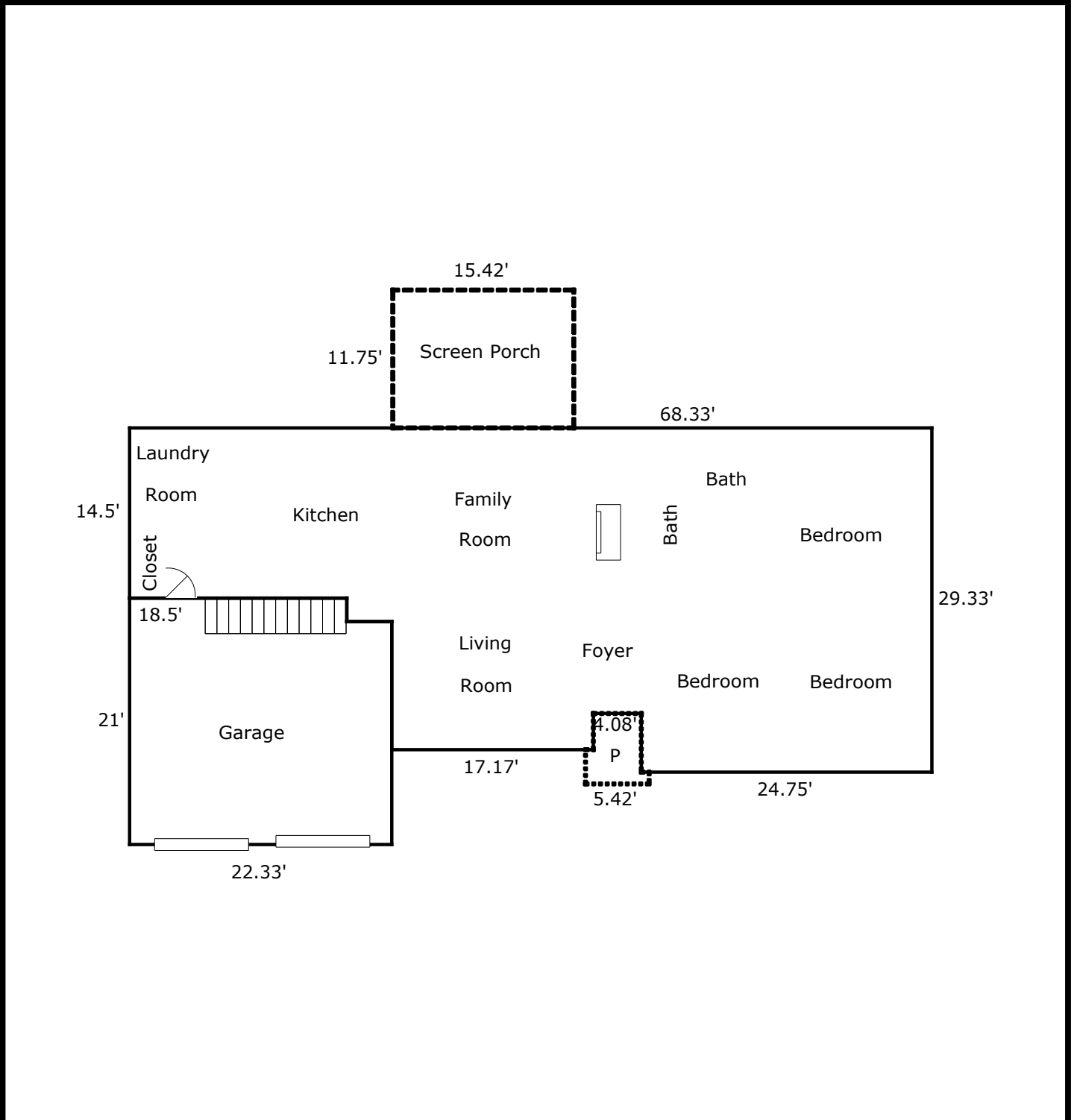

TOTAL Sketch by a la mode

Area Calculations Summary

Living Area	Calculation Details	
First Floor	1627.51 Sq ft	$29.33 \times 24.75 = 726$ $14.5 \times 18.5 = 268.25$ $25.08 \times 16.5 = 413.87$ $10.92 \times 17.17 = 187.4$ $7.83 \times 4.08 = 31.99$
Garage	461.33 Sq ft	$21 \times 18.5 = 388.5$ $3.83 \times 19 = 72.83$
Total Living Area (Rounded):	2089 Sq ft	
Non-living Area		
Screen Porch	181.15 Sq ft	$15.42 \times 11.75 = 181.15$
Open Porch	27.11 Sq ft	$4.08 \times 3.08 = 12.59$ $1 \times 0.67 = 0.67$ $4.75 \times 2.92 = 13.85$



Supplemental Addendum

File No.

Borrower				
Property Address 402 Lawson Rd				
City	Washington	County	State	NC Zip Code 27889
Lender/Client				

Measurements for 402 Lawson Rd

- Foyer 10'2" X 4'5"
- Living Room 17'2" X 12'4"
- Family Room 14'11" X 17'2"
- Kitchen 13' X 12'6"
- Bedroom 11'5" X 16'3"
- Bedroom 10' X 10'11"
- Bedroom 12'5" X 11'6"
- Laundry Room 8'2" X 7'11" (irregular)
- Garage 19' X 20'9"
- Walk up attic accessed from the garage

esign.alamode.com/verify Serial:3AE65CB7

Signature *Cora Credle House*
 Name _____
 Date Signed 09/05/2025
 State Certification # A6851 State NC
 Or State License # _____ State _____



Signature _____
 Name _____
 Date Signed _____
 State Certification # _____ State _____
 Or State License # _____ State _____

