

215 Harris Road _ Smithfield, NC 27577

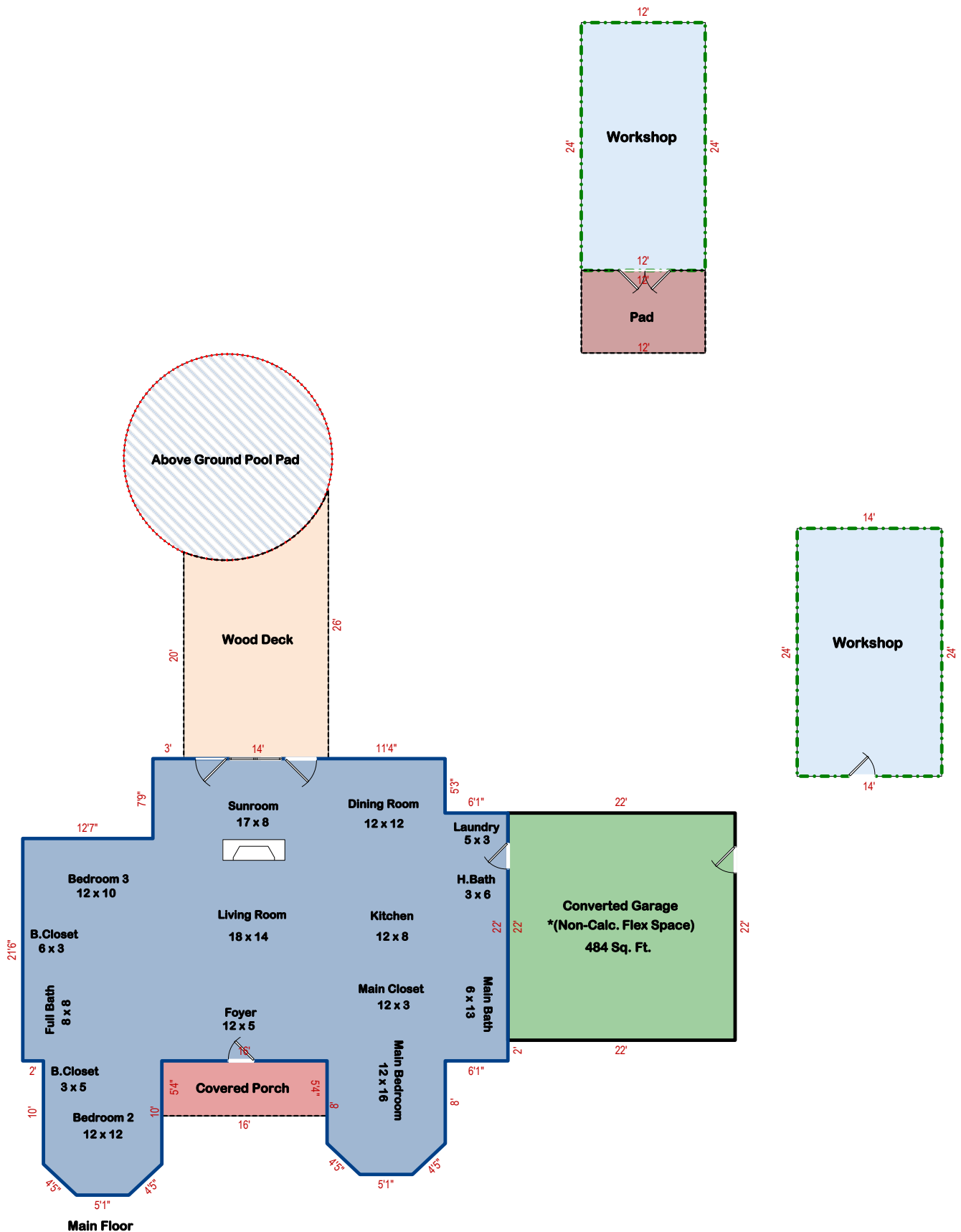

***Approximate Total Livable Sq.Ft. = 1500.7 Sq. Ft.**

**(Approximate Total Structure Sq.Ft. w/Converted Garage = 1984.7 Sq.Ft.)*

****Some Measurements and Dimensions appear rounded/This diagram is not to an exact scale.**

****Approximate Assessed Sq.Ft. can vary between other sources; this assessment rendering does not determine any appraised values.**