

Flehsig, Bradley D.

LRK 98000484  
4 Bedroom septic system

**MOORE COUNTY HEALTH DEPARTMENT  
ENVIRONMENTAL HEALTH SECTION  
OPERATION PERMIT**

Owner: Creations in the Sandhills / Blue Farm Address: Lot 347 / 150 Rothbury Dr.  
 Permit # \_\_\_\_\_ Receipt # 18181-A P.I.N. # 858413144139  
 Installer: Roger Jackson / Sandhills Septic Service Telephone: 947-2855  
 Address: 423 Hardy Road, Carthage  
 System Type: II Conventional Maximum Design Flow: 480 (gallons/day)  
 Wastewater Characteristics: Residential  
 Septic Tank Capacity: 1000 (Gallons) Tank I.D. # STB-939  
 Nitrification Line Dimensions: 4 (67'x3')  
 Effluent Distribution Device: D-Box Gravel Depth: 12"  
 Depth To: Top of Tanks: 4-6 (Inches) Trench Bottom 24" (Inches)

Diagram of Actual Installation: (Depict Property Boundaries, Structures, Driveways, Trees, Water Lines, Water Supplies, Etc.)

Scale: \_\_\_\_\_ Inch = \_\_\_\_\_ Feet.

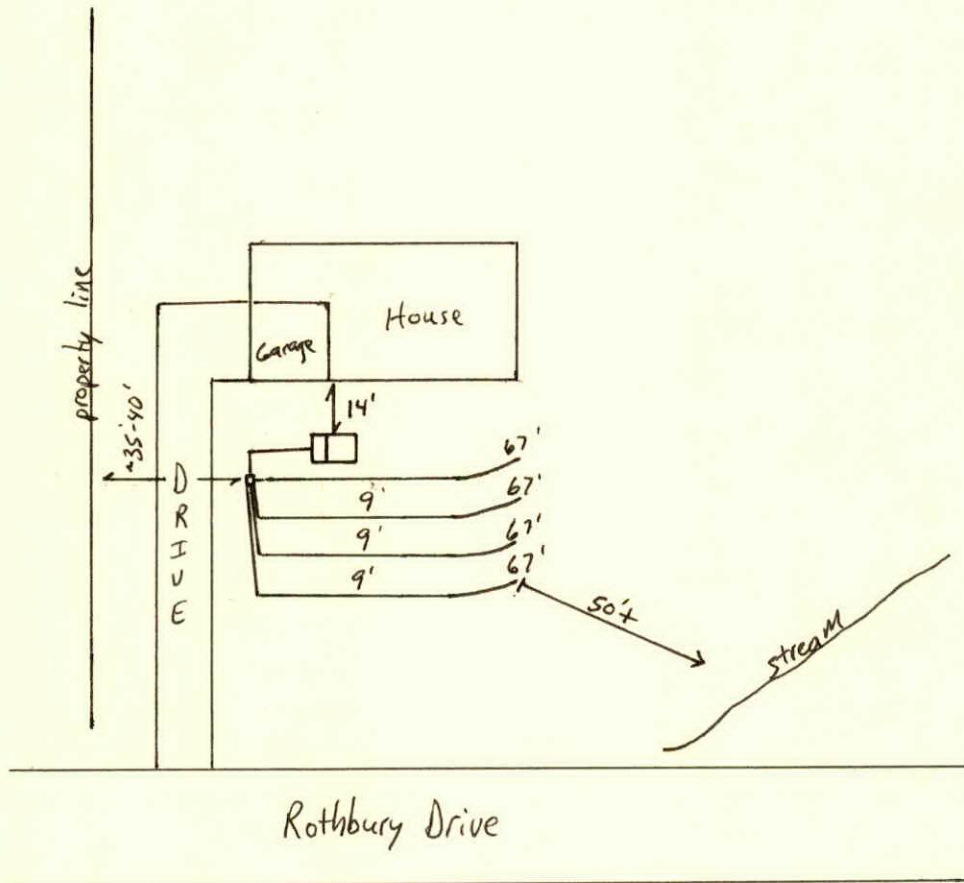

Comments and Conditions: \_\_\_\_\_

Issued By: James Teachey, R.S. # of Attachments: \_\_\_\_\_  
 Date: 10/10/2000

FINAL APPROVAL OF THIS SYSTEM SHALL INDICATE THAT THE SYSTEM HAS BEEN INSTALLED IN ACCORDANCE WITH APPLICABLE PERMIT CONDITIONS, LAWS AND RULES, BUT IN NO WAY SHOULD BE TAKEN AS A GUARANTEE THAT THE SYSTEM WILL FUNCTION SATISFACTORILY FOR ANY GIVEN TIME.