

Application # 120375

Parcel # \_\_\_\_\_

Name: Brittany Landry Address: 2031 Devils Racetrack Rd. Four Oaks, NC 27524

Location: Down 301 to 701, T/L on Devils Racetrack Rd., Property 2 miles down on the left.

Subdivision: N/A Lot #: N/A Lot Area: 5 Acre(s) Water Source: Public

Facility Type: 3 Bedroom SFD Daily Flow For Design: 120 gallons/bedroom DDSF: 360 gallons/day

Service Type: New Construction Soil Site Classification: Provisionally Suitable LTAR: 0.35 gallons/day/ft<sup>2</sup>

Septic Tank: 1000 gallons Grease Trap: N/A gallons Pump Tank: N/A gallons

Trench Type: GTR Trench Area: 1028 ft<sup>2</sup> # of Lines: 4

Width: 3 feet Length: 90 feet Depth: 12 Max inches

Pump Size: 6 ft TDH @ 21 gallons/minute Pressure Head: N/A Drawdown: 8 inches

Design/Layout by: N/A Improvement Permit: Matthew Gilley Date: 3-10-16 Exp. Date: 3-10-21

Inspection: Lines: 4x90 Ez-flow MTC 8-9-16 Septic Tank: 1000 GTR MTC MTC 8-9-16 D-Box: MTC 8-9-16

Pump Tank: N/A Pump(s) Pressure: N/A Alarm: N/A

Grease Trap: N/A Drainage: MTC Contractor: John Dietrich

**AUTHORIZATION FOR WASTEWATER SYSTEM CONSTRUCTION**

ISSUED BY: Matthew Gilley Matthew Gilley DATE ISSUED: Mar. 10, 2016

By rule, this septic system requires the use of an effluent filter and a waterproof seal. A riser and septic marker may also be required. Systems shall be installed as shown in sketch and/or according to attached plans and specifications. Any unauthorized site disturbance, filling, soil removal, or layout changes may result in the permit being revoked. Improvement permit is valid for 5 years from the date of issuance unless otherwise indicated. The owner/agent accepts & verifies the conditions of the permit as indicated below. Maintenance is required to ensure proper operation.

OWNER/AGENT: \_\_\_\_\_ DATE: \_\_\_\_\_

- \* Lightly grade field rows.
- \* 6" of cover must be brought in before installing septic.
- \* If gravity can be achieved then a pump will not be required
- \* 12"-18" swell shall be around septic lines to divert surface water
- \* If gravity is able to be achieved, the tank shall be above grade w/6" of cover

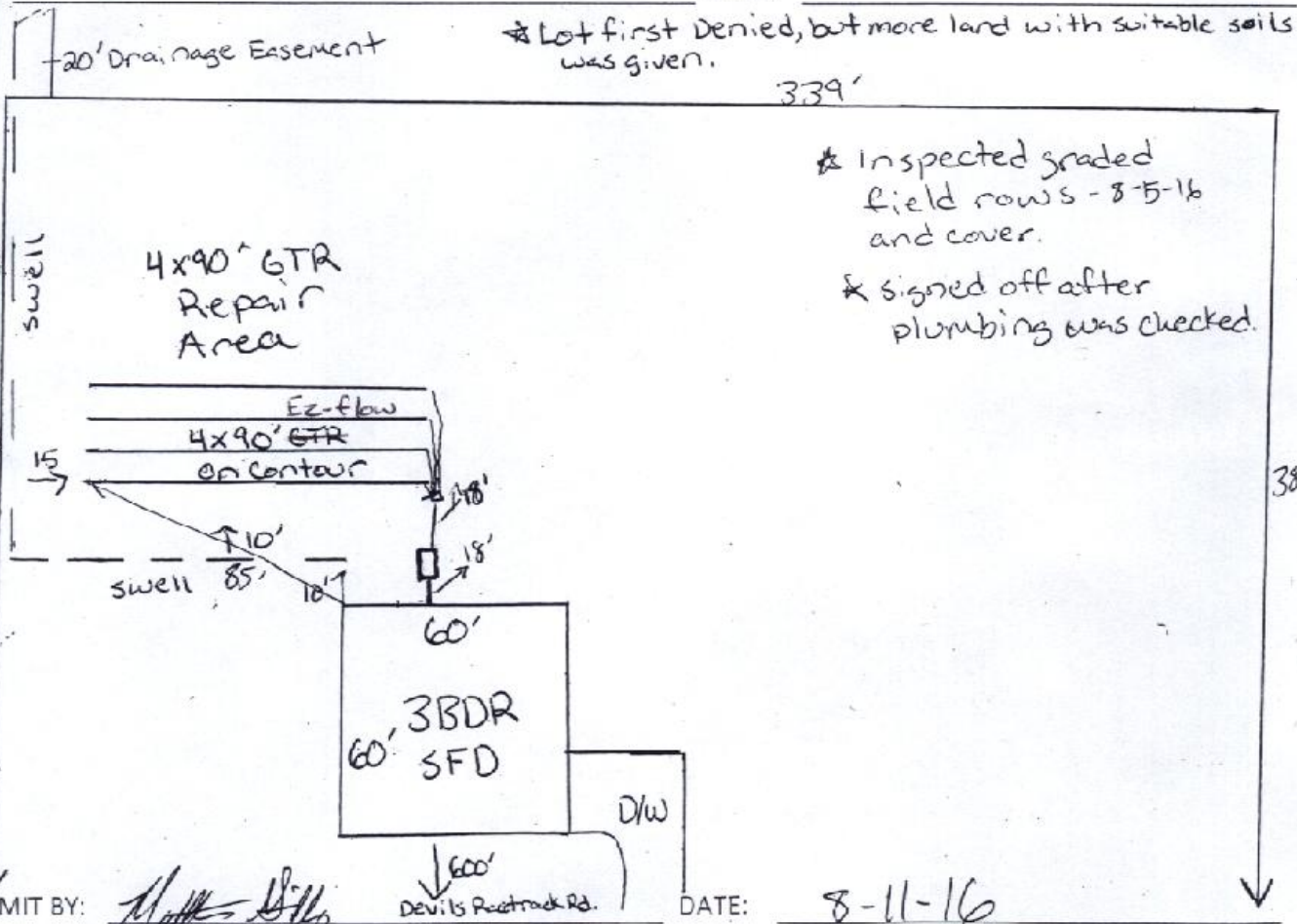

OPERATION PERMIT BY: Matthew Gilley DATE: 8-11-16