

Building Sketch

Borrower	na						
Property Address	1706 Wrightsville Ave						
City	Wilmington	County	New Hanover	State	NC	Zip Code	28403
Lender/Client	na						

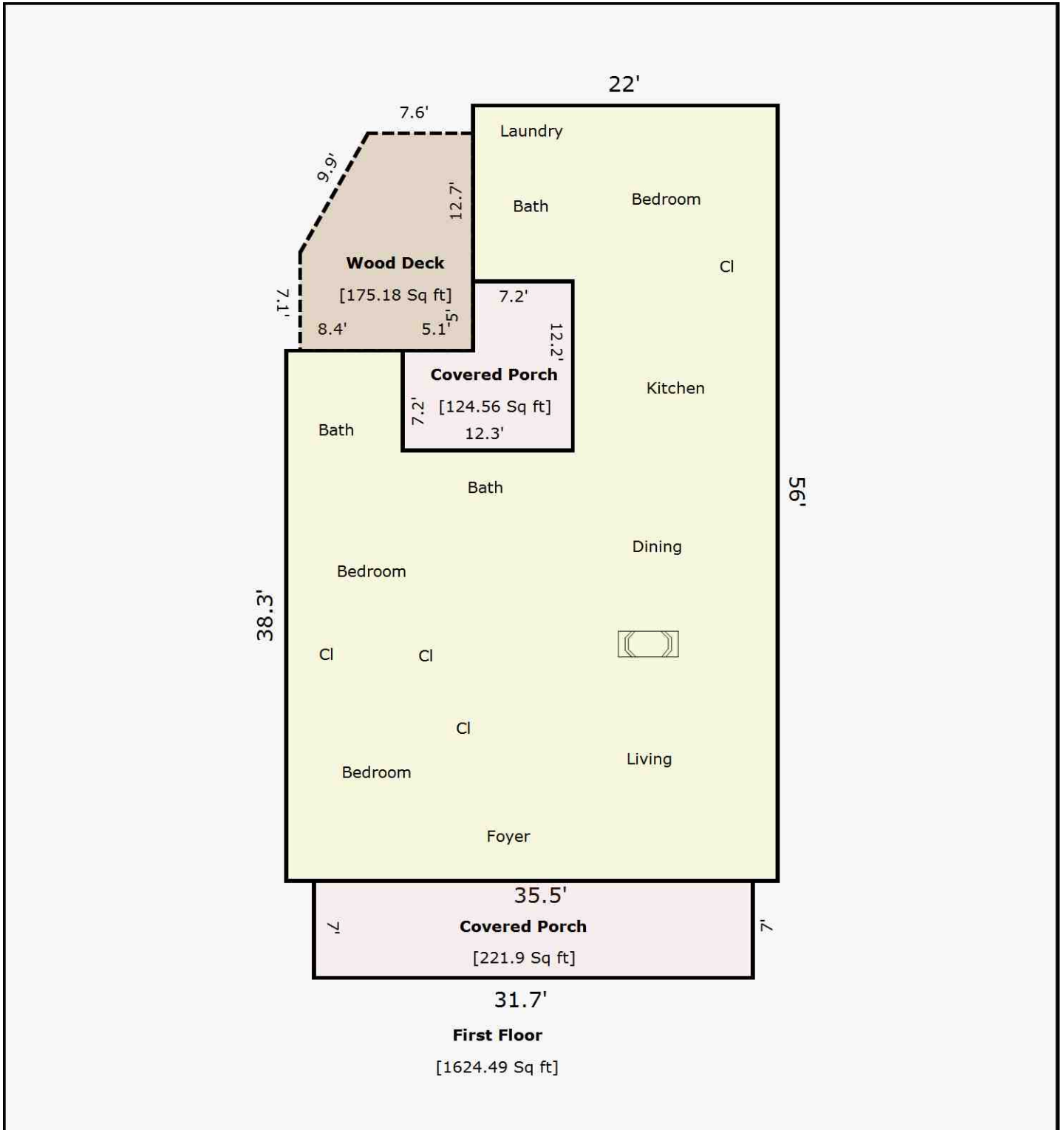

TOTAL Sketch by a la mode

Area Calculations Summary

Living Area	Calculation Details		
First Floor	1624.49 Sq ft	35.5×31.1	= 1104.05
		14.8×12.2	= 180.56
		22×12.7	= 279.4
		7.2×8.4	= 60.48
Total Living Area (Rounded):	1624 Sq ft		
Non-living Area			
Wood Deck	175.18 Sq ft	12.5×7.1	= 88.75
		8.6×7.6	= 65.36
		$0.5 \times 8.6 \times 4.9$	= 21.07
Covered Porch	124.56 Sq ft	7.2×5.1	= 36.72
		12.2×7.2	= 87.84
Covered Porch	221.9 Sq ft	31.7×7	= 221.9