

BRUNSWICK COUNTY HEALTH DEPARTMENT

FILE NO.: 2005065144  
ZONING: 2005052860

DATE REC.: 3/16/2005

P.I.N.:

EVANS OTTRUE

240.00

198CA049

REC. FROM

AMT. PD.

TAX PARCEL

553 WESLEY TRAIL SW

SUPPLY

NC

28462-

(910) 754-6381

ADDRESS

CITY

ST

ZIP

PHONE

SANDBRO INVESTMENTS

SHERROW RIVER ESTATE

49

CURRENT PROPERTY OWNER

SUBDIVISION

LOT

BLK

SEC

PROPERTY LOCATED, TOWN/CITY/AREA/ BRUNSWICK COUNTY

DIRECTIONS TO PROPERTY TURN R AT SHERROW RIVER ON ASH DR- LOT ON CORNER OF ASH/SHERROW RIVER

AUTHORIZATION FOR WASTEWATER CONSTRUCTION PERMIT

NEW  REVISION  RELOCATION  UPGRADE  REPAIR

Design Flow: 360 gpd. Septic Tank Size: 900 gal. Type: 2c

No. Bedrooms: 3 No. occupants/employees: 6 Max. Trench/Bed Bottom Depth: 18 inches

No. Lines: 3 Length Each: 67 Bed Dimensions: N/A

Fill Check: N/A Approved: N/A

Date

Authorized Agent

PERMIT ISSUE DATE: 4/14/05 Permit expires 60 months from date of issue unless otherwise specified

30 days from date of issue  Other

Authorized Agent Jay H. Edwards RS Registration: #1355

NOTES: PERMIT IS SUBJECT TO REVOCATION IF SITE PLANS OR THE INTENDED USE CHANGES.  
IMPROVEMENT PERMIT CONDITIONS MUST BE MET.

- NOTES:
1. Septic Tank shall have an approved effluent filter and access devices as applicable.
  2. Maintain all setback distances for septic tank systems and wells.
  3. All components of the septic systems shall be located 100 feet if possible but not less than 50 feet to all existing and future wells on this parcel and adjacent parcels.

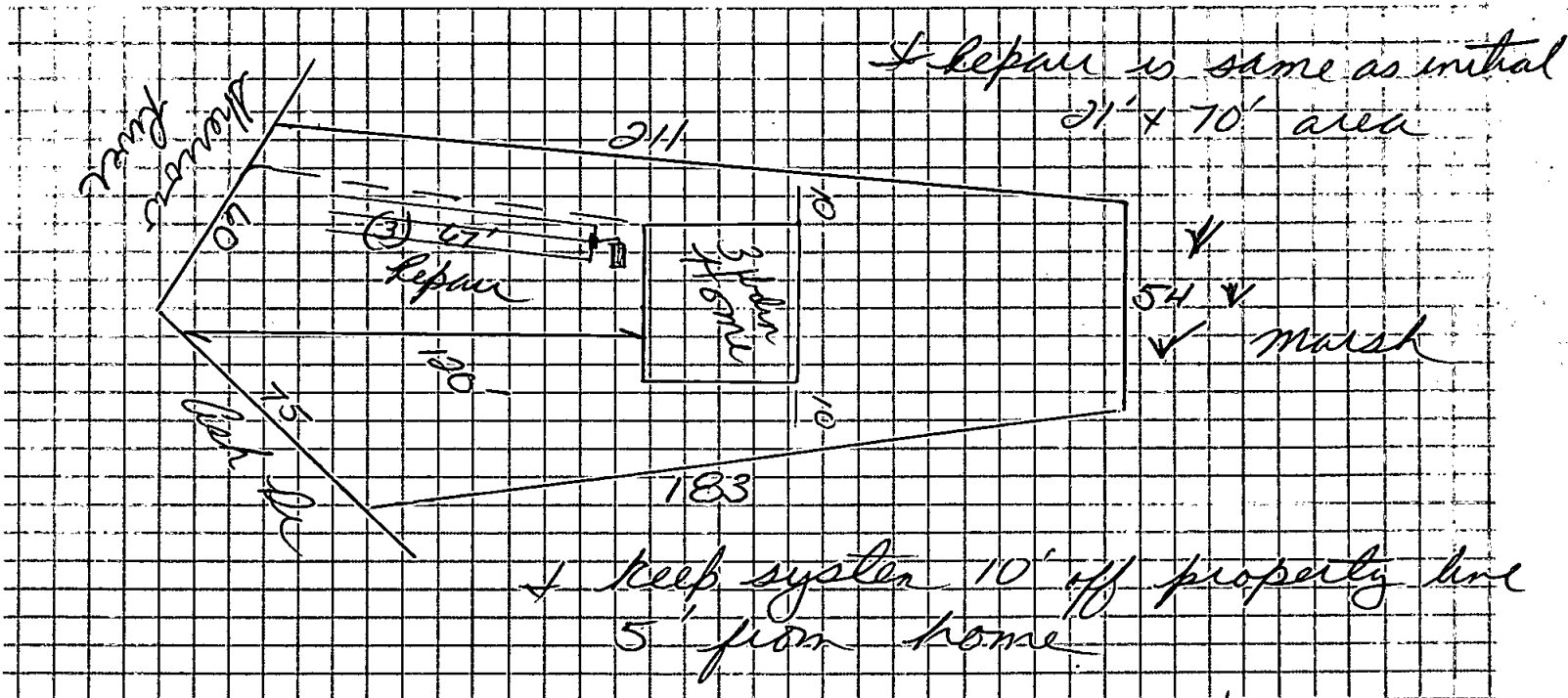

Wastewater System Installer: Norvin Grissett Date: 4/20/06

Comments: (tank info/barrier approved) SB - 1000 STB - 833 3/16/06

OPERATION PERMIT: Norvin Hewett Date: 4/20/06

Authorized Agent Signature

Actions of local health department representatives or the State engaged in the evaluation and determination of measures required to effect compliance with the applicable laws and rules shall in no way be taken as a warranty that sewage treatment and disposal systems approved and permitted will function in a satisfactory manner for any given period of time. The issuance of this permit does not preclude the Permittee from complying with any and all statutes, rules and regulations or ordinances which may be imposed by other government agencies (local, state, and federal) which have jurisdiction.