

Blakely, Donald B & Dana Kaye

LRK 97000956
290 Thomas Place
Lot 2
3 BR System

MOORE COUNTY HEALTH DEPARTMENT ENVIRONMENTAL HEALTH SECTION OPERATION PERMIT

Permit # _____ Receipt # 15290 P.I.N. # 854S00159748
 Installer: Don Gaddy Telephone: 245 3066
 Address: (Cameron) WC
 System Type: pump to PS Ag Maximum Design Flow: 360 (gallons/day)
 Wastewater Characteristics: domestic
 Septic Tank Capacity: 1000 (Gallons) Tank I.D. # STB 103
 Nitrification Line Dimensions: 4 @ 75 X 3
 Effluent Distribution Device: ↓ box Gravel Depth: 12"
 Depth To: _____ Top of Tanks: 6" (Inches) Trench Bottom 14" (Inches)

Diagram of Actual Installation: (Depict Property Boundaries, Structures, Driveways, Trees, Water Lines, Water Supplies, Etc.)

Scale: _____ Inch = _____ Feet.

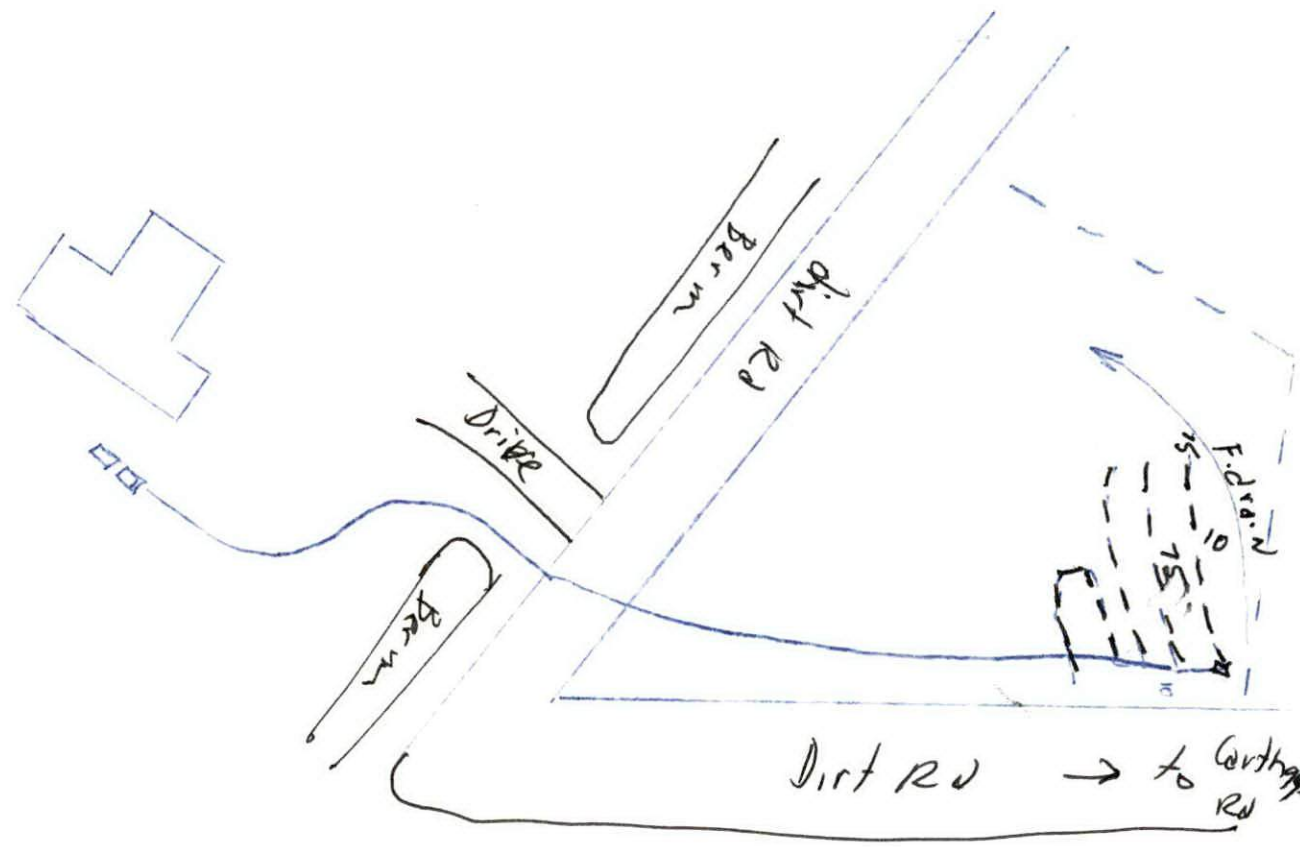

Comments and Conditions: _____

Issued By: Chark D. R. [Signature] # of Attachments: _____
 Date: 6/17/99

FINAL APPROVAL OF THIS SYSTEM SHALL INDICATE THAT THE SYSTEM HAS BEEN INSTALLED IN ACCORDANCE WITH APPLICABLE PERMIT CONDITIONS, LAWS AND RULES, BUT IN NO WAY SHOULD BE TAKEN AS A GUARANTEE THAT THE SYSTEM WILL FUNCTION SATISFACTORILY FOR ANY GIVEN TIME.