

DEPARTMENT OF HOMELAND SECURITY
Federal Emergency Management Agency
ELEVATION CERTIFICATE

OMB Control Number: 1660-0008
Expiration: 11/30/2018

IMPORTANT: FOLLOW THE INSTRUCTIONS ON PAGES 9-16

Copy all pages of this Elevation Certificate and all attachments for (1) community official, (2) insurance agent/company, and (3) building owner.

SECTION A - PROPERTY INFORMATION		FORM INSURANCE COMPANY USE	
A1. Building Owner's Name Barbara Ann Renchen		Policy Number:	
A2. Building Street Address (including Apt., Unit, Suite, and/or Bldg. No.) or P.O. Route and Box No. 201 Cypress Branch Way		Company NAIC Number:	
City Jacksonville	State NC	Zip Code 28546	
A3. Property Description (Lot and Block Numbers, Tax Parcel Number, Legal Description, etc.) Lots 21 & 22 Recombined per MB 70 Pg 155			
A4. Building Use (e.g., Residential, Non-Residential, Addition, Accessory, etc.) Residential			
A5. Latitude/Longitude: Lat. <u>34-50-47.19"</u> Long. <u>-77-30-45.12"</u> Horizontal Datum: <input type="radio"/> NAD 1927 <input checked="" type="radio"/> NAD 1983			
A6. Attach at least 2 photographs of the building if the Certificate is being used to obtain flood insurance.			
A7. Building Diagram Number <u>8</u>			
A8. For a building with a crawlspace or enclosure(s):		A9. For a building with an attached garage:	
a) Square footage of crawlspace or enclosure(s) <u>1887</u> sq ft	b) Number of permanent flood openings in the crawlspace or enclosure(s) within 1.0 foot above adjacent grade <u>9</u>	a) Square footage of attached garage <u>620</u> sq ft	b) Number of permanent flood openings in the attached garage within 1.0 foot above adjacent grade <u>0</u>
c) Total net area of flood openings in A8.b <u>1980</u> sq in	d) Engineered flood openings? <input checked="" type="radio"/> Yes <input type="radio"/> No	c) Total net area of flood openings in A9.b <u>0</u> sq in	d) Engineered flood openings? <input type="radio"/> Yes <input checked="" type="radio"/> No
SECTION B - FLOOD INSURANCE RATE MAP (FIRM) INFORMATION			
B1. NFIP Community Name & Community Number 370340 Onslow County		B2. County Name Onslow County	B3. State NC
B4. Map/Panel Number 3720444000	B5. Suffix J	B6. FIRM Index Date Feb 16, 2007	B7. FIRM Panel Effective/ Revised Date 11/3/2005
		B8. Flood Zone(s) "AE"	B9. Base Flood Elevation(s) (Zone AO, use base flood depth) 18.5'
B10. Indicate the source of the Base Flood Elevation (BFE) data or base flood depth entered in Item B9: <input type="radio"/> FIS Profile <input type="radio"/> FIRM <input type="radio"/> Community Determined <input checked="" type="radio"/> Other/Source: <u>Flood Risk Information System</u>			
B11. Indicate elevation datum used for BFE in Item B9: <input type="radio"/> NGVD 1929 <input checked="" type="radio"/> NAVD 1988 <input type="radio"/> Other/Source: _____			
B12. Is the building located in a Coastal Barrier Resources System (CBRS) area or Otherwise Protected Area (OPA)? <input type="radio"/> Yes <input checked="" type="radio"/> No Designation Date: n/a <input type="radio"/> CBRS <input type="radio"/> OPA			
SECTION C - BUILDING ELEVATION INFORMATION (SURVEY REQUIRED)			
C1. Building elevations are based on: <input type="radio"/> Construction Drawings* <input type="radio"/> Building Under Construction* <input checked="" type="radio"/> Finished Construction			
C2. Elevations - Zones A1 - A30, AE, AH, A (with BFE), VE, V1 - V30, V (with BFE), AR, AR/A, AR/AE, AR/A1 - A30, AR/AH, AR/AO. Complete Items C2.a - h below according to the building diagram specified in Item A7. In Puerto Rico only, enter meters. * A new Elevation Certificate will be required when construction of the building is complete.			
Benchmark Utilized: <u>NCGS "McGowan"</u> Vertical Datum: <u>NAVD 88</u>			
Indicate elevation datum used for the elevations in items a) through h) below. <input type="radio"/> NGVD 1929 <input checked="" type="radio"/> NAVD 1988 <input type="radio"/> Other/Source: _____			
Datum used for building elevations must be the same as that used for the BFE.			Check the measurement used.
a) Top of bottom floor (including basement, crawlspace, or enclosure floor)	<u>19</u> - <u>8</u>	<input checked="" type="radio"/> feet	<input type="radio"/> meters
b) Top of the next higher floor	<u>22</u> - <u>40</u>	<input checked="" type="radio"/> feet	<input type="radio"/> meters
c) Bottom of the lowest horizontal structural member (V Zones only)	<u>n/a</u> - _____	<input type="radio"/> feet	<input type="radio"/> meters
d) Attached garage (top of slab)	<u>20</u> - <u>59</u>	<input checked="" type="radio"/> feet	<input type="radio"/> meters
e) Lowest elevation of machinery or equipment servicing the building (Describe type of equipment and location in Comments)	<u>20</u> - <u>51</u>	<input checked="" type="radio"/> feet	<input type="radio"/> meters
f) Lowest adjacent (finished) grade next to building (LAG)	<u>18</u> - <u>7</u>	<input checked="" type="radio"/> feet	<input type="radio"/> meters
g) Highest adjacent (finished) grade next to building (HAG)	<u>19</u> - <u>7</u>	<input checked="" type="radio"/> feet	<input type="radio"/> meters
h) Lowest adjacent grade at lowest elevation of deck or stairs, including structural support	<u>19</u> - <u>2</u>	<input checked="" type="radio"/> feet	<input type="radio"/> meters

ELEVATION CERTIFICATE

OMB Control Number: 1660-0008
Expiration: 11/30/2018

201 Cypress Branch Way

Jacksonville

NC

28546

SECTION D - SURVEYOR, ENGINEER, OR ARCHITECT CERTIFICATION

This certification is to be signed and sealed by a land surveyor, engineer, or architect authorized by law to certify elevation information. I certify that the information on this Certificate represents my best efforts to interpret the data available. I understand that any false statement may be punishable by fine or imprisonment under 18 U.S. Code, Section 1001.

Were latitude and longitude in Section A provided by a licensed land surveyor?
 Check here if attachments. Yes No

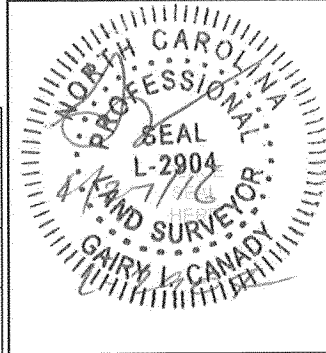

Certifier's Name Gairy I. Canady PLS		License Number L-2904	
Title NC Professional Land Surveyor	Company Name Gairy Canady Surveying		
Address PO Box 915	City Richlands	State NC	Zip Code 28574
Signature 	Date Apr 27, 2016	Telephone +1 (910) 324-4616	

Copy both sides of this Elevation Certificate for (1) community official, (2) insurance agent/company, and (3) building owner.

Comments (including type of equipment and location, per C2(e), if applicable)"
 Item C2e is the bottom of the HVAC Unit.
 Revised 4/21/16-changed address.
 Revised 4/27/16 Items A4, B11,C2a

Signature Date Apr 27, 2016

SECTION E - BUILDING ELEVATION INFORMATION (SURVEY NOT REQUIRED) FOR ZONE AO AND ZONE A (WITHOUT BFE)

For Zones AO and A (without BFE), complete Items E1 -E5. If the Certificate is intended to support a LOMA or LOMR-F request, complete Sections A, B, and C. For Items E1 -E4, use natural grade, if available. Check the measurement used. In Puerto Rico only, enter meters.

- E1. Provide elevation information for the following and check the appropriate boxes to show whether the elevation is above or below the highest adjacent grade (HAG) and the lowest adjacent grade (LAG).
- a) Top of bottom floor (including basement, crawlspace, or enclosure) is _____ - _____ feet meters above or below the HAG.
- b) Top of bottom floor (including basement, crawlspace, or enclosure) is _____ - _____ feet meters above or below the LAG.
- E2. For Building Diagrams 6 -9 with permanent flood openings provided in Section A Items 8 and/or 9 (see pages 8 -9 of Instructions), the next higher floor (elevation C2.b in the diagrams) of the building is _____ - _____ feet meters above or below the HAG.
- E3. Attached garage (top of slab) is _____ - _____ feet meters above or below the HAG.
- E4. Top of platform of machinery and /or equipment servicing the building is _____ - _____ feet meters above or below the HAG.
- E5. Zone AO only: If no flood depth number is available, is the top of the bottom floor elevated in accordance with the community's floodplain management ordinance? Yes No Unknown. The local official must certify this information in Section G.

SECTION F - PROPERTY OWNER (OR OWNER'S REPRESENTATIVE) CERTIFICATION

The property owner or owner's authorized representative who completes Sections A, B, and E for Zone A (without a FEMA-issued or community-issued BFE) or Zone AO must sign here. The statements in Sections A, B, and E are correct to the best of my knowledge.

Property Owner or Owner's Authorized Representative's Name: _____

Address	City	State	ZIP Code
Signature	Date	Telephone	

Comments

Check here if attachments.

Building Photographs

See Instructions for Item A6.

IMPORTANT: In these spaces, copy the corresponding information from Section A.

Building Street Address (including Apt., Unit, Suite, and/or Bldg. No.) or P.O. Route and Box No.
201 Cypress Branch Way

City Jacksonville

State NC

ZIP Code 28546

FOR INSURANCE COMPANY USE

Policy Number:

Company NAIC Number:

If using the Elevation Certificate to obtain NFIP flood insurance, affix at least 2 building photographs below according to the instructions for Item A6. Identify all photographs with date taken; "Front View" and "Rear View"; and, if required, "Right Side View" and "Left Side View." When applicable, photographs must show the foundation with representative examples of the flood openings or vents, as indicated in Section A8. If submitting more photographs than will fit on this page, use the Continuation Page.

Front View 4/12/16



Rear View 4/12/16

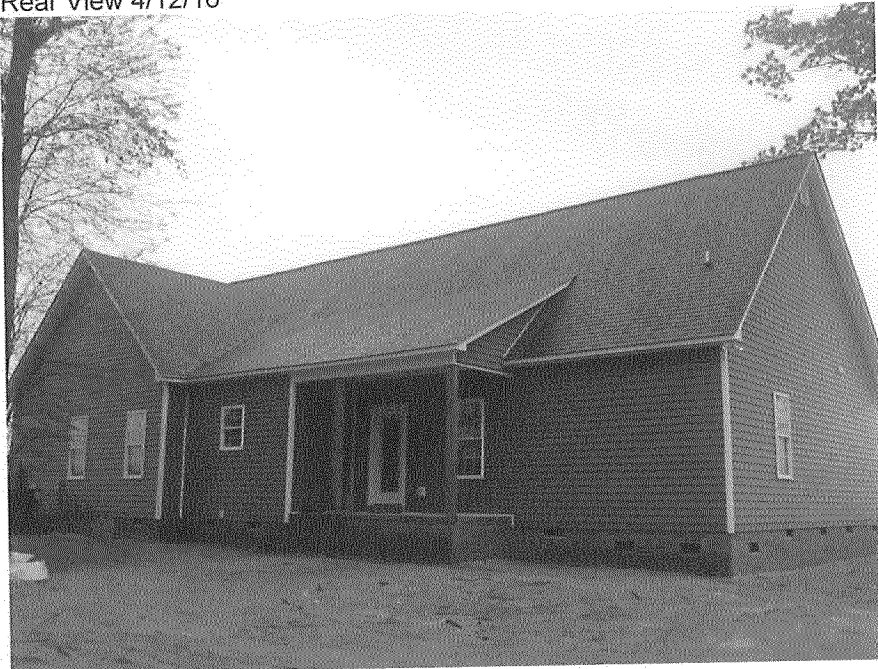

Vent View 4/12/16

