



Moore County Health Department

Environmental Health Section
 PO Box 279, Carthage, NC 28327
 Phone: 910-947-6283 Fax: 910-947-5127

Improvement Permit

Owner: MOORE HL PROPERTIES Phone # 910-725-1371
 Directions To Property: 442 HYLAND HILLS RD., SOUTHERN PINES, NC 28388

Design Flow Units: 4 BEDROOM GPD per Unit: 120 Total Daily Design Flow: 480 gpd
 Waste Strength: DOMESTIC Number of Occupants: 8 Water Supply: PUBLIC
 Tri-Party Agreement? Yes: No: X Easements Required: Yes: No: X

Initial System

Septic Tank Size: 1000 gal Pump Tank Size: 1000 gal Max Trench Depth: 30 in
 LTAR: 0.8 Total Trench Length: 450 ft Trench Width: 3 ft

HORIZONTAL PANEL BLOCK

Media Depth: 14 in System Type: BED SYSTEM Distribution Method: D-BOX

Repair System

Septic Tank Size: 1000 gal Pump Tank Size: 1000 gal Max Trench Depth: 30 in
 LTAR: 0.8 Total Trench Length: 450 ft Trench Width: 3 ft

HORIZONTAL PANEL BLOCK

Media Depth: 14 in System Type: BED SYSTEM Distribution Method: D-BOX

Permit Conditions:

- 1) Distance to Water Supplies: Wells, Springs, Etc.: >50' Lakes, Streams, Etc.: >50'
 Water Lines: >10' Interceptor/Storm Drains: 10'/15'
- 2) Any underground utilities, irrigation components, accessory structures, or pools shall not be installed within the septic system area or septic repair area.
- 3) Maintain all applicable setbacks to septic system components.
- 4) **INSTALL ONLY IN DRY CONDITIONS.**
- 5) **TREE REMOVAL REQUIRED.**
- 6) **50% REDUCTION, HORIZONTAL PANEL BLOCK BED SYSTEM, 18ft x 25ft, INSTALL 6 LINES AT 25 FEET EACH, 6 PANELS PER LINE, 3 FOOT ON CENTER, MAX TRENCH DEPTH 30 INCHES, INSTALL SEPTIC TANK SHALLOW / AT GRADE, SEED AND STRAW DRAIN LINES FOR EROSION CONTROL.**
- 7) **D-BOX WITH SPEED LEVELERS REQUIRED.**
- 8) **PUMP TANK WITH PRESSURE MANIFOLD MAY BE REQUIRED BASED UPON FINAL ELEVATIONS.**
- 9) **DO NOT GRADE SEPTIC AREA WHEN REMOVING TREES.**

Issued By: MICHAEL OXENDINE REHS  Date: 2/10/2026

The issuance of this permit in no way guarantees the issuance of other permits. The permit holder is responsible for checking with appropriate governing bodies in meeting their requirements. This permit is subject to revocation if the site plan, plat, or the intended use changes. The Improvement Permit shall not be affected by a change in ownership of the site. This permit is subject to compliance with the provisions of 15A NCAC 18E and to the conditions of this permit. This Permit is Valid for a period of Sixty (60) Months unless the site, site plan, plat, or intended use of the property changes.

Authorization to Construct Wastewater System

Issued By: MICHAEL OXENDINE REHS  Date: 2/10/2026

The requirements of 15A NCAC 18E are incorporated by reference into this permit and shall be met. Systems shall be installed in accordance with the attached site sketch. This Construction Authorization is subject to revocation if the site plan, plat, or the intended use changes. The Construction Authorization shall not be affected by a change in ownership of the site. This Construction Authorization is subject to compliance with the provisions of 15A NCAC 18E, or 15A NCAC 18A .1900, as applicable, and to the conditions of this permit. This Authorization is Necessary Prior to Obtaining a Building or Electrical Permit and expires Sixty (60) Months from the date issued or immediately if the site, site plan, or intended use of the property changes.

- Do not grade, compact, or otherwise disturb soil in original system area or repair area**
- Property lines/corners must be clearly marked at time of installation and inspection**
- Divert downspouts and all surface water from system area**
- Install interceptor drain _____ inches deep
- Install on contour**
- Authorization to construct permit will be issued after receiving final house/site plan
- Six inches of approved soil over nitrification lines required
- Rake trench sidewalls
- Install pipe for copper sulfate. Add copper sulfate in system**
- Pump, crush, and fill existing tank
- Filter fabric required
- Seed and straw nitrification lines**
- Filter rated for grease removal
- Filter rated for hair removal in wash tank
- Approved and properly rated effluent filter required**
- Risers and openings must be sealed with mastic, butyl rubber, and fibered cement or hydraulic cement**
- Must test electrical and pump components**
- 50 lbs. pressure for two hours on pressure line
- Must water or vacuum test tanks
- Call health department before installing system (910) 947-6284**
- Meet health department onsite a minimum of 24 hours before installing system**

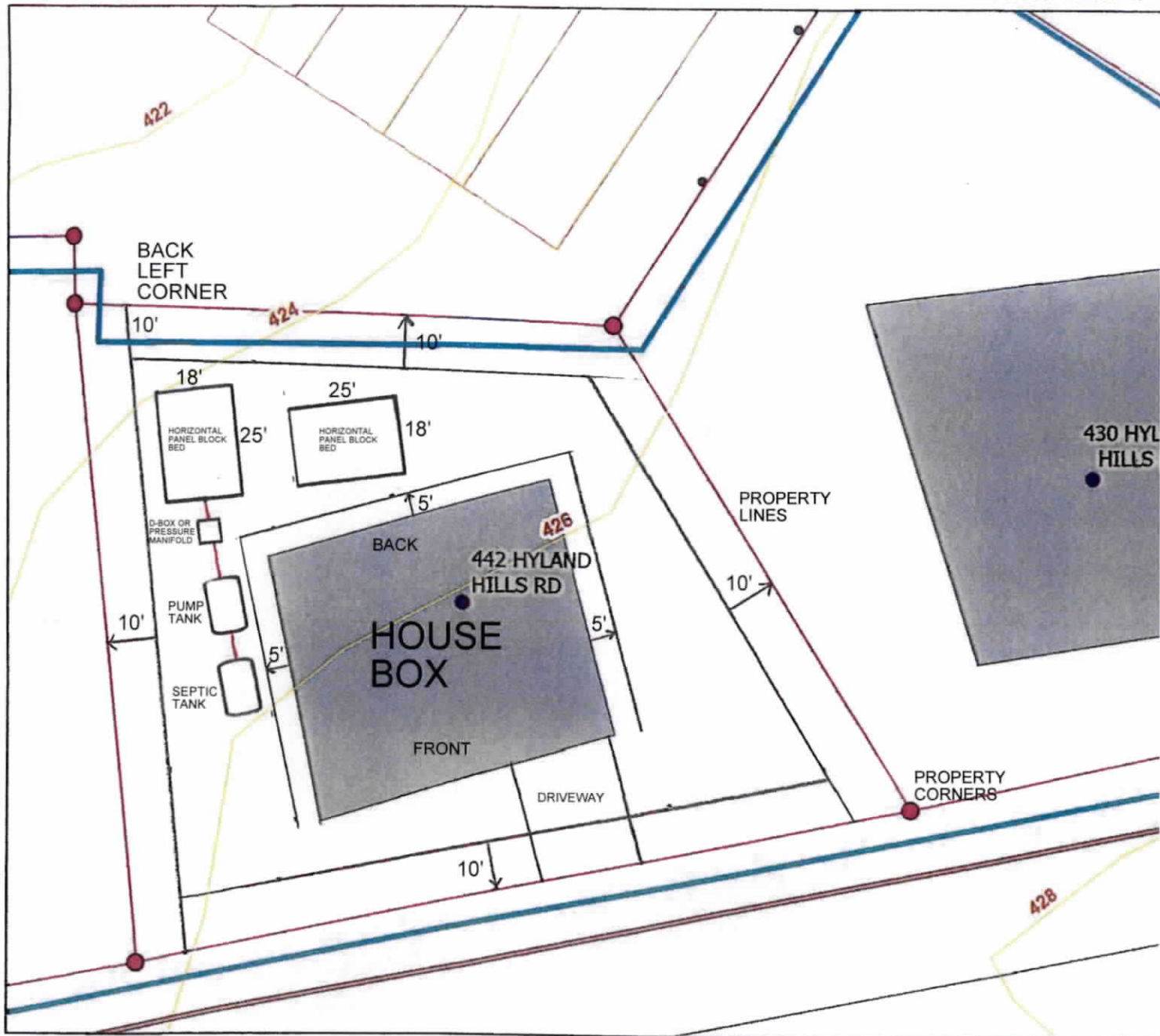

442 HYLAND HILLS RD., SOUTHERN PINES

ONSITE SEPTIC SITE PLAN 2/10/26

MICHAEL OXENDINE REHS *Michael Oxendine Rehs*

NOT TO SCALE

INSTALL 10ft OFF BACK LEFT CORNER

HORIZONTAL PANEL BLOCK BED

18ft x 25ft = 450ft²

D-BOX WITH SPEED LEVELERS

INSTALL 6 LINES, 25ft EACH
6 PANELS PER LINE

MAX TRENCH DEPTH 30 INCHES

PUMP TANK WITH PRESSURE MANIFOLD
MAY BE REQUIRED