

1888 Pony Farm Road, Jacksonville, Onslow County, North Carolina, United States, 28540

Gross Living Area: 1615 sq. ft

Level 1

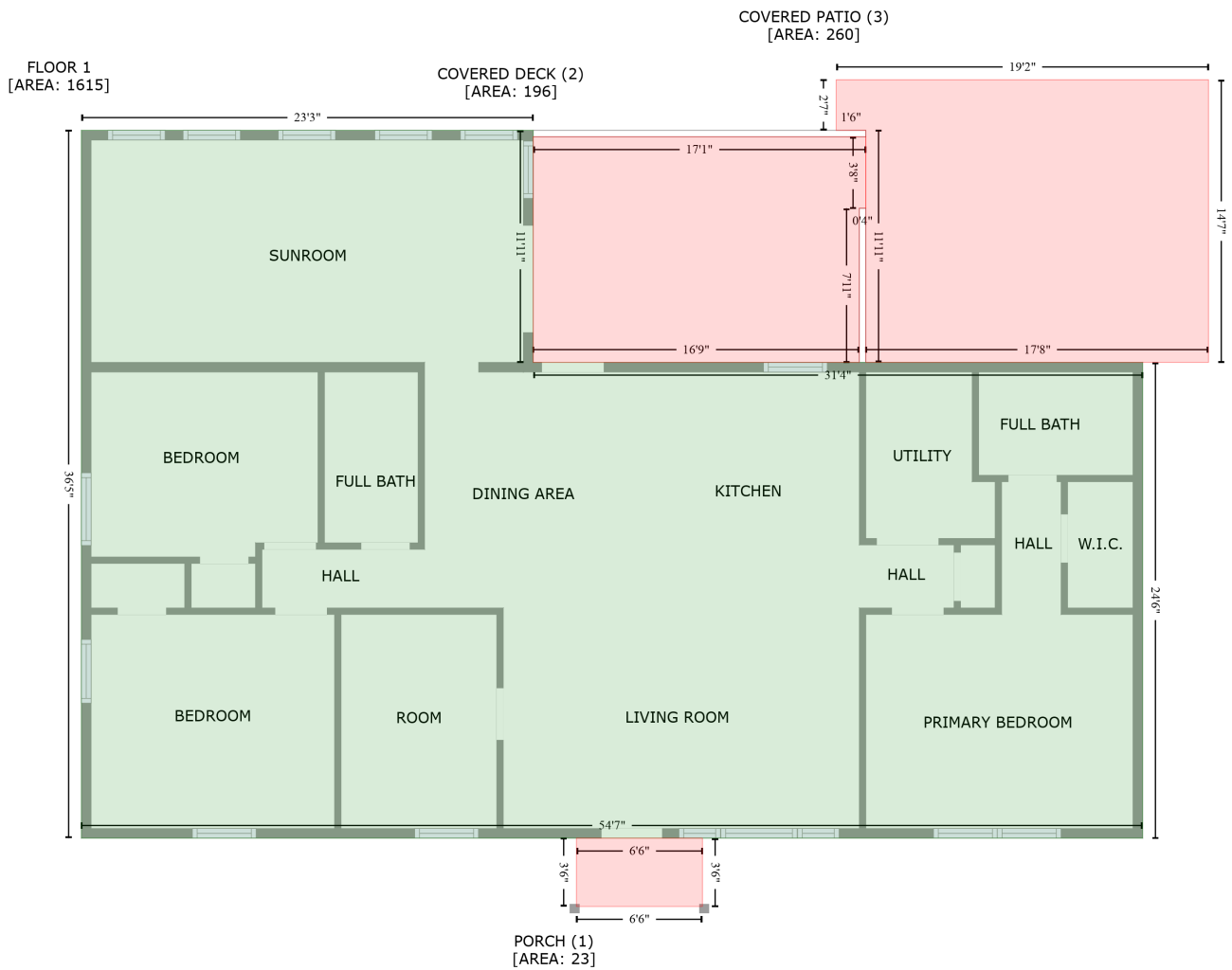

Space	Area (sq. ft)	Calculation
FLOOR 1 (Living area)	1615	$-\left((212.4 + 212.4) * (127.8 - 271.2) + (212.4 + 588.8) * (271.2 - 271.2) + (588.8 + 588.8) * (271.2 - 565.1) + (588.8 + -66.5) * (565.1 - 565.1) + (-66.5 + -66.5) * (565.1 - 127.8) + (-66.5 + 212.4) * (127.8 - 127.8)\right) * 0.5 * 0.00694$
PORCH (Non-living area)	23	$-\left((316.9 + 316.9) * (565.1 - 607.2) + (316.9 + 239.1) * (607.2 - 607.2) + (239.1 + 239.1) * (607.2 - 565.1) + (239.1 + 316.9) * (565.1 - 565.1)\right) * 0.5 * 0.00694$
COVERED DECK (Non-living area)	196	$-\left((417.8 + 417.8) * (131.8 - 176) + (417.8 + 413.8) * (176 - 176) + (413.8 + 413.8) * (176 - 271.2) + (413.8 + 212.4) * (271.2 - 271.2) + (212.4 + 212.4) * (271.2 - 131.8) + (212.4 + 417.8) * (131.8 - 131.8)\right) * 0.5 * 0.00694$
COVERED PATIO (Non-living area)	260	$-\left((629.4 + 629.4) * (96.6 - 271.2) + (629.4 + 417.8) * (271.2 - 271.2) + (417.8 + 417.8) * (271.2 - 127.8) + (417.8 + 399.5) * (127.8 - 127.9) + (399.5 + 399.5) * (127.9 - 96.6) + (399.5 + 629.4) * (96.6 - 96.6)\right) * 0.5 * 0.00694$