

INVOICE

FROM:
 Miller Appraisal
 Miller Appraisal
 3631 Fountain Hill Dr
 Grifton, NC 28530-8411
 Telephone Number: (252) 526-7012 Fax Number:

INVOICE NUMBER	
See Main File Number On Form	
DATES	
Invoice Date:	02/15/2024
Due Date:	
REFERENCE	
Internal Order #:	PD24031
Lender Case #:	Randolph
Client File #:	
FHA/VA Case #:	
Main File # on form:	PD24031
Other File # on form:	PD24031
Federal Tax ID:	02-0548137
Employer ID:	

TO:
 ,
 E-Mail:
 Telephone Number: Fax Number:
 Alternate Number:

DESCRIPTION

Lender: Client: Deborah Randolph
 Purchaser/Borrower:
 Property Address: 3842 W Wilson St
 City: Farmville
 County: Pitt State: NC Zip: 27828
 Legal Description:

FEES	AMOUNT
------	--------

Appraisal / * Please put the " Main File # " on the check as my invoice #. Thank You.	100.00
SUBTOTAL	100.00

PAYMENTS	AMOUNT
----------	--------

Check #:	Date:	Description:	
Check #:	Date:	Description:	
Check #:	Date:	Description:	
SUBTOTAL			0

TOTAL DUE	\$ 100.00
-----------	-----------

Subject Photo Page

Borrower/Client						
Property Address 3842 W Wilson St						
City Farmville		County Pitt		State NC		Zip Code 27828
Lender						



Subject Front

- Sales Price
- Gross Living Area
- Total Rooms
- Total Bedrooms
- Total Bathrooms
- Location
- View
- Site
- Quality
- Age



Subject Rear

Subject Street

Building Sketch (Page - 1)

Borrower/Client			
Property Address	3842 W Wilson St		
City	Farmville	County	Pitt
		State	NC
		Zip Code	27828
Lender			

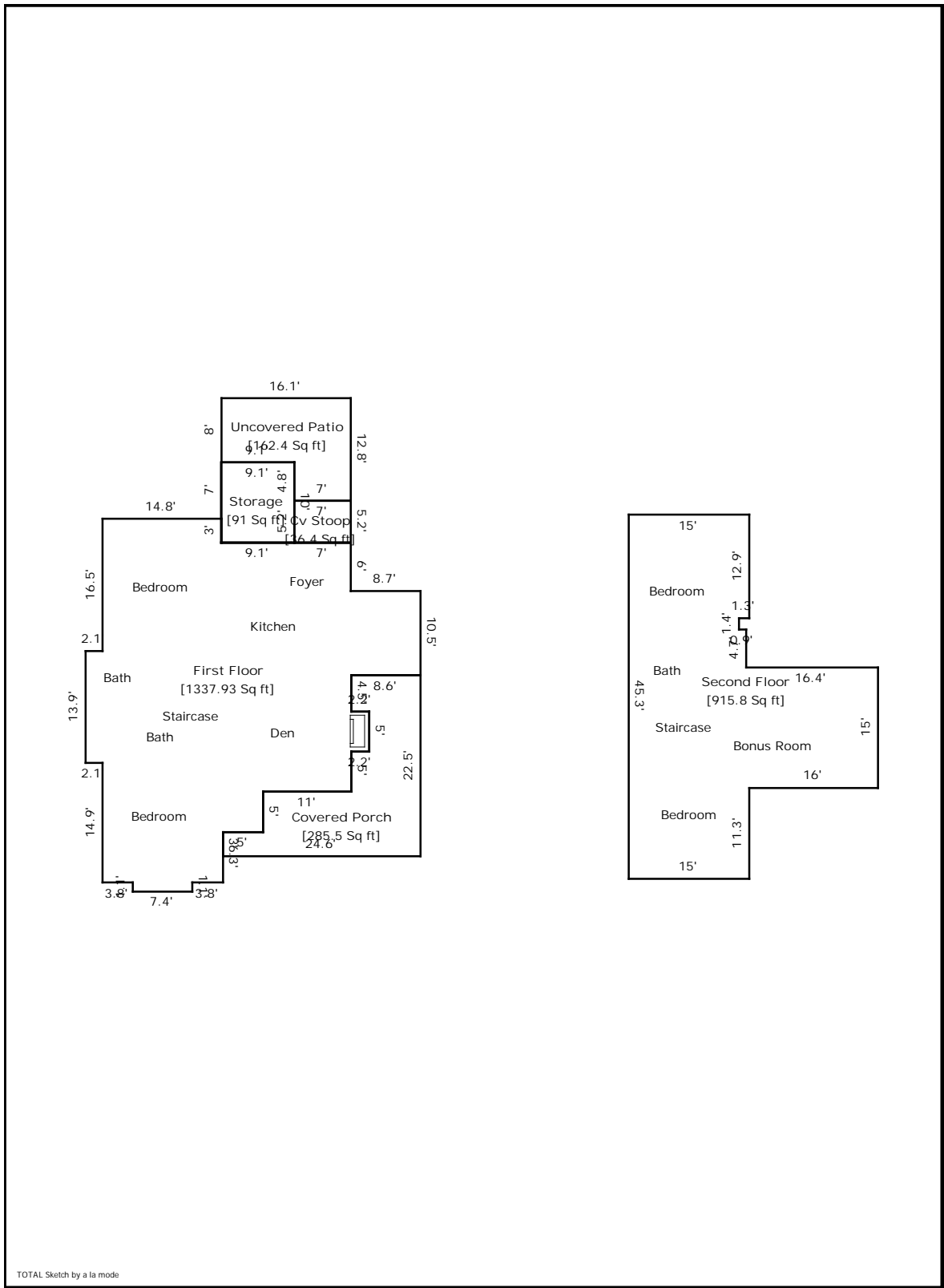

TOTAL Sketch by a la mode

Building Sketch (Page - 2)

Borrower/Client			
Property Address	3842 W Wilson St		
City	Farmville	County	Pitt
		State	NC
		Zip Code	27828
Lender			

Living Area		Calculation Details
First Floor	1337.93 Sq ft	$13.9 \times 2.1 = 29.19$ $5 \times 2.2 = 11$ $7.4 \times 1.1 = 8.14$ $10.5 \times 8.6 = 90.3$ $15 \times 6.3 = 94.5$ $39 \times 14.8 = 577.2$ $5.2 \times 5 = 26$ $16.2 \times 25 = 405$ $16.1 \times 6 = 96.6$
Second Floor	915.8 Sq ft	$45.3 \times 13.7 = 620.61$ $15 \times 16 = 240$ $0.9 \times 4.7 = 4.23$ $26.3 \times 1.3 = 34.19$ $12.9 \times 1.3 = 16.77$
Total Living Area (Rounded):	2254 Sq ft	
Non-living Area		
Cv Stoop	36.4 Sq ft	$7 \times 5.2 = 36.4$
Storage	91 Sq ft	$9.1 \times 10 = 91$
Covered Porch	285.5 Sq ft	$3 \times 5 = 15$ $8 \times 11 = 88$ $8.6 \times 13 = 111.8$ $6.4 \times 5 = 32$ $4.5 \times 8.6 = 38.7$