

MOORE COUNTY HEALTH DEPARTMENT
ENVIRONMENTAL HEALTH SECTION
OPERATION PERMIT

3 Bedroom septic

C 2015 6/12/08

Owner: Poul McNeill Address: 158 Ernie Dr Pinebluff
Permit # _____ Receipt # 80395 LRK# 55493
Installer: Rob Hartzen Telephone: 638 5519
Address: Pinehurst
System Type: chamber fec Maximum Design Flow: 360 (gallons/day)
Wastewater Characteristics: domestic
Septic Tank Capacity: 1000 (Gallons) Tank I.D. # 878103 4/21
Nitrification Line Dimensions: 2-68 x 3
Effluent Distribution Device: serial Gravel Depth: _____
Depth To: _____ Top of Tanks: 4" (Inches) Trench Bottom 22" (Inches)

Diagram of Actual Installation: (Depict Property Boundaries, Structures, Driveways, Trees, Water Lines, Water Supplies, Etc.)

Scale: _____ Inch = _____ Feet.

see attachment

Comments and Conditions: _____

Issued By: Charles Riegs # of Attachments: 1
Date: 6/11/08

FINAL APPROVAL OF THIS SYSTEM SHALL INDICATE THAT THE SYSTEM HAS BEEN INSTALLED IN ACCORDANCE WITH APPLICABLE PERMIT CONDITIONS, LAWS AND RULES, BUT IN NO WAY SHOULD BE TAKEN AS A GUARANTEE THAT THE SYSTEM WILL FUNCTION SATISFACTORILY FOR ANY GIVEN TIME.



Department of Health
County of Moore
705 Pinehurst Avenue • P.O. Box 279
Carthage, NC 28327-0279

Owner: Paul McNeill

Page 2 of 2

Addendum to Receipt # 80395

LRR # 55493

PLOT PLAN

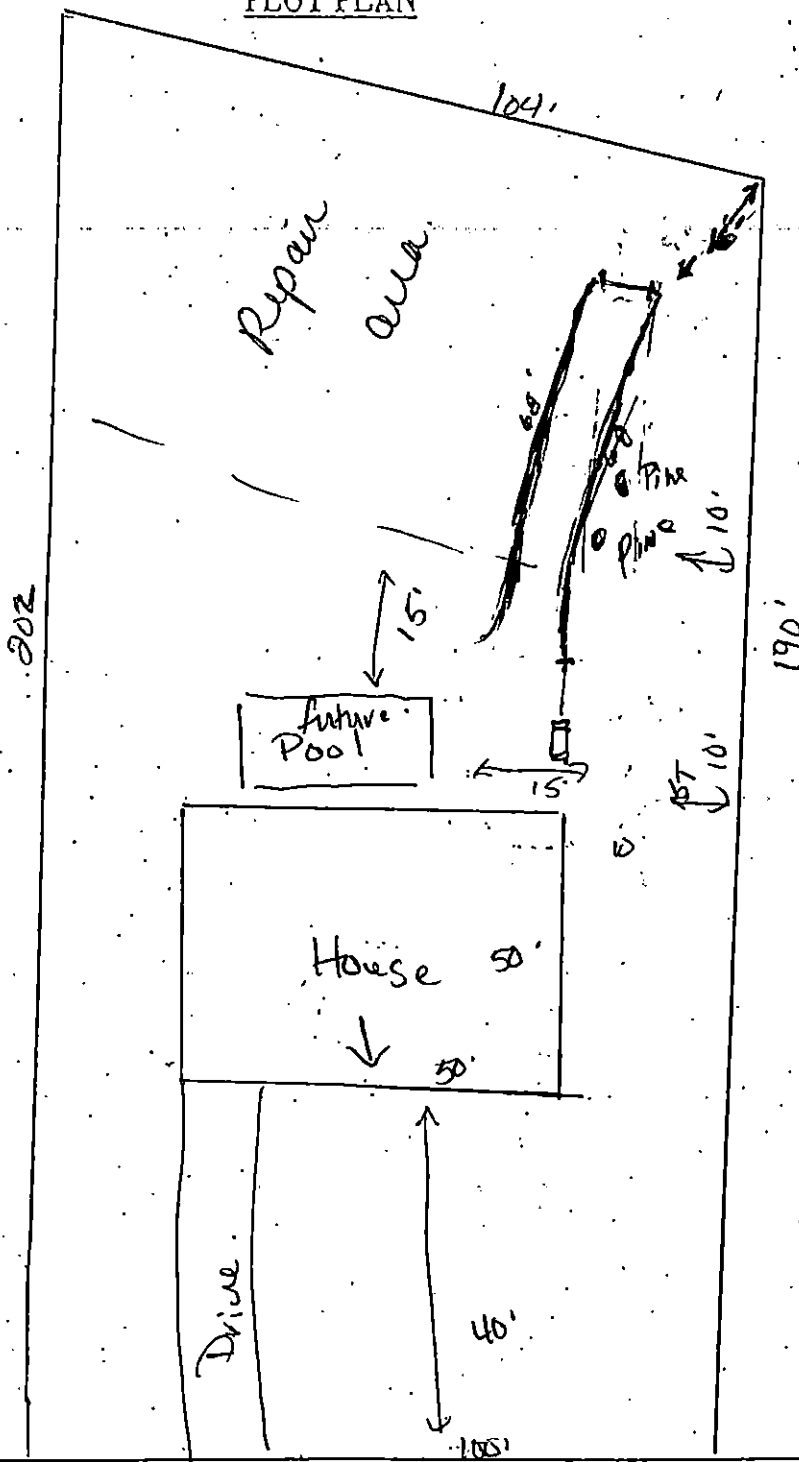

Ernie Dr.