



3:00 PM

# JOHNSTON COUNTY ENVIRONMENTAL HEALTH DEPARTMENT

309 East Market Street  
Smithfield, North Carolina 27577  
Telephone: (919)989-5180 · Fax: (919) 989-5190  
www.johnstonnc.com/envhealth2

Application # 198611 Parcel # 03Q05038F

Name : Carroll Construction Address: 437 Earnest Way Kenly, NC 27542

Location: Off Princeton-Kenly Rd

Subdivision: Godfrey Farm Lot #: 25 Lot Area: .79 Acre(s) Water Source: Public

Facility Type: 3 Bedroom SFD (Max Occupancy 6) Daily Flow For Design: 120 gallons/bedroom DDSF: 360 gallons/day

Service Type: New Construction Soil Site Classification: Provisionally Suitable LTAR: .6 gallons/day/ft<sup>2</sup>

Septic Tank: 1000 gallons Grease Trap: N/A gallons Pump Tank: 1000 gallons

Trench Type: Gravel or Accepted Trench Area: 600 ft<sup>2</sup> # of Lines: 4

Width: 3 feet Length: 50 feet Depth: 18-20 inches

Pump Size: 15.5 ft TDH @ 21 gallons/minute Pressure Head: N/A Drawdown: 5.1 inches

Design/Layout by: N/A Improvement Permit: Alan Farnior Date: 8/14/23 Exp. Date: 8/14/28

Inspection: Lines: 3-50' Poly Septic Tank: measured D-Box: measured

Pump Tank: measured Pump(s) Pressure: measured Alarm: measured

Grease Trap: measured Drainage: measured Contractor: Carroll Const. 919-285-6302

### AUTHORIZATION FOR WASTEWATER SYSTEM CONSTRUCTION

ISSUED BY: Alan Farnior DATE ISSUED: 8/14/2023

By rule, this septic system requires the use of an effluent filter and a waterproof seal. A riser and septic marker may also be required. Systems shall be installed as shown in sketch and/or according to attached plans and specifications. Any unauthorized site disturbance, filling, soil removal, or layout changes may result in the permit being revoked. Improvement permit is valid for 5 years from the date of issuance unless otherwise indicated. The owner/agent accepts & verifies the conditions of the permit as indicated below. Maintenance is required to ensure proper operation.

OWNER/AGENT: \_\_\_\_\_ DATE: \_\_\_\_\_

PLEASE CALL FOR ANY PRE-CONSTRUCTION MEETING IF ANY ISSUES ARISE AT THE TIME OF INSTALLATION

- DO NOT CUT, FILL, OR ALTER SEPTIC OR REPAIR AREAS
- OBEY ALL SETBACKS
- KEEP ALL DRAINLINES ON CONTOUR
- DIVERT ALL GUTTER DRAINS AWAY FROM SEPTIC AREA
- DO NOT INSTALL IN WET CONDITIONS

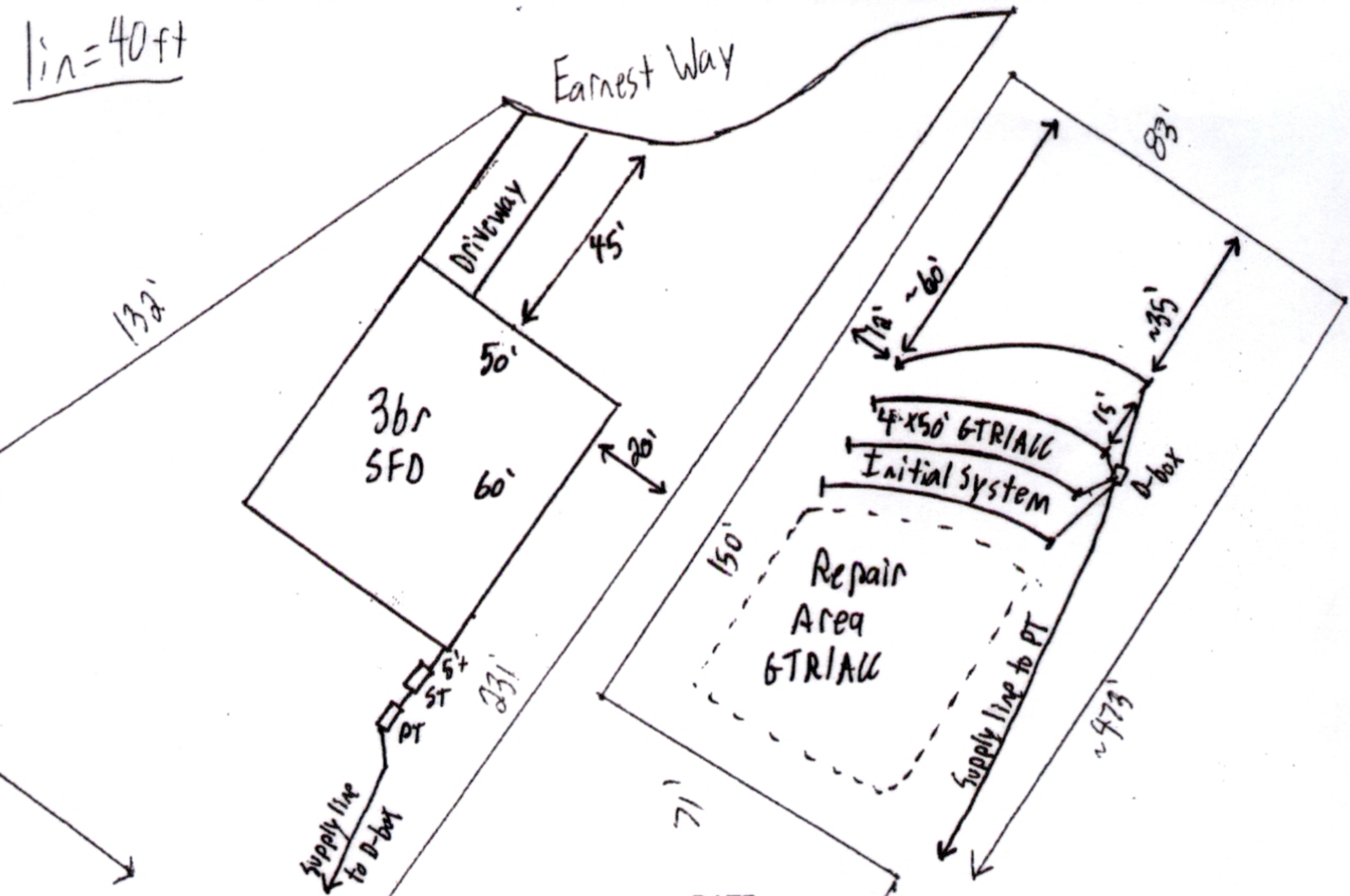

OPERATION PERMIT BY: [Signature] DATE: 12/13/24