

NOTES:
 1. AREAS BY COORDINATE METHOD.
 2. THIS PROPERTY SUBJECT TO RICHMOND COUNTY ZONING ADMINISTRATION, EASEMENTS, RIGHTS OF WAY, AND RESTRICTIVE COVENANTS OF RECORD.
 3. THIS PROPERTY IS NOT SUBJECT TO 100 YEAR FLOOD ZONE AS SHOWN ON FLOOD INSURANCE RATE MAP 37153C0100C EFFECTIVE 9/8/89.
 4. SITE ZONED R-R
 MINIMUM WIDTH = 50'
 MINIMUM LOT AREA = 40,000 SF
 BUILDING SETBACKS:
 FY = 45'
 SY = 15'
 RY = 15'
 SIDE STREET = 45'

SURVEY STATUS

A. THIS SURVEY CREATES A SUBDIVISION OF LAND WITHIN THE AREA OF A COUNTY OF ADMINISTRATION THAT HAS AN ORDINANCE THAT RELATES PARCELS OF LAND, SEE CERTIFICATE OF APPROVAL AS SHOWN HEREON.

Craig S. McNeill
 CRAIG S. McNEILL, NCLPS # 2963

NORTH CAROLINA RICHMOND COUNTY

I, CRAIG S. McNEILL, CERTIFY THAT THIS MAP WAS DRAWN UNDER MY SUPERVISION FROM AN ACTUAL SURVEY MADE BY ME, OR UNDER MY DIRECT SUPERVISION FROM DEED DESCRIPTIONS RECORDED IN DEED BOOKS AND PAGES AS FOLLOWS:
 BEING A SUBDIVISION OF A PORTION OF THE PROPERTY CONVEYED TO MCKEOUGH LAND COMPANY, INC. IN D.B. 1388, PG. 317
 THAT THE BOUNDARIES ARE CLEARLY INDICATED AS DASHED LINES, AS DRAWN FROM INFORMATION OF RECORD AS SHOWN HEREON.

THAT THE RATIO OF PRECISION AS CALCULATED IS 1/7,500. THAT THIS MAP WAS PREPARED IN ACCORDANCE WITH G.S. 47-30 AS AMENDED.
 WITNESS MY HAND AND OFFICIAL STAMP OR SEAL.

05/09/07

DATE

STATE OF NORTH CAROLINA
Colburn Funn
 REVIEW OFFICER OF RICHMOND COUNTY, CERTIFY THAT THIS MAP OR PLAT TO WHICH THIS CERTIFICATION IS AFFIXED MEETS ALL STATUTORY REQUIREMENTS FOR RECORDING
 DATE: 5/10/07

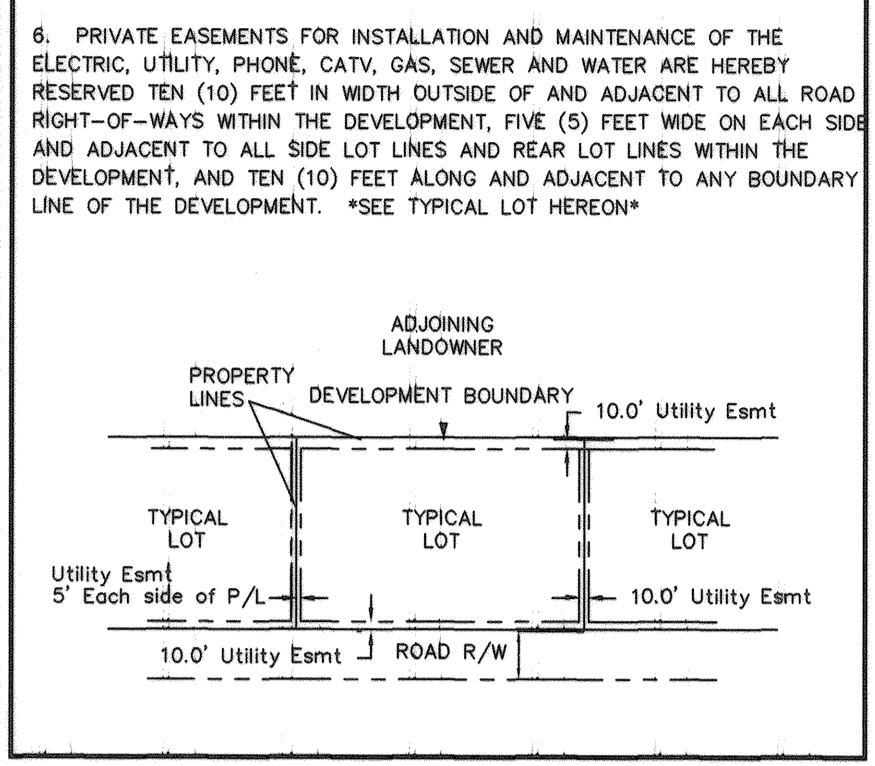

LINE TABLE

NUMBER	DIRECTION	DISTANCE	NUMBER	DIRECTION	DISTANCE	NUMBER	DIRECTION	DISTANCE	NUMBER	DIRECTION	DISTANCE	
L47	N 61°52'23" W	28.43	L101	S 41°54'18" W	51.12	L155	N 16°58'02" E	256.98	L209	S 27°37'05" W	39.33	
L48	S 71°51'52" W	98.01	L102	S 37°29'22" W	46.80	L156	N 34°34'19" E	106.43	L210	N 79°29'12" E	37.97	
L49	S 01°47'30" W	28.53	L103	S 03°59'26" E	25.54	L157	N 53°28'48" E	45.21	L211	N 19°06'07" W	35.15	
L50	S 79°12'48" W	82.88	L104	N 70°11'31" E	26.56	L158	N 21°01'01" E	307.07	L212	N 30°48'42" E	43.65	
L51	N 77°51'17" W	31.18	L105	S 63°58'45" E	23.75	L159	S 19°23'15" W	44.47	L213	N 64°21'46" E	38.36	
L52	S 22°04'03" E	25.69	L106	S 14°02'25" W	92.43	L160	S 07°17'06" E	85.57	L214	S 32°29'01" E	46.63	
L53	S 69°40'34" W	41.24	L107	S 20°52'15" W	50.26	L161	S 17°41'53" E	89.43	L215	N 66°38'00" E	53.14	
L54	S 10°56'33" W	28.28	L108	S 42°54'12" W	65.95	L162	S 08°35'04" E	75.68	L216	N 52°18'43" E	37.71	
L55	N 19°41'14" E	143.85	L109	S 01°18'45" E	37.78	L163	S 78°10'32" W	59.07	L217	N 52°18'43" E	4.48	
L56	N 01°45'16" E	156.85	L110	S 19°33'04" W	38.82	L164	S 13°35'18" W	21.12	L218	S 84°39'24" E	45.33	
L57	S 55°51'38" E	3.26	L111	S 82°09'21" W	60.52	L111	S 81°00'28" E	62.00	L165	N 68°52'10" E	55.48	
L58	S 46°59'10" W	15.32	L112	S 56°49'46" W	98.64	L166	S 23°52'21" W	48.21	L220	N 48°56'51" E	55.11	
L59	S 83°41'37" E	87.80	L113	S 64°29'11" W	34.60	L113	S 64°29'11" W	34.60	L167	S 62°21'21" W	85.33	
L60	S 37°17'36" E	11.14	L114	S 27°00'36" E	61.39	L114	S 68°33'53" E	44.70	L168	S 68°30'38" W	91.44	
L61	S 37°17'26" E	138.94	L115	S 08°47'08" E	40.45	L115	S 15°42'13" W	32.39	L169	S 69°12'04" W	53.51	
L62	S 37°17'36" E	38.01	L116	S 08°47'08" E	30.32	L116	N 21°41'11" E	71.21	L170	S 29°28'37" W	35.51	
L63	S 83°41'37" E	87.80	L117	S 61°17'15" E	58.38	L117	S 89°40'28" W	52.11	L225	S 40°24'57" E	34.85	
L64	S 82°25'03" E	123.33	L64	S 19°28'33" W	100.86	L118	S 60°17'23" E	114.24	L172	S 40°27'12" W	146.62	
L65	S 82°25'09" E	42.44	L65	S 07°39'09" E	31.72	L119	N 18°58'03" E	228.75	L173	S 28°13'37" W	92.37	
L66	S 32°29'17" E	107.93	L66	S 00°42'33" E	96.98	L120	N 18°58'03" E	74.79	L174	S 48°59'19" W	45.15	
L67	S 45°34'56" W	57.62	L67	S 52°07'13" W	73.97	L121	N 08°01'48" W	194.15	L175	S 10°52'04" W	14.02	
L68	N 38°23'20" W	42.75	L68	S 16°51'43" E	37.62	L122	N 08°01'48" W	75.71	L176	S 09°40'41" E	38.83	
L69	S 38°23'20" W	50.28	L69	S 27°09'30" W	27.84	L123	S 87°35'39" E	108.41	L177	S 21°26'12" W	61.31	
L70	N 85°24'31" E	139.70	L70	N 54°08'49" W	41.80	L124	S 89°24'23" E	64.40	L178	S 21°45'02" E	21.78	
L71	N 85°24'31" E	102.54	L71	S 68°34'32" W	66.09	L125	S 85°24'27" E	177.84	L179	S 28°13'49" W	11.27	
L72	N 87°35'39" W	108.41	L72	S 04°46'35" E	48.08	L126	S 38°23'20" W	74.92	L180	S 28°08'37" W	3.59	
L73	N 49°34'56" E	61.52	L73	S 87°38'08" W	46.60	L127	S 71°02'52" E	335.02	L181	S 08°33'35" E	52.67	
L74	N 32°29'17" E	107.93	L74	N 18°58'03" E	41.80	L128	S 89°24'23" E	64.40	L182	S 24°05'53" W	12.56	
L75	N 82°25'05" W	162.77	L75	S 39°16'43" W	76.38	L129	N 48°13'50" E	98.29	L183	S 50°49'06" E	23.92	
L76	N 22°13'30" W	79.29	L76	S 61°54'39" W	111.82	L130	S 60°22'15" W	63.41	L184	S 01°27'58" W	101.10	
L77	N 22°13'30" W	8.64	L77	S 52°19'10" W	51.81	L131	S 66°21'52" E	102.83	L185	S 27°14'22" W	56.35	
L78	N 37°17'42" W	143.00	L78	S 16°54'08" W	14.64	L132	S 38°58'06" W	116.80	L186	S 70°10'39" W	34.77	
L79	N 37°17'25" W	45.10	L79	S 54°40'22" W	23.35	L133	N 02°58'12" E	227.77	L187	S 02°58'12" E	32.40	
L80	N 83°41'37" W	87.80	L80	S 73°46'32" W	33.34	L134	N 53°32'11" W	11.99	L188	S 06°31'03" W	25.21	
L81	S 79°24'40" W	34.62	L81	S 53°34'30" E	5.92	L135	S 02°59'12" W	233.67	L189	S 52°47'18" E	31.61	
L82	S 82°25'09" E	52.23	L82	S 16°54'08" W	14.64	L136	S 38°58'06" W	116.80	L190	S 13°32'42" E	19.28	
L83	S 81°45'16" E	156.65	L83	S 85°34'38" W	68.85	L137	S 66°21'52" W	104.91	L191	S 72°01'34" W	14.62	
L84	S 19°41'14" W	143.85	L84	S 13°52'09" W	22.90	L138	N 00°32'18" E	260.78	L192	S 04°43'28" W	37.11	
L85	S 82°25'05" W	140.35	L85	S 60°53'39" E	18.46	L139	N 11°37'38" E	133.12	L193	S 21°57'21" E	64.98	
L86	S 85°05'07" W	92.18	L86	S 13°57'11" E	16.87	L140	N 11°37'38" E	133.12	L194	S 02°29'59" W	60.48	
L87	N 80°37'19" W	61.53	L87	S 37°17'36" E	39.58	L141	N 21°31'25" E	95.55	L195	S 20°02'16" E	93.07	
L88	S 80°37'19" W	37.02	L88	S 42°48'02" E	35.56	L142	N 24°50'08" E	130.12	L196	S 21°28'38" E	44.99	
L89	S 80°37'19" W	37.02	L89	S 08°27'08" E	53.41	L143	N 24°50'08" E	91.57	L197	S 21°57'21" E	27.19	
L90	S 80°37'19" W	37.02	L90	S 83°21'18" W	105.43	L144	N 24°50'08" E	270.15	L198	S 42°53'12" E	173.91	
L91	S 80°37'19" W	95.74	L91	S 81°03'01" W	37.69	L145	N 26°20'10" E	67.10	L199	S 59°27'49" E	107.60	
L92	S 80°37'19" W	64.22	L92	S 64°15'13" E	21.33	L146	N 27°50'36" E	181.99	L200	S 86°11'28" E	37.08	
L93	S 80°37'19" W	68.13	L93	S 15°18'35" W	14.45	L147	S 65°02'54" E	118.85	L201	N 18°47'33" E	42.29	
L94	S 80°37'19" W	127.02	L94	S 03°39'01" W	18.47	L148	S 69°09'20" E	26.26	L202	S 61°59'40" E	43.70	
L95	S 80°37'19" W	38.88	L95	S 76°01'02" W	27.28	L149	S 01°47'25" E	317.92	L203	N 28°08'00" E	41.37	
L96	S 79°29'11" W	97.53	L96	S 08°38'57" W	57.73	L150	S 31°58'00" E	213.67	L204	N 54°30'30" E	139.23	
L97	S 79°29'11" W	198.95	L97	S 74°04'24" W	58.10	L151	S 09°35'39" E	147.73	L205	S 78°08'32" E	91.33	
L98	S 79°29'11" W	124.89	L98	S 17°09'26" W	124.89	L152	S 09°35'39" E	190.91	L206	S 69°21'19" E	40.11	
L99	S 79°29'11" W	43.32	L99	S 09°35'39" E	199.69	L153	S 09°35'39" E	199.69	L207	S 69°43'01" E	69.11	
L100	S 00°37'20" E	58.49	L100	S 07°33'48" E	190.78	L208	N 58°33'50" E	85.77				

CURVE TABLE

NUMBER	DELTA ANGLE	CHORD BRG	RADIUS	ARC LENGTH	CHORD LENGTH
C1	09°07'10"	N 47°29'21" E	525.00	83.56	83.47
C2	23°43'31"	N 31°18'30" E	525.00	212.97	211.51
C3	11°18'58"	N 14°01'15" E	525.00	103.84	103.67
C4	10°08'33"	S 03°18'00" E	525.00	82.63	82.51
C5	57°38'55"	N 27°03'11" E	275.00	276.53	265.03
C6	19°33'01"	S 65°38'09" E	275.00	93.83	93.38
C7	20°53'44"	N 85°51'31" E	275.00	100.29	99.74
C8	14°58'27"	S 76°13'23" E	275.00	71.71	71.51
C9	31°27'30"	S 53°01'21" E	275.00	150.89	149.10
C10	12°21'06"	S 31°07'03" E	475.00	102.40	102.20
C11	02°43'11"	S 23°50'01" E	475.00	22.52	22.52
C12	03°05'47"	S 23°46'23" E	525.00	28.37	28.37
C13	11°31'50"	S 15°15'15" E	525.00	105.66	105.48
C14	25°33'55"	S 49°38'07" E	525.00	234.25	232.31
C15	20°53'44"	S 47°27'11" E	275.00	143.65	143.20
C16	42°38'43"	S 11°50'56" E	275.00	204.52	199.84
C17	38°49'03"	S 29°31'57" W	175.00	118.56	116.31
C18	23°13'38"	N 49°54'47" W	585.00	233.96	232.37
C19	24°23'33"	N 73°17'57" W	585.00	246.08	244.22
C20	02°11'12"	N 86°30'03" W	1230.00	46.94	46.94
C21	02°42'10"	N 88°56'37" W	592.46	27.86	27.86
C22	32°43'11"	S 73°21'07" W	592.46	338.34	333.76
C23	35°41'54"	N 39°08'35" W	592.46	369.14	363.20
C24	38°28'15"	N 29°20'03" E	225.00	150.88	148.07
C25	33°48'49"	N 06°45'29" W	325.00	161.52	158.76
C26	08°15'58"	N 28°44'22" W	325.00	35.17	35.15
C27	02°38'56"	N 31°09'49" W	325.00	15.03	15.02
C28	28°24'56"	N 46°41'46" W	325.00	161.18	159.54
C29	01°30'45"	N 61°39'42" W	325.00	8.58	8.58
C30	31°18'59"	N 35°45'55" W	475.00	110.40	110.15
C31	26°52'53"	N 35°39'46" W	475.00	222.81	220.77
C32	15°00'12"	N 29°43'36" W	525.00	137.47	137.08
C33	07°38'57"	N 41°06'05" W	325.00	43.20	43.17
C34	28°10'36"	N 59°29'01" W	325.00	165.50	163.72
C35	09°38'28"	N 31°09'49" W	325.00	54.50	54.43
C36	13°12'53"	S 89°41'57" W	325.00	74.96	74.79
C37	07°43'01"	S 79°15'05" W	325.00	43.57	43.54
C38	19°43'01"	S 59°29'01" W	325.00	110.80	110.36
C39	13°38'14"	S 49°32'32" W	325.00	77.35	77.17
C40	21°22'07"	S 31°52'21" W	325.00	121.21	120.51
C41	22°38'51"	S 09°33'01" W	325.00	158.25	157.42
C42	21°28'31"	S 08°57'59" W	475.00	177.76	176.72
C43	18°24'10"	S 28°53'19" W	475.00	152.57	151.91
C44	03°41'11"	S 39°56'00" W	475.00	30.56	30.56
C45	01°48'17"	S 45°45'48" W	475.00	81.18	80.05
C46	15°27'59"	N 11°20'04" E	855.00	23	