

Permit # 48966 LRK# 00027011  
Property Address: 101 DOUGLAS DR., West End, NC 27376

Page 1 of 3  
Number of Bedrooms: 4



## Moore County Health Department

Environmental Health Section  
PO Box 279, Carthage, NC 27327  
Phone: 910-947-6283 Fax: 910-947-5127

### Improvement Permit

Owner: Wolf Development & Construction, LLC Phone # 910-690-7545  
Directions To Property: 447 Longleaf Dr., West End, NC 27376 (7 Lakes West)

Design Flow Units: Bedroom GPD per Unit: 120 Total Daily Design Flow: 480 gpd  
Waste Strength: Domestic Number of Occupants: 8 Water Supply: Public  
Tri-Party Agreement? Yes:        No: X Easements Required: Yes:        No: X

#### Initial System

Septic Tank Size: 1000 gal Pump Tank Size: NA gal Max Trench Depth: 18 in  
LTAR: 0.4 Total Trench Length: 306 ft Trench Width: 3 ft  
Media Depth: 12 in System Type: Accepted/25% Reduction Distribution Method: Gravity to Serial

#### Repair System

Septic Tank Size: 1000 gal Pump Tank Size: NA gal Max Trench Depth: 18 in  
LTAR: 0.4 Total Trench Length: 308 ft Trench Width: 3 ft  
Media Depth: 12 in System Type: Accepted/25% Reduction Distribution Method: Gravity to Serial

#### Permit Conditions:

- Distance to Water Supplies: Wells, Springs, Etc: >50' Lakes, Streams, Etc.: >50'  
Water Lines: >10' Interceptor/Storm Drains: 10'/15'
- Any underground utilities, irrigation components, accessory structures, or pools shall not be installed within the septic system area or septic repair area.
- Maintain all applicable setbacks to septic system components.
- Water and power must be installed along property lines (IF UTILITIES COME OFF OF LONGLEAF DR.). See site plan.
- INSTALL SEPTIC TANK SHALLOW / AT GRADE. SEPTIC TANK MUST BE WATER AND VACUUM TESTED.
- BEGIN INSTALLATION, 5' FROM DRIVEWAY AND 15' OFF RIGHT CORNER OF THE HOUSE. SEE SITE PLAN.
- ACCEPTED, 25% REDUCTION, INSTALL ON CONTOUR, 3 LINES AT 102', MAX TRENCH DEPTH 18", RAKE TO LEVEL AND MAINTAIN SIX INCHES OF COVER, SEED AND STRAW FOR EROSION CONTROL, DO NOT CUT OR GRADE LOT.
- COVER SYSTEM WITH SOD RECOMMENDED FOR EROSION CONTROL.
- TO AVOID COMPACTING SOIL FOR SEPTIC SYSTEM, DO NOT STORE SOIL SPOILS OR BUILDING SUPPLIES WITHIN SEPTIC AREA.
- PROPERTY IRONS (CORNERS) MUST BE LOCATED AND VISIBLE PRIOR TO SEPTIC INSTALLION.

Issued By: MICHAEL OXENDINE REHS

**REVISED**  
Date: 6/20/2024

The issuance of this permit in no way guarantees the issuance of other permits. The permit holder is responsible for checking with appropriate governing bodies in meeting their requirements. This permit is subject to revocation if the site plan, plat, or the intended use changes. The Improvement Permit shall not be affected by a change in ownership of the site. This permit is subject to compliance with the provisions of 15A NCAC 18E and to the conditions of this permit. This Permit is Valid for a period of Sixty (60) Months unless the site, site plan, plat, or intended use of the property changes.

### Authorization to Construct Wastewater System

Issued By: MICHAEL OXENDINE REHS

Date: 6/20/2024

The requirements of 15A NCAC 18E are incorporated by reference into this permit and shall be met. Systems shall be installed in accordance with the attached site sketch. This Construction Authorization is subject to revocation if the site plan, plat, or the intended use changes. The Construction Authorization shall not be affected by a change in ownership of the site. This Construction Authorization is subject to compliance with the provisions of 15A NCAC 18E, or 15A NCAC 18A .1900, as applicable, and to the conditions of this permit. This Authorization is Necessary Prior to Obtaining a Building or Electrical Permit and expires Sixty (60) Months from the date issued or immediately if the site, site plan, or intended use of the property changes.

- Do not grade, compact, or otherwise disturb soil in original system area or repair area
- Property Irons must be clearly marked and visible at time of installation and inspection**
- Divert downspouts and all surface water from system area
- Install interceptor drain \_\_\_\_\_ inches deep
- Install on contour
- Authorization to construct permit will be issued after receiving final house/site plan
- Six inches of approved soil over nitrification lines required
- Rake trench sidewalls
- Install pipe for copper sulfate. Add copper sulfate in system
- Pump, crush, and fill existing tank
- Filter fabric required
- Seed and straw nitrification lines, sod recommended**
- Filter rated for grease removal
- Filter rated for hair removal in wash tank
- Approved and properly rated effluent filter required
- Risers and openings must be sealed with mastic, butyl rubber, and fibered cement or hydraulic cement
- Must test electrical and pump components
- 50 lbs. pressure for two hours on pressure line
- Must water or vacuum test tanks
- Call health department before installing system (910) 947-6283
- Meet health department onsite a minimum of 24 hours before installing system

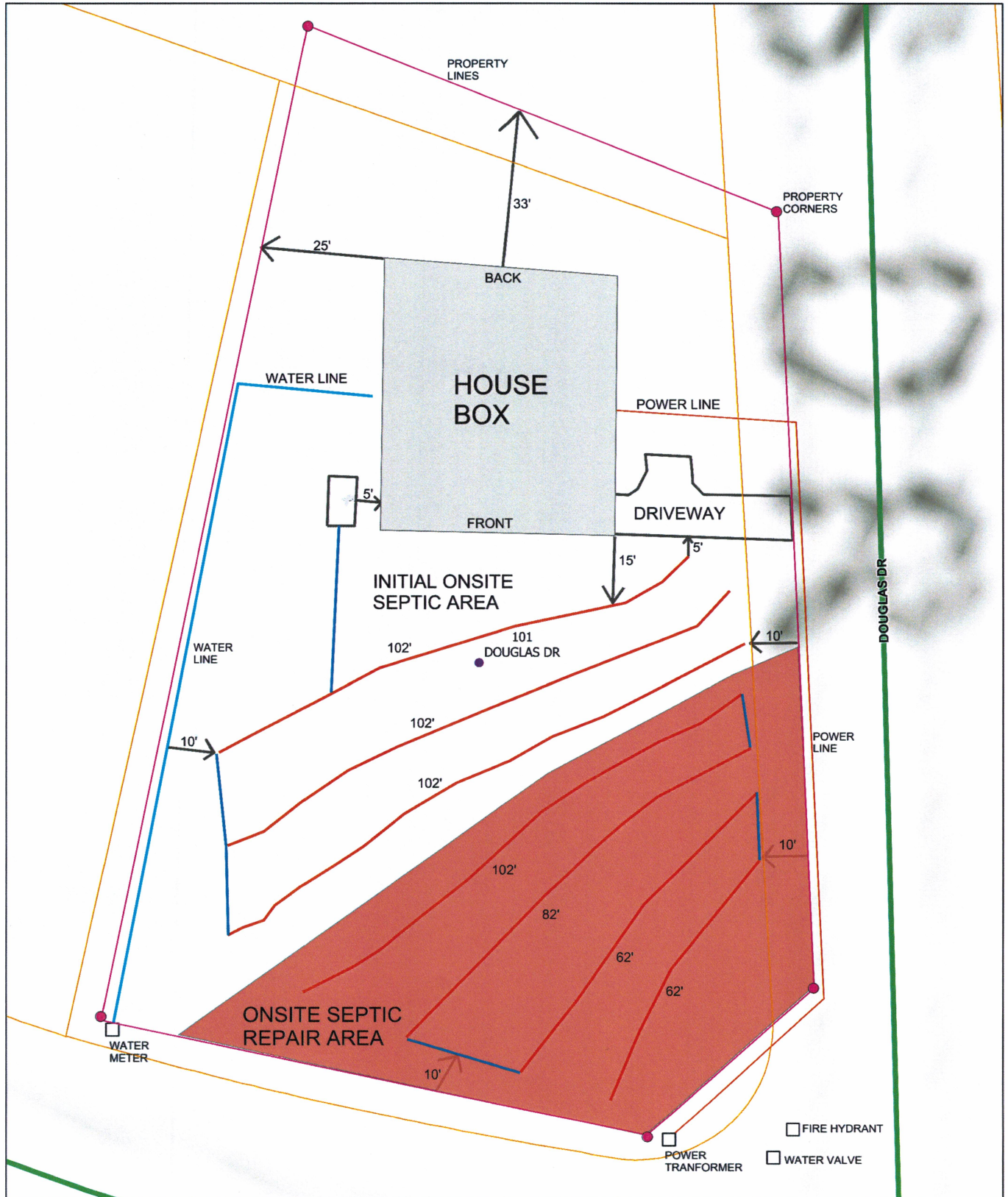

6/20/2024

101 DOUGLAS DR., WEST END (7 LAKES WEST)

ONSITE SEPTIC SITE PLAN **REVISED 6/20/24**

MICHAEL OXENDINE REHS *Michael Oxendine Rehs*

NOT TO SCALE