

317

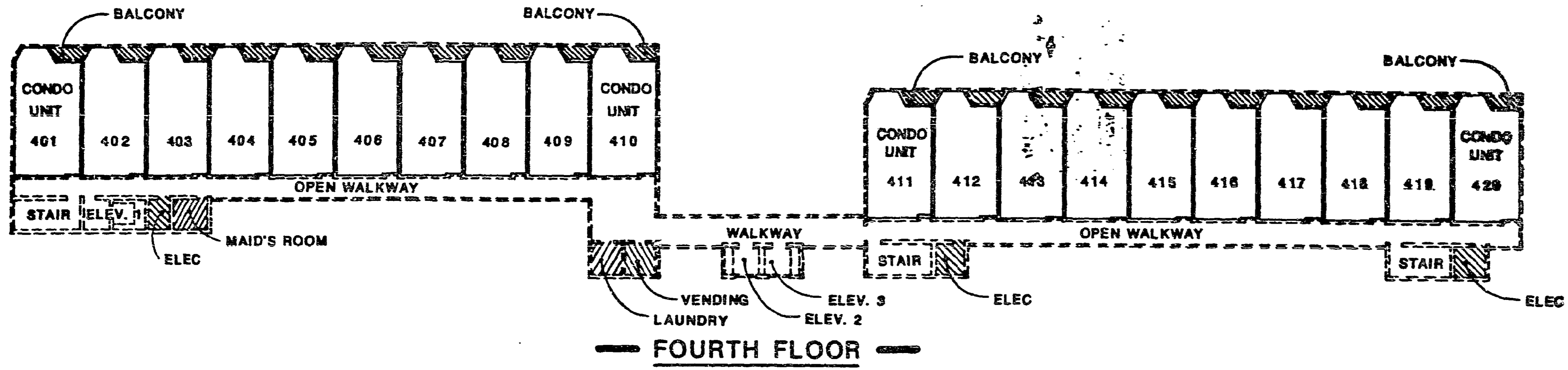

FOURTH FLOOR

FIN. CEIL. ELEV. 52.00'
FIN. FLR. ELEV. 44.00'

- LEGEND:**
- CONDO. UNIT INDICATES "CONDOMINIUM UNIT"
 - INDICATES BOUNDARY LINE OF CONDO. UNITS
 - INDICATES CONDO. PROPERTY LINES.
 - INDICATES COMMON ELEMENTS & STRUCTURAL BOUNDARIES
 - INDICATES LIMITED COMMON ELEMENTS
 - INDICATES MUTUAL DRIVE EASEMENTS BEING AREAS & FACILITIES
 - ELEMENTS INDICATES "AREAS & FACILITIES" USED IN THE DECLARATION OF CONDOMINIUM & THE BY-LAWS ATTACHED THERETO & THE UNIT OWNERSHIP ACT

CERTIFICATION OF ARCHITECT: The undersigned, an architect duly registered to practice under the laws of the State of North Carolina, hereby certifies that these plans entitled Shell Island Resort Hotel presented on 17 sheets, survey, plot plan, nine floor plans, one roof plan, four typical plans, and one section sheet are an accurate copy of portions of the plans of the building as filed with, and approved by, the municipal or other governmental subdivisions having jurisdiction over the issuance of permits for construction of buildings. These plans fully and accurately depict the layout, location, ceiling and floor heights, unit numbers and dimensions of the units as built.

BALLARD, MCKIM AND SAWYER, AIA, ARCHITECTS

Robert U. Sawyer
Robert U. Sawyer, NC Registration #831

**SHELL ISLAND RESORT HOTEL
SHELL ISLAND, WRIGHTSVILLE BEACH, N.C.**

**LOCATION OF COMMON ELEMENTS,
LIMITED COMMON ELEMENTS
& CONDOMINIUM UNITS.**

PREPARED BY:
BALLARD, MCKIM and SAWYER-ARCHITECTS
WILMINGTON, N.C.
SHEET 6 OF 17 SHTS.

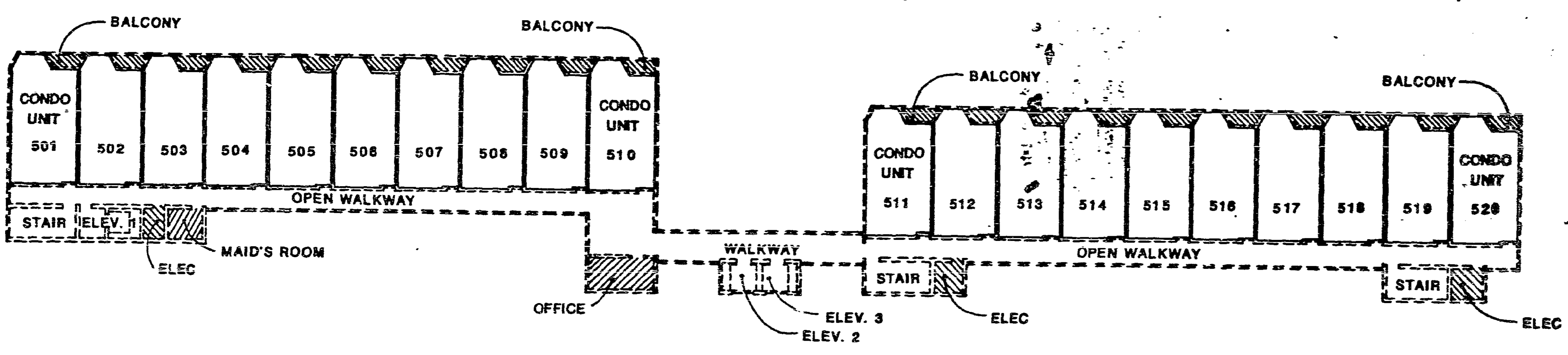

FIFTH FLOOR

FIN. CEIL. ELEV. 60.50'
FIN. FLR. ELEV. 52.50'

- LEGEND:**
- CONDO. UNIT INDICATES "CONDOMINIUM UNIT"
 - INDICATES BOUNDARY LINE OF CONDO. UNITS
 - INDICATES CONDO. PROPERTY LINES.
 - INDICATES COMMON ELEMENTS & STRUCTURAL BOUNDARIES
 - INDICATES LIMITED COMMON ELEMENTS
 - INDICATES MUTUAL DRIVE EASEMENTS BEING AREAS & FACILITIES
 - ELEMENTS INDICATES "AREAS & FACILITIES" USED IN THE DECLARATION OF CONDOMINIUM & THE BY-LAWS ATTACHED THERETO & THE UNIT OWNERSHIP ACT

CERTIFICATION OF ARCHITECT: The undersigned, an architect duly registered to practice under the laws of the State of North Carolina, hereby certifies that these plans entitled Shell Island Resort Hotel presented on 17 sheets, survey, plot plan, nine floor plans, one roof plan, four typical plans, and one section sheet are an accurate copy of portions of the plans of the building as filed with, and approved by, the municipal or other governmental subdivisions having jurisdiction over the issuance of permits for construction of buildings. These plans fully and accurately depict the layout, location, ceiling and floor heights, unit numbers and dimensions of the units as built.

BALLARD, MCKIM AND SAWYER, AIA, ARCHITECTS

Robert U. Sawyer
Robert U. Sawyer, NC Registration #831

**SHELL ISLAND RESORT HOTEL
SHELL ISLAND, WRIGHTSVILLE BEACH, N.C.**

**LOCATION OF COMMON ELEMENTS,
LIMITED COMMON ELEMENTS
& CONDOMINIUM UNITS.**

PREPARED BY:
BALLARD, MCKIM and SAWYER-ARCHITECTS
WILMINGTON, N.C.
SHEET 7 OF 17 SHTS.