

108 N Lamplighters Walk
Hampstead, NC 28443

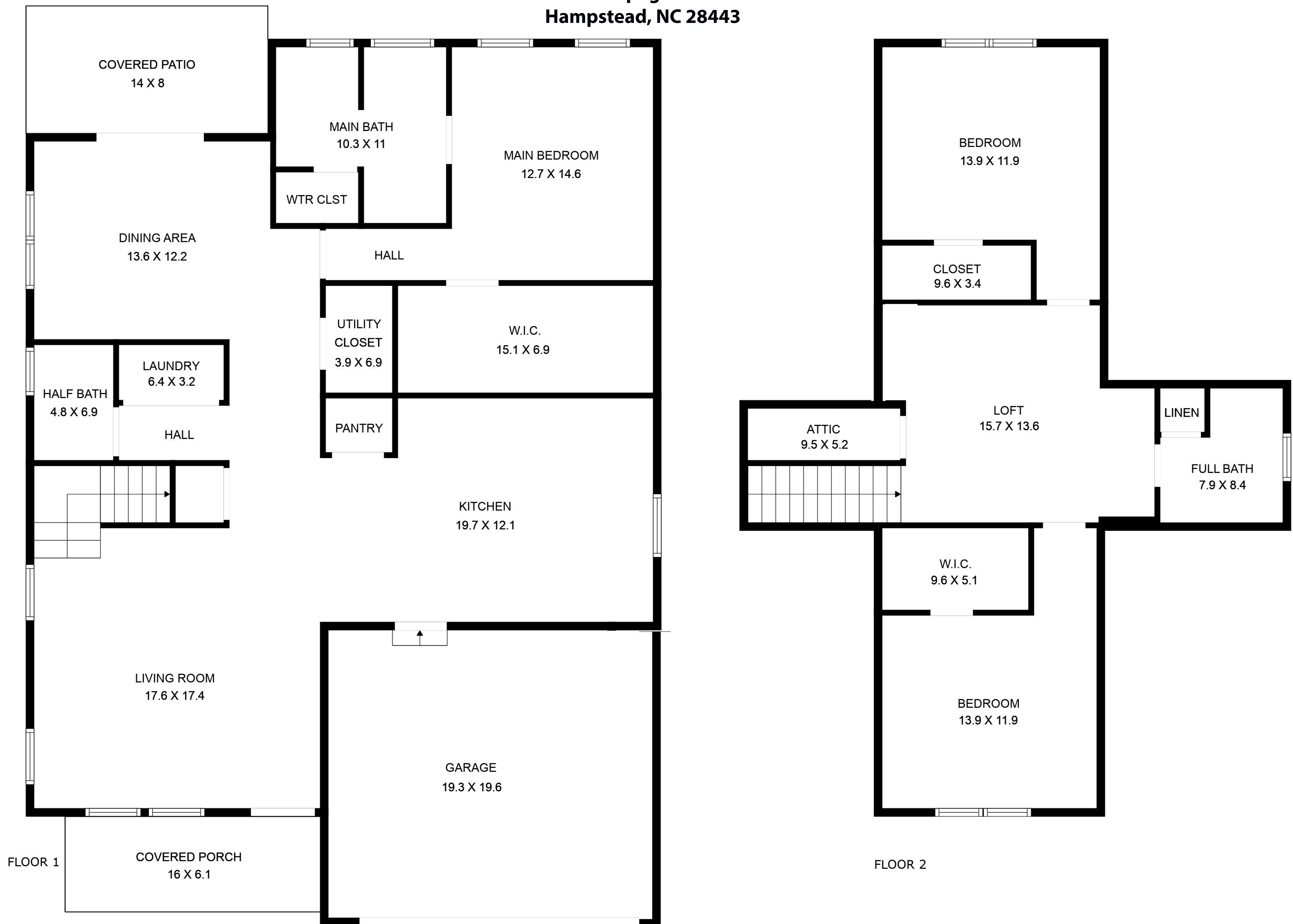

Total Heated: 2395 sq ft.

Floor 1: 1514 sq ft. Floor 2: 882 sq ft.

Excluded Areas: Garage: 422 sq ft. Cov Porch: 112 sq ft. Attic: 49 sq ft. Cov Patio: 112 sq ft. Storage: 120 sq ft.

CALCULATION SUMMARY

Borrower/Client				
Property Address 108 S Lamplighters Walk				
City	Hampstead	County	Pender	State NC Zip Code 28443
Lender				

GROSS LIVING AREA 2,395 SQ FT
ROOMS 7 / BEDROOMS 3 / FULL BATHS 2 / HALF BATH 1

TOTAL Sketch by a la mode

Area Calculations Summary

Living Area	Calculation Details	
First Floor	1513.8 Sq ft	$35.3 \times 19.8 = 698.9$ $4.6 \times 6.1 = 28.1$ $42.3 \times 18.6 = 786.8$
Second Floor	881.7 Sq ft	$9.4 \times 11.9 = 111.9$ $48.4 \times 14.7 = 711.5$ $6.2 \times 4 = 24.8$ $4.3 \times 7.8 = 33.5$
Total Living Area (Rounded):	2395 Sq ft	
Non-living Area		
Covered Patio	112 Sq ft	$14 \times 8 = 112$
2 Car Built-in	421.8 Sq ft	$21.1 \times 19.8 = 417.8$ $8 \times 0.5 = 4$
Cov Porch	97.6 Sq ft	$16 \times 6.1 = 97.6$
Attic	49.4 Sq ft	$9.5 \times 5.2 = 49.4$
Storage	120 Sq ft	$12 \times 10 = 120$