

Building Sketch (Page - 1)

Borrower/Client				
Property Address 339 Lambs Rd				
City	Camden	County	State	NC Zip Code 27921
Lender				

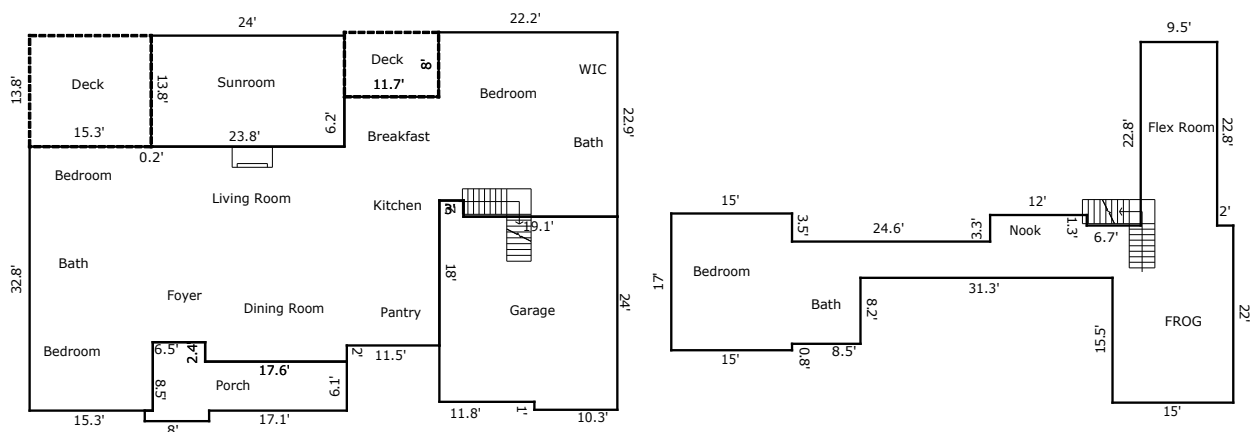

TOTAL Sketch by a la mode

Building Sketch (Page - 2)

Borrower/Client				
Property Address 339 Lambs Rd				
City	Camden	County	State	NC Zip Code 27921
Lender				

TOTAL Sketch by a la mode

Area Calculations Summary

Living Area	Calculation Details	
First Floor	1987.81 Sq ft	$22.9 \times 19.1 = 437.39$ $15.3 \times 8.5 = 130.05$ $24.3 \times 21.8 = 529.74$ $26.7 \times 17.3 = 461.91$ $3.1 \times 8 = 24.8$ $14.8 \times 12.9 = 190.92$ $11.8 \times 18 = 212.4$ $2 \times 0.3 = 0.6$
Second Floor	1096.4 Sq ft	$9.5 \times 22.8 = 216.6$ $17 \times 15 = 255$ $15 \times 15.5 = 232.5$ $8.5 \times 8.2 = 69.7$ $6.5 \times 18.2 = 118.3$ $7.8 \times 12 = 93.6$ $4.5 \times 24.6 = 110.7$
Total Living Area (Rounded):	3084 Sq ft	
Non-living Area		
Sun Room	331.2 Sq ft	$24 \times 13.8 = 331.2$
Covered Porch	173.01 Sq ft	$8 \times 1.3 = 10.4$ $8.5 \times 6.5 = 55.25$ $17.6 \times 6.1 = 107.36$
2 Car Attached	524.6 Sq ft	$3 \times 2 = 6$ $22.1 \times 23 = 508.3$ $1 \times 10.3 = 10.3$
Wood Deck	93.6 Sq ft	$8 \times 11.7 = 93.6$
Wood Deck	208.38 Sq ft	$15.1 \times 13.8 = 208.38$