

**MOORE COUNTY HEALTH DEPARTMENT
ENVIRONMENTAL HEALTH SECTION
OPERATION PERMIT**

(4) BR House

Owner: Onsite Homes LLC Address: 106 Scheeler / Lot 5358 7LW

Permit # 14544 Receipt # _____ LAK# 00027453

Installer: Chris Strickland Telephone: _____

Address: _____

System Type: Eze Flow Maximum Design Flow: 480 (gallons/day)

Wastewater Characteristics: domestic

Septic Tank Capacity: 1000 (Gallons) Tank I.D. # 11/1 STB 814 WT

Nitrification Line Dimensions: 170' x 3'

Effluent Distribution Device: serial Gravel Depth: _____

Depth To: Top of Tanks: 2" (Inches) Trench Bottom 20" (Inches)

Diagram of Actual Installation: (Depict Property Boundaries, Structures, Driveways, Trees, Water Lines, Water Supplies, Etc.)

Scale: _____ Inch = _____ Feet.

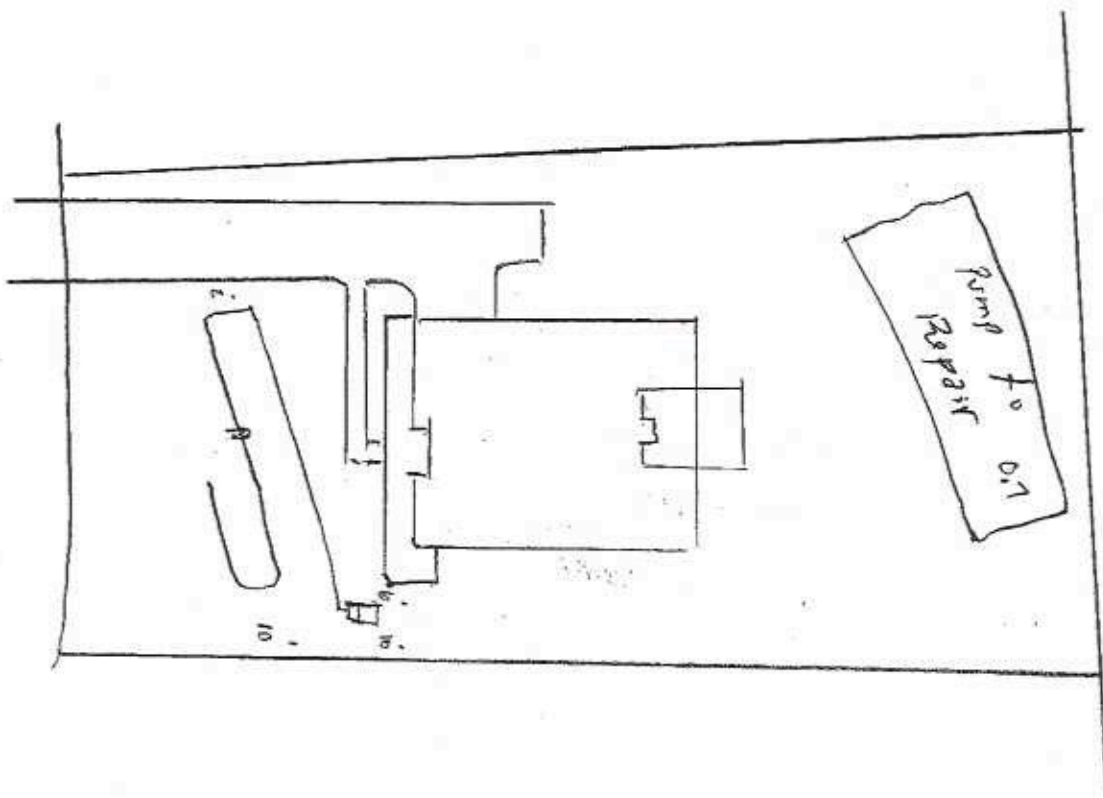

Comments and Conditions: _____

Issued By: Charles Riggs # of Attachments: 1
Date: 2/13/17

FINAL APPROVAL OF THIS SYSTEM SHALL INDICATE THAT THE SYSTEM HAS BEEN INSTALLED IN ACCORDANCE WITH APPLICABLE PERMIT CONDITIONS, LAWS AND RULES, BUT IN NO WAY SHOULD BE TAKEN AS A GUARANTEE THAT THE SYSTEM WILL FUNCTION SATISFACTORILY FOR ANY GIVEN TIME.