

Building Sketch

Borrower/Client	ROY F BUTLER				
Property Address	118 NW 8th St				
City	Oak Island	County	BRUNSWICK	State	NC Zip Code 28465
Lender	Armed Forces Bank				

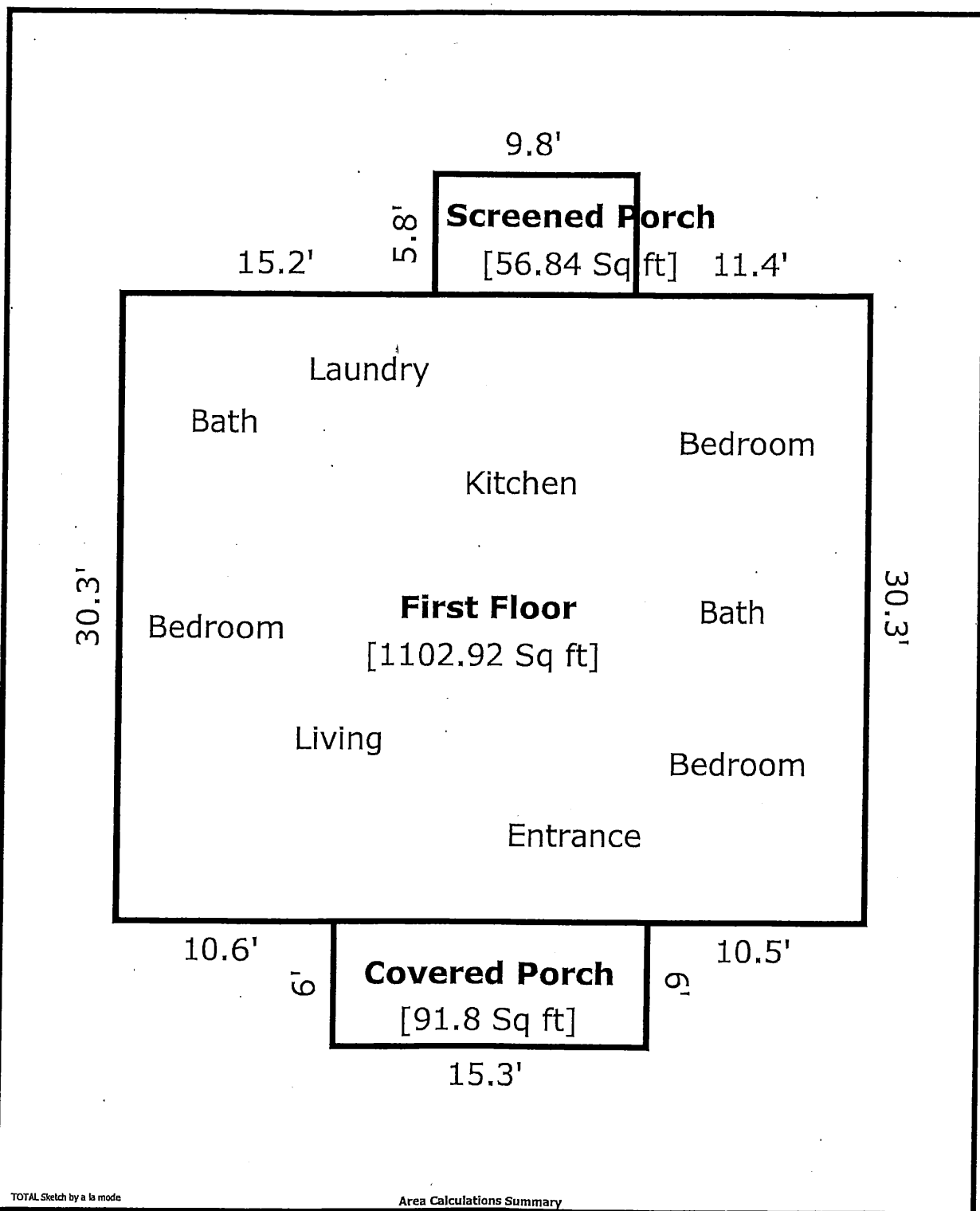

TOTAL Sketch by a la mode

Area Calculations Summary

Living Area	Calculation Details	
First Floor	1102.92 Sq ft	$36.4 \times 30.3 = 1102.92$
Total Living Area (Rounded):	1103 Sq ft	
Non-living Area:		
Screened Porch	56.84 Sq ft	$9.8 \times 5.8 = 56.84$
Covered Porch	91.8 Sq ft	$6 \times 15.3 = 91.8$