

**SAMPSON COUNTY HEALTH DEPARTMENT
ENVIRONMENTAL HEALTH SECTION
OPERATION PERMIT
EXISTING SYSTEM**

37319

Owner: HAZEL E. SMITH Address: 1353 TOMAHAWK HWY, HARRELLS
 Permit # _____ Receipt # 125304 LRK# _____
 Installer: SYKES Telephone: N/A
 Address: IVANHOE
 System Type: CONVENTIONAL Maximum Design Flow: 560 (gallons/day)
 Wastewater Characteristics: DOMESTIC
 Septic Tank Capacity: (2) 900 (Gallons) Tank I.D. # WARSAW
 Nitrification Line Dimensions: (3) 75' L X 3' W TRENCHES → 675 #
 Effluent Distribution Device: D-BOX Gravel Depth: 12"
 Depth to: Top of Tanks: 7-9 (Inches) Trench Bottom: ~30 (Inches)

Diagram of Actual Installation: (Depict Property Boundaries, Structures, Driveways, Trees, Water Lines, Water Supplies, Etc.)
 Scale: 1 Inch = 50 Feet.

* RELOCATING BATHROOMS
TO REAR OF BUILDING

* IN A RESTAURANT
SETTING, SYSTEM WILL
ONLY ACCOMODATE
14 SEATS
MAXIMUM.

* EXISTING SYSTEM
IS OK, ORIGINALLY
INSTALLED FOR
POTTER OIL Co.-GRILL
JULY 5, 1988

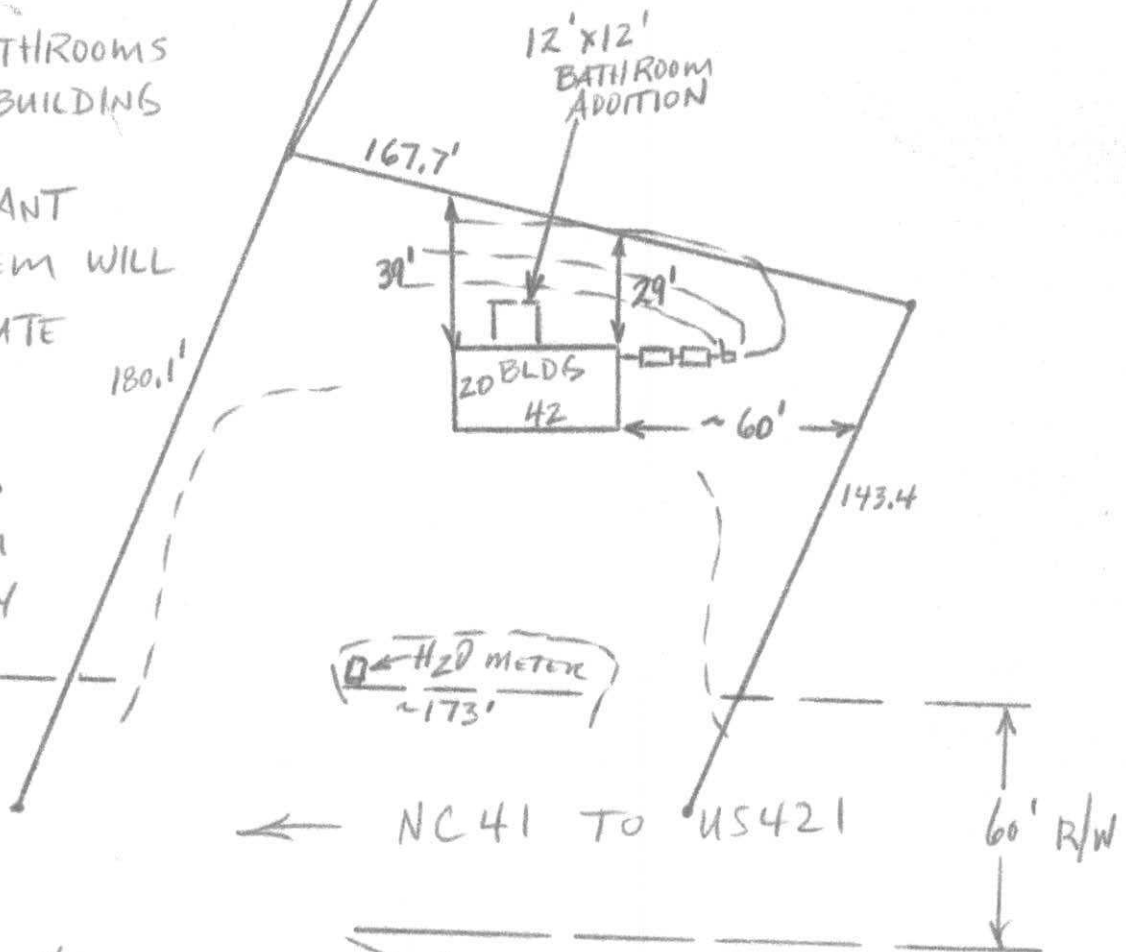

Comments and Conditions: _____
 Issued By: Oswald Newman, REHS # of Attachments: _____
 Date: 5-10-16

FINAL APPROVAL OF THIS SYSTEM SHALL INDICATE THAT THE SYSTEM HAS BEEN INSTALLED IN ACCORDANCE WITH APPLICABLE PERMIT CONDITIONS, LAWS AND RULES, BUT IN NO WAY SHOULD BE TAKEN AS A GUARANTEE THAT THE SYSTEM WILL FUNCTION SATISFACTORILY FOR ANY GIVEN TIME.