

INVOICE

FROM:
 Nina R Mecham, Licensed Appraiser
 514 Broad Street, Apt B8
 New Bern, NC 28560

Telephone Number: 252-675-3901 Fax Number: (870) 863-3263

INVOICE NUMBER	
DATES	
Invoice Date:	01/18/2025
Due Date:	01/18/2025
REFERENCE	
Internal Order #:	125 Neeley Ln
Lender Case #:	
Client File #:	
FHA/VA Case #:	
Main File # on form:	
Other File # on form:	
Federal Tax ID:	
Employer ID:	

TO:

Realty ONE Group East, Blanca Alster
 412 S Front St
 New Bern, NC 28562

E-Mail: blancaalster@yahoo.com
 Telephone Number: (714) 395-3131 Fax Number:
 Alternate Number:
 Professional Measuring Services

Zelle Payment to: 252-675-3901 (ninaroxanne@yahoo.com)
Venmo: @Nina-Mecham
Paypal Payment: paypal.me/NinaMecham

DESCRIPTION

Lender:	Client: Realty ONE Group East, Blanca Alster
Purchaser/Borrower:	
Property Address: 125 Neeley Ln	
City: New Bern	
County: Craven	State: NC Zip: 28560
Legal Description:	

FEES	AMOUNT
------	--------

Measuring & Sketching Services	75.00
Zelle Payment to: 252-675-3901 (ninaroxanne@yahoo.com) Venmo: @Nina-Mecham	
SUBTOTAL	75.00

PAYMENTS	AMOUNT
----------	--------

Check #: Date: Description:	
Check #: Date: Description:	
Check #: Date: Description:	
SUBTOTAL	0

TOTAL DUE	\$ 75.00
------------------	-----------------

Building Sketch

Borrower/Client					
Property Address		125 Neeley Ln			
City	New Bern	County	Craven	State	NC
Zip Code		28560			
Lender					

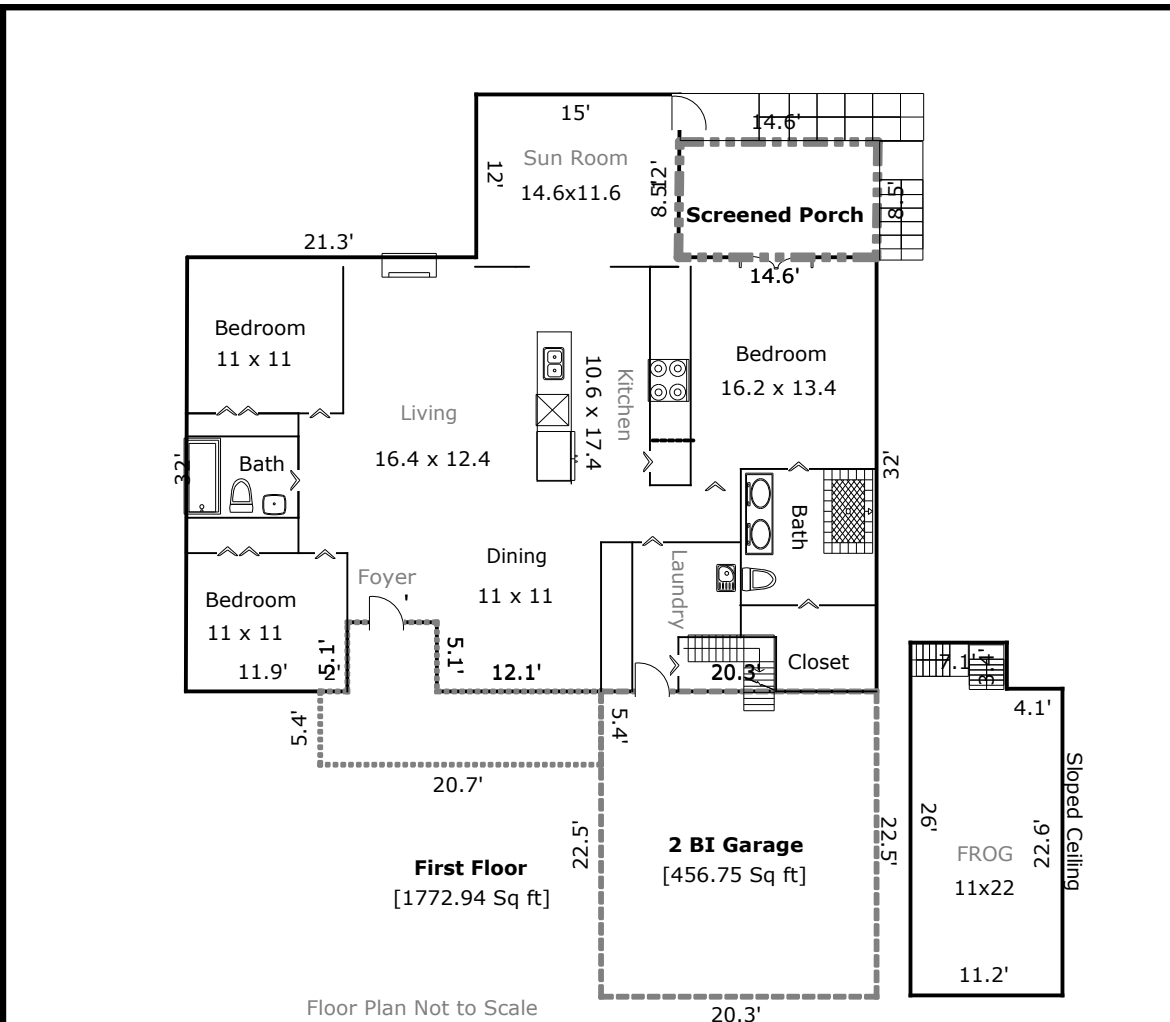

Sketch Provided by Nina Mecham Licensed Appraiser (252) 675-3901

Living Area		Calculation Details	
First Floor	1772.94 Sq ft	$0.5 \times 0.1 \times 12$	= 0.6
		14.9×12	= 178.8
		$0.5 \times 0.08 \times 26.9$	= 1.13
		50.8×26.9	= 1366.52
		5.1×32.4	= 165.24
		5.1×11.88	= 60.61
		$0.5 \times 5.1 \times 0.02$	= 0.04
Second Floor	277.26 Sq ft	11.2×22.6	= 253.12
		7.1×3.4	= 24.14
Total Living Area (Rounded):		2050 Sq ft	
Non-living Area			
2 BI Garage	456.75 Sq ft	22.5×20.3	= 456.75
Cov Porch	145.44 Sq ft	6.6×5.1	= 33.66
		5.4×20.7	= 111.78
Screened Porch	124.1 Sq ft	14.5×8.5	= 123.25
		$0.5 \times 0.1 \times 8.5$	= 0.42
		$0.5 \times 0.1 \times 8.5$	= 0.42