

**SYSTEM TYPE III
OPERATION PERMIT**

In accordance with the provisions of Article 11, Chapter 130-A of the General Statutes of North Carolina, an Operation Permit is issued on this date 28 May, 1999 to:

Owner Guyon Willis 90 Alan Rose Jr.
Mailing Address P.O. Box 567
City, State Harkers Island NC 28531
Business Phone _____ Home Phone 728-4719
Facility Location McKae Park Lot 32, Section 3 - Natilus Cove

Facility Description 1000 gallon septic tank
Three - 80 foot drain lines
12 Inch sand fill
6 Inch Topsoil cover

Design daily sewage flow 360 gpd based on three bedrooms
(beds, seats, people, etc.)

Engineer _____ Address _____

Contractor Ray Lawrence Address _____
Phone _____

Lessee or party responsible for operation, maintenance, and repair of this sewage system:
Name Guyon Willis Address same as above
Phone _____

* It is the responsibility that all previous owners of this system assure the subsequent owners receive this permit and abide by all requirements and conditions.
* If any ownership changes occur, then it is required for the new owner/operator to come into the Carteret County Health Department and update the permit information.

The routine maintenance requirements for this system are listed below:
Shape to shed surface water.
Establish and maintain a vegetative cover.

Maintenance and cleaning records shall be kept by the system owner and shall be available for review by the Carteret County Health Department during inspections of the system.

At such time that any part of the sewage treatment and disposal system falls into disrepair or the system is causing a health hazard, the owner/operator shall notify the Carteret County Health Department within forty-eight (48) hours and shall take immediate corrective action in the repair of the system as directed by the department.

Other conditions or requirements see Permit

Tri-Party Yes _____ No _____
HOA formed Yes _____ No _____
Easements deeded/recorded — Date _____

* Assure documents are copied and attached with this permit.
This Operation Permit shall be attached to and shall be subject to all criteria, conditions, and provisions of Improvements Permit # A2337
dated 21 Mar 97.

Page 2
SYSTEM TYPE III
OPERATION PERMIT

*This Operation Permit shall be valid as long as the sanitary sewage system is in compliance with Article 11 of G.S. Chapter 130A, Laws and Rules for Sanitary Sewage Collection, Treatment, and Disposal (15 NCAC 18A .1900), and all conditions of this permit, including the items specified below:

1. The sewage collection, treatment, and disposal system shall be operated and maintained at all times to prevent public health hazards, to prevent seepage or discharge of sewage or effluent to the surface of the ground or surface waters, and to prevent the direct discharge of effluent to the ground water.
2. If a grease trap is installed, it shall be inspected a minimum of 2 to 4 week intervals and pumped as needed, with records of maintenance and cleaning kept by the owner. The grease trap will be required to be pumped and cleaned more frequently during peak season or periods of high use.
3. This permit does not constitute a warranty and does not negate or supersede any zoning restriction or restricted covenants in the chain of title. It is the responsibility of the permittee to determine whether or not such restrictions apply.
4. A complete set of operation and maintenance manuals and up-to-date approved as-built plans for all equipment installed shall be maintained at the site served by this facility. The manuals will include recommendations to guide the owner/operator.
5. Each septic tank shall be inspected for sludge and scum build-up annually. Tanks shall be pumped when the sludge level exceeds a third of the liquid depth. The septic tank will be required to be pumped and cleaned more frequently during peak season or periods of high use.
6. This permit is transferable and is valid only with respect to the facilities described herein and the specified design flow. Prior to any expansions or revisions, a revised permit shall be obtained from the Carteret County Health Department.
7. **Ground Absorption System Maintenance** - A suitable cover shall be maintained on the nitrification field (drain field). Grassed areas shall be kept mowed, and wooded areas kept free of undergrowth. Clippings and other landscape debris shall be removed from the disposal area. No traffic or other equipment shall be allowed on the disposal fields, with the exception of mowing equipment. Vegetative cover shall be inspected prior to each growing season and repairs or reseeded accomplished sufficiently to assure that soil erosion will not occur in the area.
8. All associated drainage (surface and subsurface) shall be maintained. The drainage outlet shall also be properly maintained.
9. Maintenance records be kept on all maintenance of the septic system which include:
 - a. Inspection of sludge and scum grease levels
 - b. Hauler, date pumped, and disposal site
 - c. Replacement of mechanical components
 - d. Records of landscape maintenance and drainage
 - e. All other pertinent maintenance
10. No parking, paving, driving or structure shall be allowed on the disposal field with the exception of mowing equipment or equipment used for repairs.

*If all conditions of this permit are not met, then this permit is void.

The Carteret County Health Department reserves the right to make inspections of these sewage collection, treatment, and disposal facilities as necessary to assure compliance with the provisions of this Operations Permit and the North Carolina Laws and Rules for Sanitary Sewage Collection, Treatment, and Disposal.

Operations Permit Issued 28 May 19 99

BY Robert M. E. Gale, R.S.
Environmental Health Specialist

As the owner of the above sanitary sewage system, I agree to the conditions and requirements of this Operations Permit and will pass on to subsequent owners/operators.

Signed Mailed to Ray Lawrence 6/01/99 RB

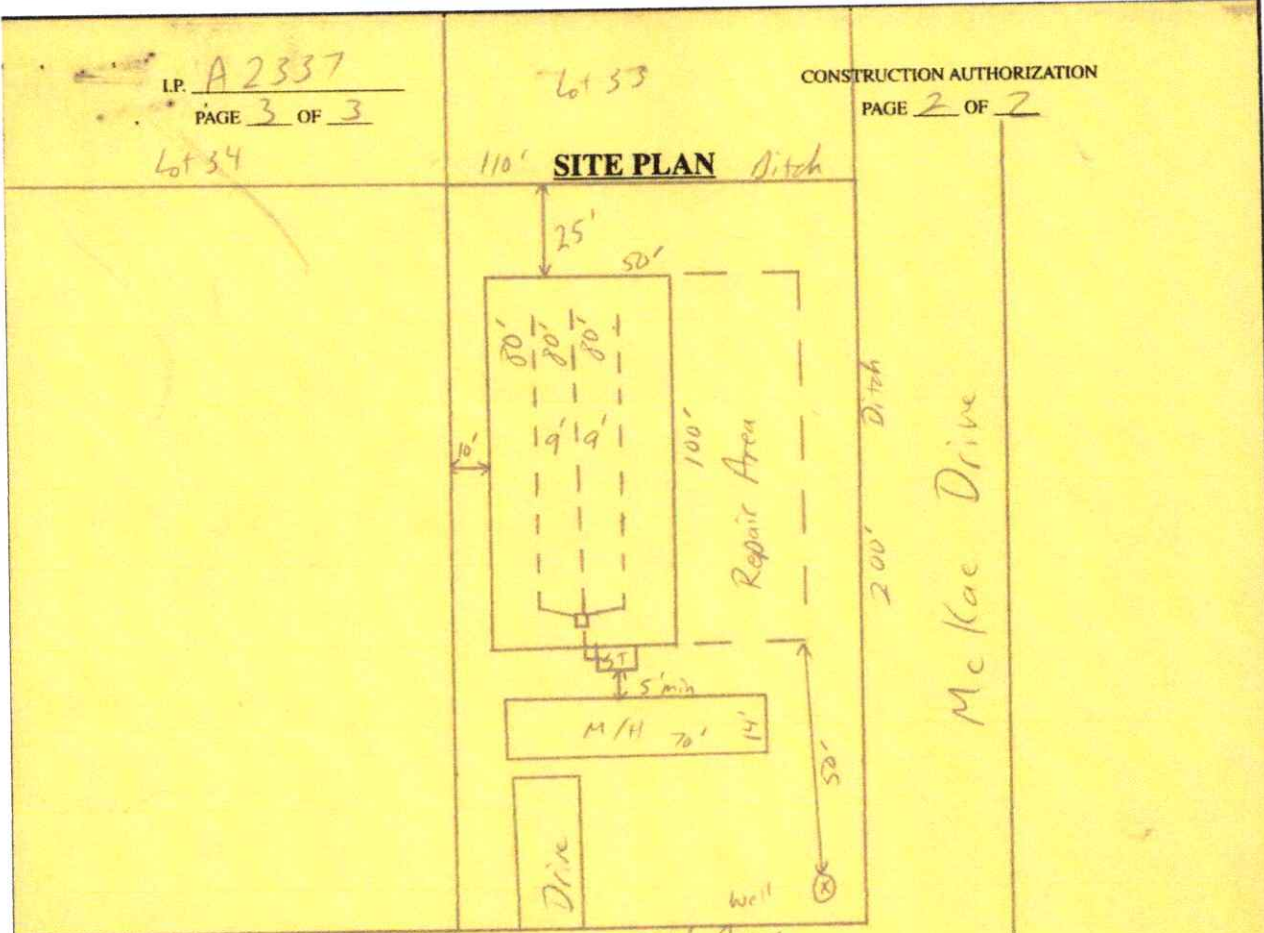

ELECTRICAL PERMIT REQUIRED: YES () NO ()

OWNER: Guyon Willis & Alan Rose Jr.
ADDRESS: P.O. Box 567 Harkers Island
28531 PHONE 228-9719
TAX PARCEL: 9-14E-1-14

PROPERTY LOCATION: Corner of McKae Drive
and Nicholas Court

SUBDIVISION: McKae Park
LOT: 32 BLOCK: _____ SEC: 3

TYPE STRUCTURE: M/H 14'x70'
NO. BEDROOMS: 3 NO. BATHS: 2
NO. PEOPLE: 56 DESIGN FLOW: 360

GARBAGE GRINDER: YES () NO ()
SEPTIC TANK: 1000 GAL. PUMP TANK: N/A GAL.

NO. LINES: 3-80' WIDTH: 3'
TOTAL LENGTH: 240 FT. TOTAL 720 SQ. FT.

WATER SOURCE: Well
HORIZONTAL DISTANCE FROM WELL: 50+ FT.

SITE MODIFIED: YES () NO ()
DRAINAGE REQUIREMENTS: _____

- STRUCTURE SHALL BE PLACED SO THAT GRAVITY FLOW IS ACHIEVED OR PUMP SYSTEM SHALL BE REQUIRED.
- DO NOT PARK, PAVE, DRIVE, OR BUILD OVER ANY PART OF SEPTIC SYSTEM OR REPAIR AREA.
- MAINTAIN A MINIMUM 5 FEET BETWEEN ANY FOUNDATION AND ANY PART OF SEPTIC SYSTEM OR REPAIR AREA.

***SYSTEM SHALL NOT BE INSTALLED UNDER WET CONDITIONS**

*Trench bottom depth to be no deeper than on the naturally occurring surface.

Easement Required: _____ Yes No
Drainage Maintenance Req. Surface () Subsurface ()
Maintain Minimum 10' From Water Line

Comments: Based on 1990 Test Well Data

*Prior to any changes in system layout, approval must be obtained from Health Department.

*NOTICE: Construction must comply with all state and local regulations. Do not install well until well site has been approved on inspection.

*NOTICE: Beware much property in Carteret County is subject to Wetland Regulations and properties containing wetlands should receive approval from U.S. Army Corp. of Engineers prior to development.

FOR SYSTEMS REQUIRING LESS THAN 18" TRENCH BOTTOMS, A MINIMUM OF 6" SOIL COVER IS REQUIRED AND MAY REQUIRE ADDITIONAL FILL OF AT LEAST GROUP II SANDY LOAM TEXTURE.

(OFFICE USE FOR FIELD NOTES ONLY)

MODIFICATION INSPECTION BY: _____ ENVIRONMENTAL HEALTH SPECIALIST

DATE: _____
INSTALLER: _____
COMMENTS: _____