

Boring Map for Belvoir Farms 1347 Roosevelt Spain, Parcel 91836, Lot 12

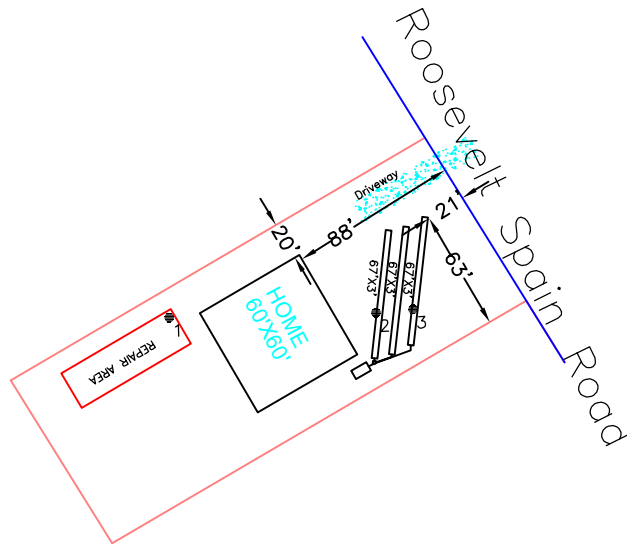

LEGEND—

- — Boring Location

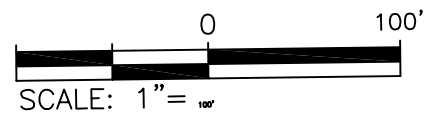

Aston Soil Works, Inc.
2858 Madison Grove
Greenville, NC 27858

Wastewater System Map for Belvoir Farms 1347 Roosevelt Spain, Parcel 91836, Lot 12

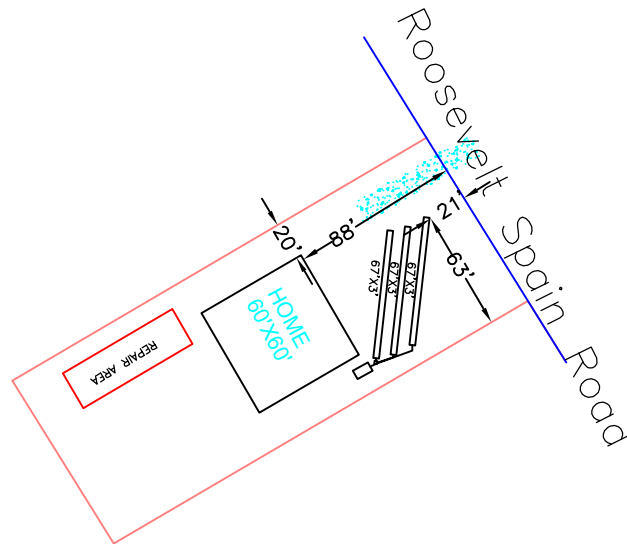

Primary System

Type: Accepted system with 25% reduction
Design Flow: 480 GPD(4 Bedroom)
Long Term Acceptance Rate: .8 GPD/SQ FT
Linear Feet of Drainfield: 150
Installation Depth: 18"
Septic Tank Volume(S.T): 1000 Gallons

Repair System

Same as Primary

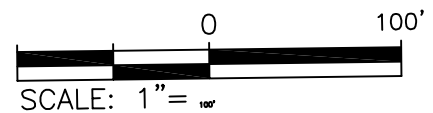

Repair System
same as primary

Aston Soil Works, Inc.
2858 Madison Grove
Greenville, NC 27858

APPLICATION: _____

PROFILE #	.0502 LANDSCAPE POSITION & SLOPE %	HORIZON DEPTH (IN.)	SOIL MORPHOLOGY (.0503)			COLOR (.0504)		OTHER PROFILE FACTORS
			TEXTURE	STRUCTURE	CONSISTENCE MINEROLOGY	MATRIX	MOTTLE	
								SOIL WETNESS (.0504) -
								SOIL DEPTH (.0505) -
								RESTR HORIZ (.0507) -
								PROF CLASS (.0509) -
								PROFILE LTAR -
								SOIL WETNESS (.0504) -
								SOIL DEPTH (.0505) -
								RESTR HORIZ (.0507) -
								PROF CLASS (.0509) -
								PROFILE LTAR -
								SOIL WETNESS (.0504) -
								SOIL DEPTH (.0505) -
								RESTR HORIZ (.0507) -
								PROF CLASS (.0509) -
								PROFILE LTAR -
								SOIL WETNESS (.0504) -
								SOIL DEPTH (.0505) -
								RESTR HORIZ (.0507) -
								PROF CLASS (.0509) -
								PROFILE LTAR -
								SOIL WETNESS (.0504) -
								SOIL DEPTH (.0505) -
								RESTR HORIZ (.0507) -
								PROF CLASS (.0509) -
								PROFILE LTAR -

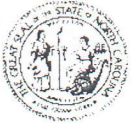

POP2025-000037

North Carolina Onsite Wastewater Contractor Inspector Certification Board
Authorized Onsite Wastewater Evaluator Permit Option for Non-Engineered Systems
Notice of Intent (NOI) to Construct

X New Expansion Repair Relocation Relocation of Repair Area

Owner or Legal Representative Information:
Name: Belvoir Farms of Pitt Co LLC
Mailing address: PO Box 1844, Washington, NC, Zip: 27889
Phone: (252)-714-0433 Email: Wblount@gmail.com

Authorized Onsite Wastewater Evaluator Information:
Name: Gene Aston Certification #: 10011E
Mailing address: P O Box 86, Simpson, NC, Zip: 27879
Phone: 252 341 9707 Email: astonsoil@gmail.com

Site Location Information:
Site address: Roosevelt Spain Road
Tax parcel identification number or subdivision lot, block number of property: 91836
Carraway Farms Lot 12 County: Pitt

System Information:
Wastewater System Type: III-B
Daily Design Flow: 480
Saprolite System: Yes X No Subsurface Operator Required: Yes X No
Water Supply Type: Private Well X Public Water Supply Spring Other:

Facility Type:
X Residential 4 # Bedrooms 8 Maximum # of Occupants
Business Type of Business and Basis for Flow:
Public Assembly Type of Public Assembly and Basis for Flow:

Required Attachments:
X Plat or Site Plan
X Evaluation of Soil and Site Features by Licensed Soil Scientist

Attest: On this the 6 day of May, 2025 by signature below I hereby attest that the information required to be included with this NOI to Construct is accurate and complete to the best of my knowledge. Furthermore, I hereby attest that I have adhered to the laws and rules governing onsite wastewater systems in the state of North Carolina.
This NOI shall expire on 11 day of February, 2035.
Signature of Authorized Onsite Wastewater Evaluator: Gene Aston
Signature of Owner or Legal Representative: [Signature]

Disclosure: The owner may apply for a building permit for the project upon submitting a complete NOI to Construct and the fee required (if any) to the local health department. An onsite wastewater system authorized by an authorized onsite wastewater evaluator shall be transferable to a new owner with the consent of the authorized onsite wastewater evaluator.

Local Health Department Receipt Acknowledgement:
Signature of Local Health Department Representative: William Wade, REHS Date: 6-5-2025

Aston Soil Works, Inc.
P.O. Box 86
Simpson, NC 27879

5/13/2025

Belvoir Farms of Pitt Co LLC
Po Box 1844
Washington, NC 27889

Re: Soil/Site Evaluation for single family wastewater approval (G.S. 130A-336.2)
property located at Carraway Farms lot 12 in **Pitt** County, NC. (parcel **91836**)

Belvoir Farms,

The referenced property was evaluated for septic system suitability using the *18E Onsite Wastewater Rules* as a reference. As requested, an investigation of this property was performed to locate soil areas suitable for a four-bedroom septic system that would allow placement of conventional drain lines. **The LSS evaluation is being submitted pursuant to and meets the requirements of G.S. 130A-336.2.** The evaluation involved methodically conducting hand auger borings across the property to determine suitability for septic systems. Each boring was located by using a global positioning system (GPS) capable of sub-meter accuracy. The enclosed map identifies primary and repair septic system field areas based on soil findings. An auger boring location map and soil profile descriptions are also included with this this report.

The primary drain field area has sandy loam textured sub-soils and morphology suggests the seasonal soil wetness condition to be **24** inches below the surface. These areas should allow shallow placement of the drain lines, which places the bottom of the drain lines a maximum of **12** inches below the surface. This depth is recommended based on elevation change recorded with a laser level and minimum depths to soil wetness. The imported fill and the area around the drain field will must be shaped to remove surface water. The recommended LTAR for septic systems in this area is **0.8** gallons/day/ft².

The repair drain field area has sandy loam textured sub-soils and morphology suggests the seasonal soil wetness condition to be **36+** below the surface. These areas should allow shallow placement of the drain lines, which places the bottom of the drain lines a maximum of **24 inches** below the surface. This depth is recommended based on elevation change recorded with a laser level and minimum depths to soil wetness. This area should allow shallow placement of the drain lines. The recommended LTAR for a septic system in this area is **0.8** gallons/day/ft².

Any disturbance in the form of filling or excavation can alter the suitability class of the soil group. This report is for information and planning purposes only. The local health department must process and file these private permits for septic systems. This property may be subject to approval by other local, state, or federal agencies. If you have any further questions, please contact me at (252) 341-9707.

Sincerely,

Gene Aston

Gene Aston

Licensed Soil Scientist # 1261

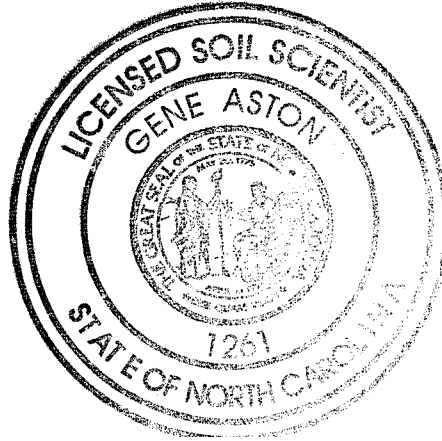

AGENCY CUSTOMER ID: _____

LOC #: _____



ADDITIONAL REMARKS SCHEDULE

AGENCY Walters & Associates		NAMED INSURED Aston Soil Works Inc 2858 Madison Grove Road Greenville NC 27858	
POLICY NUMBER M71868253AEM		EFFECTIVE DATE: ?	
CARRIER StarStone Specialty Insurance Company	NAIC CODE 4776		

ADDITIONAL REMARKS

THIS ADDITIONAL REMARKS FORM IS A SCHEDULE TO ACORD FORM,
 FORM NUMBER: 25 FORM TITLE: Certificate of Liability Insurance

Septic System Contractor

Professional Liability:
 \$1,000,000 Each Wrongful Act
 \$2,000,000 Aggregate
 \$5,000 Deductible Each Wrongful Act
 Professional Liability is Claims Made.
 Retroactive Date: 03/09/2018 / 03/09/2018 - Mold

Transportation Pollution Liability:
 \$1,000,000 Each Pollution Event
 \$2,000,000 Aggregate
 \$5,000 Deductible Each Pollution Event

General Policy Aggregate: \$2,000,000