



ALBEMARLE REGIONAL HEALTH SERVICES
Partners in Public Health

Camden

Permit: 234002

PIN:

Owner:
EPPERLY, BENJAMIN
118 KEETER BARN ROAD
SOUTH MILLS, NC 27976

Applicant:
EPPERLY, BENJAMIN
118 KEETER BARN ROAD
SOUTH MILLS, NC 27976

LTAR: 0.200
Water: ~~EXISTING~~ WELL
TYPE III G.
SINGLE FAMILY
GPD: 360

Location:
OLD SWAMP ROAD

SEPTIC TANK MUST BE HIGH ENOUGH
SO THAT TRENCH BOTTOM IS NO
DEEPER THAN 12 INCHES BELOW TOP
OF FILL. 2 FT OF FILL IS REQUIRED.
TOP OF TANK SHOULD BE ABOUT 30"
ABOVE EXISTING GRADE!

*FILL MOUND MUST BE
60 FT BY 120 FT BY 24"*

EXCAVATE 6 LINES 100 FT
LONG, 9 FT ON CENTER TO A
DEPTH OF 5 FT BELOW ORIGINAL
GRADE, BACKFILL WITH 6 FT OF
COARSE SAND AND INSTALL 12"
OF TRENCH MATERIAL.

KEEP ALL PARTS OF SEPTIC
SYSTEM AT LEAST 50 FT
FROM POND AT 589 OLD SWAMP ROAD

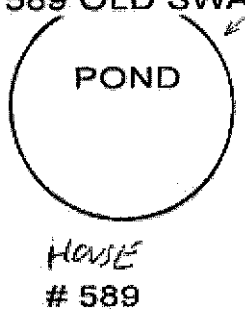
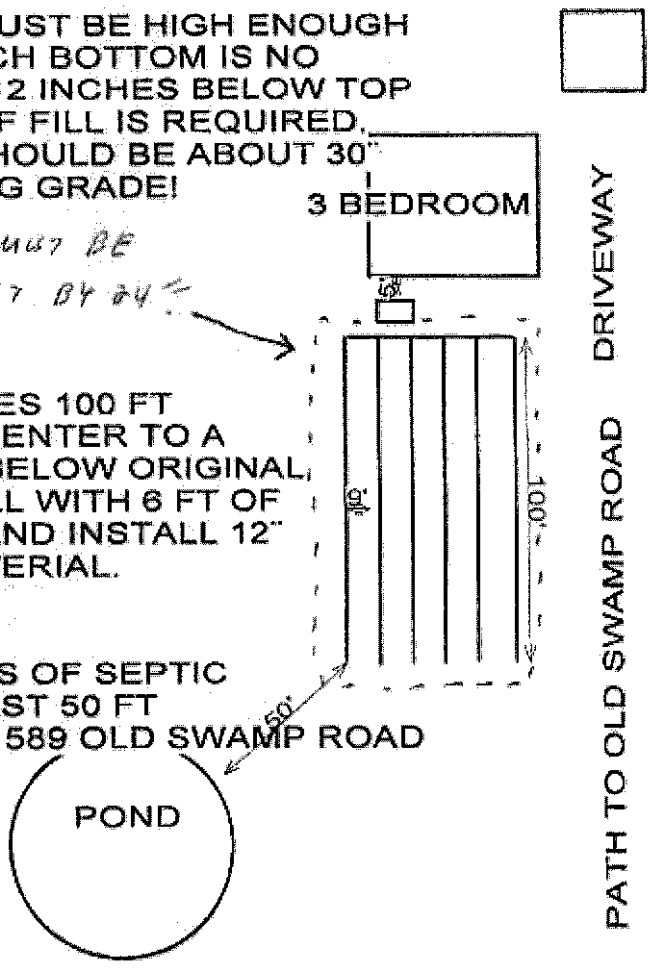

Authorized Agent:

[Signature] RBUS 1911
Swinney, David

Date: 02/22/2017

Approved:

[Signature] RBUS 1911

Date: 9/13/17

*House
583*

ALBEMARLE REGIONAL HEALTH SERVICES
Final Inspection

Name: EPPERLY, BENJAMIN

Permit #: 234002

System Installer: Giles Russell

Manufacturer: NRM-1000/STB-830

Septic Tank Serial: 830

Gallons: 1,000

Drain Field Type: UNKNOWN *LITTLE GRANT*

Distribution Type: GRAVITY - PARALLEL (eq. d-box) *511322*

Number of Nitrification Lines: 6 *105N-C2M*

Total Trench Length: 600 *110 VOL7*

Comments:

GARAGE

NOT TO SCALE!

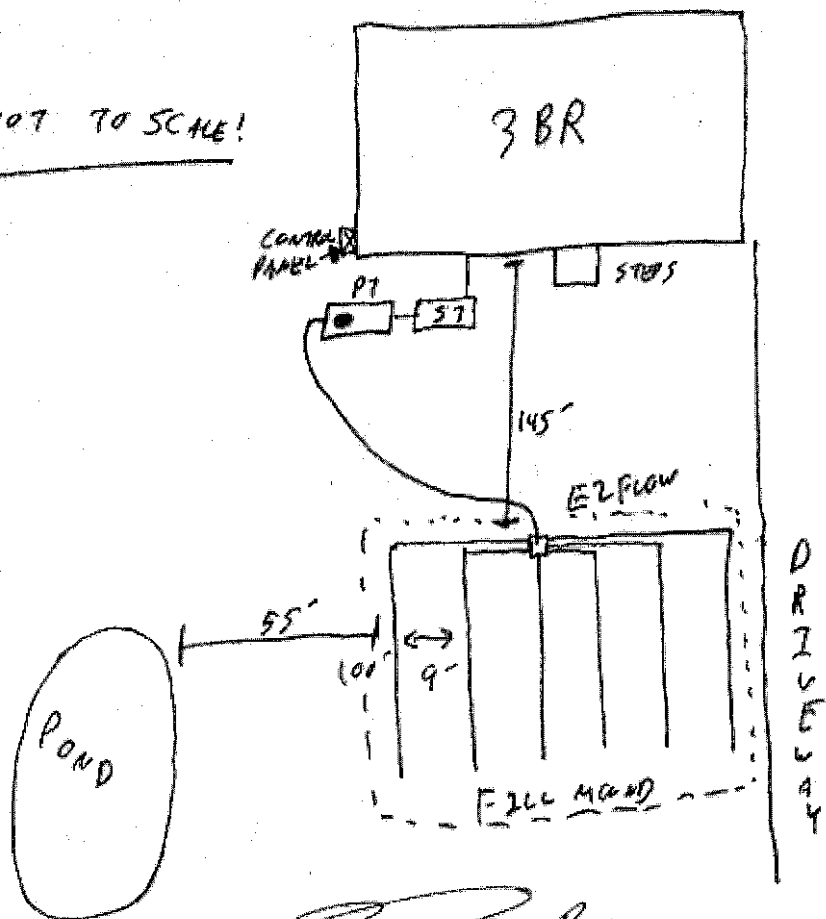

EHS: *[Signature]* *RGRS 1911*

Date: 09/13/2017

Swinney, David