

# SKETCH/AREA TABLE ADDENDUM

## SUBJECT INFO

File No.: Parcel No.:  
 Property Address: 1501 Meridian Terrace  
 City: Wilmington County: New Hanover State: NC ZipCode: 28411  
 Owner:  
 Client: Alyssa Bleau Client Address:  
 Verifier Name: Paul Hayden - Size Matters Inspection Date: 06/05/2025

## SKETCH

### 1501 Meridian Terrace, Wilmington NC

**3,062 SF**

June 5, 2025

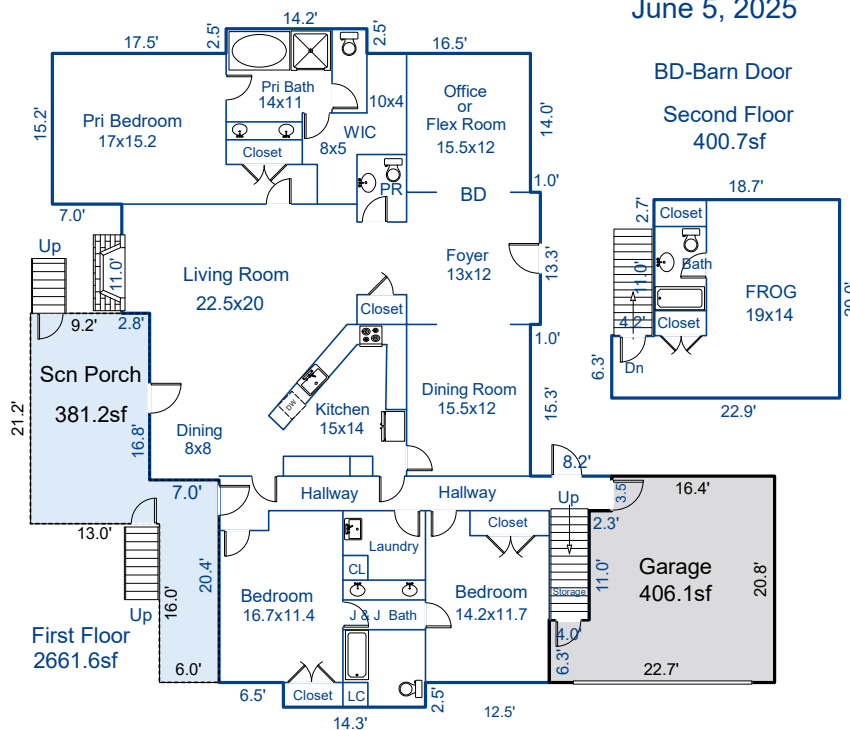

Disclosure: Interior walls and room sizes are approximate

Floor Plan by Size Matters 910-797-0439

NC Real Estate License 249188

Sketch by ApexSketch

#### AREA CALCULATIONS SUMMARY

Code	Description	Factor	Net Size	Perimeter	Net Totals
GLA1	First Floor	1.0	2661.6	251.6	2661.6
GLA2	Second Floor	1.0	400.7	85.9	400.7
GAR	Garage	1.0	406.1	87.0	406.1
P/P	Scn Porch	1.0	381.2	112.4	381.2

#### AREA CALCULATIONS BREAKDOWN

Name	Base x	Height x	Width =	Area
First Floor		13.3 x	1.0 =	13.3
		14.2 x	2.5 =	35.5
		14.3 x	2.5 =	35.8
		41.2 x	26.2 =	1079.4
		15.2 x	7.0 =	106.4
		38.4 x	16.8 =	645.1
		8.2 x	0.4 =	3.3
Second Floor		37.3 x	14.1 =	525.9
		3.1 x	2.3 =	7.1
		33.3 x	6.3 =	209.8
		18.7 x	17.3 =	323.5
		18.7 x	2.7 =	50.5
		6.3 x	4.2 =	26.7

Net LIVABLE cnt 2 (rounded) 3,062

13 total items (rounded) 3,062

# SKETCH/AREA TABLE ADDENDUM

## SUBJECT INFO

File No.: Parcel No.:  
Property Address: 1501 Meridian Terrace  
City: Wilmington County: New Hanover State: NC ZipCode: 28411  
Owner:  
Client: Alyssa Bleau Client Address:  
Verifier Name: Paul Hayden - Size Matters Inspection Date: 06/05/2025

## SKETCH

### First Floor (GLA1)

13.30	x	1.00	=	13.30
14.20	x	2.50	=	35.50
14.30	x	2.50	=	35.75
41.20	x	26.20	=	1079.44
15.20	x	7.00	=	106.40
38.40	x	16.80	=	645.12
8.20	x	0.40	=	3.28
37.30	x	14.10	=	525.93
3.10	x	2.30	=	7.13
33.30	x	6.30	=	209.79
Total area:				2661.64

### Garage (GAR)

18.70	x	17.30	=	323.51
6.30	x	4.00	=	25.20
16.40	x	3.50	=	57.40
Total area:				406.11

### Scn Porch (P/P)

21.20	x	2.80	=	59.36
21.20	x	9.20	=	195.04
20.40	x	6.00	=	122.40
4.40	x	1.00	=	4.40
Total area:				381.20

### Second Floor (GLA2)

18.70	x	17.30	=	323.51
18.70	x	2.70	=	50.49
6.30	x	4.24	=	26.71
Total area:				400.71