

I, MARC F. GLENN, CERTIFY THAT THIS PROPERTY WAS SURVEYED AND MAP DRAWN UNDER MY SUPERVISION: DESCRIPTION AS SHOWN ON THE FACE OF THIS PLAT; RATIO OF PRECISION AS CALCULATED BY COMPUTER IS 1:20,000+; THAT THE BOUNDARIES NOT SURVEYED ARE SHOWN BY BROKEN LINES PLOTTED FROM INFORMATION REFERENCED; THAT THIS PLAT WAS PREPARED IN ACCORDANCE WITH "THE STANDARDS OF PRACTICE FOR LAND SURVEYING IN NORTH CAROLINA"; WITNESS MY ORIGINAL SIGNATURE, LICENSURE NUMBER AND SEAL THIS 6TH DAY OF SEPTEMBER A.D. 2018.

Marc F. Glenn

MARC F. GLENN
N.C. PLS No. L-4308

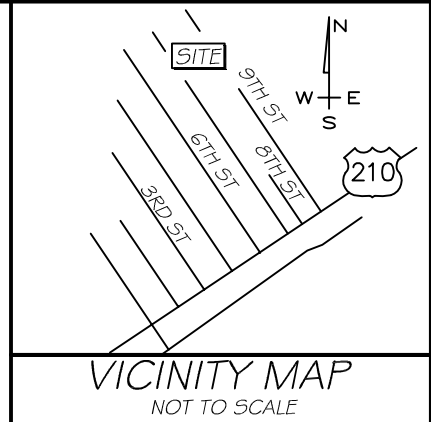
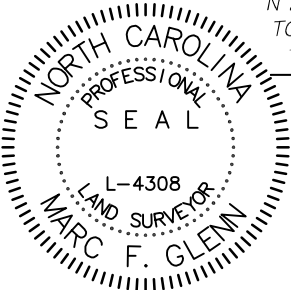

N 28°45'00" W 595.00'
TO CULDESAC TERMINUS

9th Street West
60' PUBLIC RIGHT OF WAY

EDGE OF PAVEMENT

TBM SET- RAILROAD SPIKE IN
POWER POLE
ELEVATION 4.36' (NAVD 88)

N 61°15'00" E 30.00' TIE
VINYL FENCE ON LINE
LIGHT POLE
MB 11 PG 3

1,874 sq.ft.
0.04 acres

2,432 sq.ft.
0.06 acres

LOT 60
OLD SETTLERS BEACH
SECTION 4
MAP BOOK 11
PAGE 3

LOT AREA
11,030 sq.ft.
0.25 acres

5/8" REBAR SET
CANOPY WITH CONCRETE
PAD ENCROACHING

N 33°10'21" W 10.51'

CANAL



10.2'
N 58°22'43" E 3.72'

N 29°44'44" W 44.34'

8.5'
5 61°15'00" W 200.72' TOTAL
200.06' PIPE TO REBAR
0.66' REBAR TO NHWL

PROPOSED IMPERVIOUS SURFACE AREA

HOUSE AND DECKS..... 2,432 SQ. FT.
CONCRETE DRIVE..... 1,874 SQ. FT.
TOTAL SQUARE FOOTAGE.... 4,306 SQ. FT.

LOT AREA 11,030 SQ.FT.
4,306/11,030= 39.04%

*ALL OF DRIVEWAY UP TO EDGE OF PAVEMENT INCLUDED.
*ALL OF HOUSE AND DECKING INCLUDED.
*NO STEPS INCLUDED.

SEPTEMBER 6, 2018

SITE PLAN FOR
Haywood Quinn

SURVEY REFERENCE
DEED BOOK 474 PAGE 638
MAP BOOK 11 PAGE 3

#9091 West 9th Street

LOT 59 SECTION 4 OLD SETTLERS BEACH
STUMP SOUND TOWNSHIP ONSLOW COUNTY NORTH CAROLINA
TOWN OF SURF CITY

Section 4_Block 29_Lot 59_9091 West 9th Street.dwg

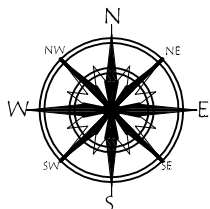

POLARIS
SURVEYING, PLLC
202 EAST BEDFORD ROAD
WILMINGTON, NC 28411
PH (910)-616-4210
FAX (910)319-7325 FIRM LIC# 0756

LEGEND

- = EXISTING PIPE OR REBAR
- = 5/8" REBARS SET
- NHWL = NORMAL HIGH WATER LINE
- ⊕ = CENTERLINE
- RAW = RIGHT OF WAY
- X 3.1' = SPOT ELEVATION
- AREA BY COORDINATE METHOD USING NORMAL HIGH WATER

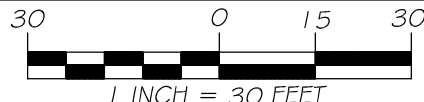

NOTE: THIS LOT IS LOCATED
IN ZONE VE 13
FIRM COMMUNITY PANEL
37204245 L PRELIMINARY
DATED: 6/30/2016