

ONSLOW COUNTY HEALTH DEPT.

OPERATIONS PERMIT

(GS 130A-337)

Permit No.: 12699

Systems Type: IIIg

930 A.T.

Owner: Oakhurst River Estates

Address: Lot 44

Location: End of Riverbend Rd

Sr#: _____

THIS DOES NOT CONSTITUTE A WARRANTY OR GUARANTEE.

Installed By: Roy Heath

Signed By: [Signature]

Date: July 1, 2004

FINAL PLOT / REMARKS

3 Bedroom residence / ≤ 360gpd

ONSLOW COUNTY HEALTH DEPT.

CONSTRUCTION AUTHORIZATION

(GS 130A-336)

THIS AUTHORIZATION FOR WASTEWATER SYSTEM CONSTRUCTION SHALL BE VALID FOR A PERIOD EQUAL TO THE PERIOD OF VALIDITY OF THE IMPROVEMENT PERMIT. NOT TO EXCEED 5 YEARS.

Permit No.: 12699

System type IIIg

Owner: Oakhurst River Estates

Address: Lot 44

Location: End of Riverbend Rd

Sr#: _____

System Type/Description: Polystyrene aggregate - 25% reduction LTAR: .5 gpd/sq. ft.

Septic Tank Size: ≥ 900 gallons

Nitrification Area: 540 sq. ft. 180 lin. ft.

No. of lines: 3 Line length 60' x 3'

Trench bottom depth: 18" - 24"

(SEE ATTACHED PAGES 1 - 1 of 1 FOR ADDITIONAL PERMIT CONDITIONS)

Signed: Jason D. R.D.

Date: 10-10-03

ONSLOW COUNTY HEALTH DEPT.

IMPROVEMENT PERMIT

(GS 130A-336)

- Valid for 5 years from date of issuance.
Valid without expiration.

Permit No.: 12699

System type IIIg

Owner: Oakhurst River Estates

Address: Lot 44

Location: End of Riverbend Rd

Sr#: _____

System Type/Description: Polystyrene aggregate - 25% reduction LTAR: .5 gpd/sq. ft.

Facility/Daily design flow: 3 Bedroom residence / ≤ 360gpd

Water supply: On-site well Comm. well Public X Other

(SEE ATTACHED PAGES 1 - 1 of 1 FOR ADDITIONAL PERMIT CONDITIONS)

Signed: Jason D. R.D.

Date: 10-02-03

NOTE: Permit is subject to revocation if site plans or intended use change.

Buff Ledger: ORIGINAL

Blue: BUILDING INSPECTION

Pink: CLIENT

PLOT PLAN

Additional Permit Conditions:

Owner: Oakhurst River Estates
 Address: Lot 44
 Location: _____

1. Do not park or drive on any part of system or repair area:
2. Nitrification trench aggregate shall be covered with straw, untreated paper or other approved materials prior to final cover/backfilling.
3. Do not install system under wet conditions.
4. Adhere to minimum set back requirements as stated in Rule .1950 and .1951 of NC Laws and Rules for Sewage Treatment and Disposal System. (Article 11, G.S. Chapter 130A). Unless otherwise indicated in this permit.
5. Rock used in soil absorption systems shall be clean, washed gravel or crushed stone and graded or size in accordance with size numbers 3,4,5,57, or 6 of ASTM D-448 (standard sizes of coarse aggregate) which is hereby adopted by reference in accordance with G.S. 150 B-14 (c). Documentation of aggregate size shall be available upon request.
6. All pump tanks shall be tested for water tightness. Septic tanks may be subject to a water tightness test.
7. The septic tank is designed to receive sewage or wastewater under gravity flow. However, if a system subject to the N.C. Plumbing Code is used to pump raw sewage to the septic tank the sewage shall be reduce to gravity/non-turbulent flow by approved means at the inlet of the septic tank.

- Polystyrene aggregate system 25% reduction
- 3-60' trenches 18"-24" in depth
- Run trenches parallel to contour
- System flagged in field by OCHD

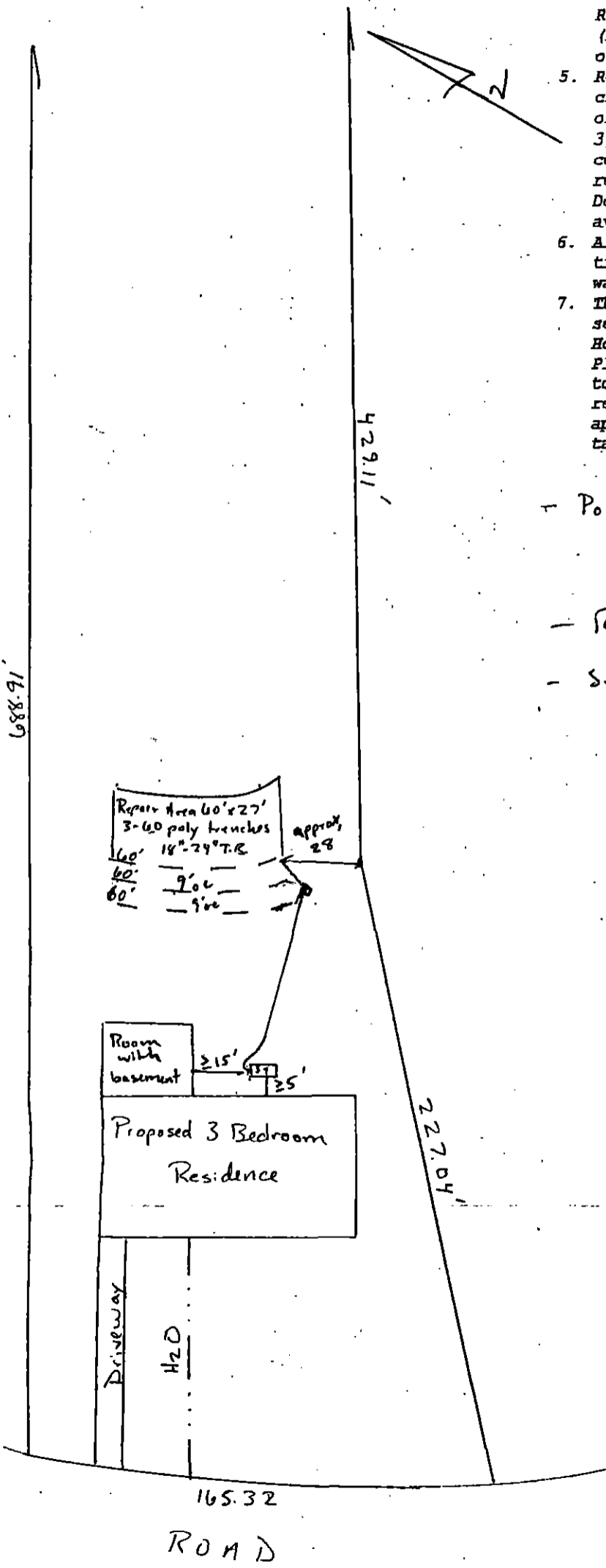

SCALE - 1" = 50'