

BRUNSWICK COUNTY HEALTH DEPARTMENT

TYPE: HC
FILE NO. 95 / 42736
95006576

DATE REC.: 9-5-95
ROYAL MARY (AGENT)

P.I.N.:

50 00 18400071

TAX PARCEL

REC. FROM

AMT. PD.

3458 HOLDEN BEACH RD SW
ADDRESS

SUPPLY

CITY

NC
ST

28462
ZIP

910842-6415
PHONE

PARKER JOHN F SR & JOHN JR
CURRENT PROPERTY OWNER

/ EDGARWOOD

SUBDIVISION

/ 71 /
LOT

/ /
BLK

/ 2
SEC

PROPERTY LOCATED. TOWN/CITY/AREA/

SUPPLY

DIRECTIONS TO PROPERTY:

1156 WILMA AVE SW

1156 WILMA AVE SW; STONE CHIMNEY RD

AUTHORIZATION FOR WASTEWATER CONSTRUCTION

PERMIT IS SUBJECT TO REVOCATION IF SITE PLANS OR THE INTENDED USE CHANGE.

NEW EXISTING SYSTEM _____ REPAIR _____ RENEWAL _____

All the conditions specified on the IMPROVEMENT PERMIT must be met.

Size of tank: 900 No. Lines: 3 Length ea. 50 FT
Site classification: _____ Suitable Provisionally Suitable _____ Unsuitable

Fill check: _____ by: _____
date

ISSUE DATE: 10-30-95 (Valid for 60 months from date of Issuance/Pre-Construction Conference is required prior to renewal.)

Permit not valid unless signed by Authorized Agent: Clay Holden
Signature

Operation Permit: Installed by _____ Date: _____ Tank Info: _____

Approved by: _____ Comments: _____

Final approval of a septic tank system shall indicate the system has been constructed according to the standards set forth in the sewage disposal regulations but shall in no way be taken as a guarantee that the system will function satisfactory for any given period of time.

CH

0515 DEEL Printed 10-11-95 16:43

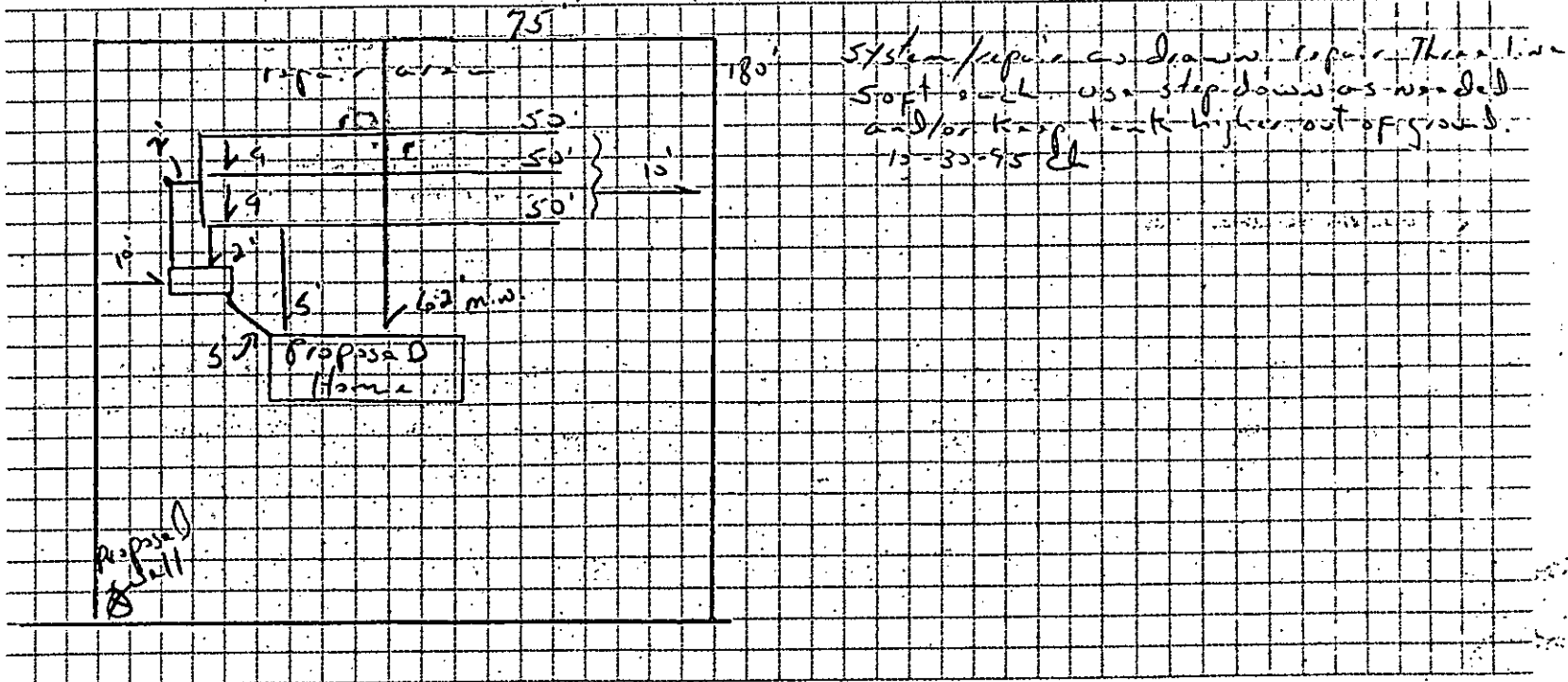

(NOT TO SCALE)