

Building Sketch

Borrower/Client				
Property Address 13271 US Highway 17				
City	Hampstead	County	State	NC Zip Code 28443
Lender				

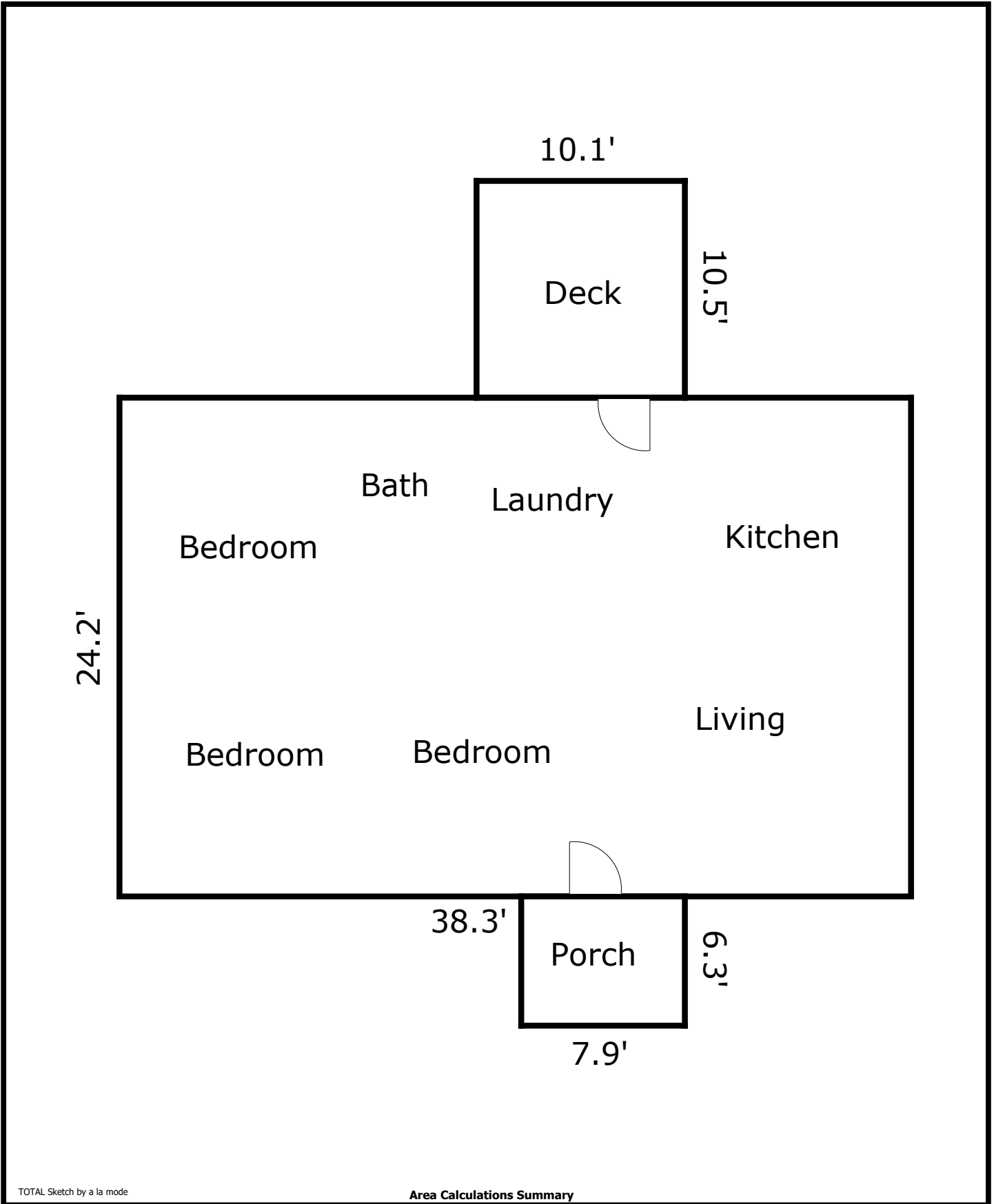

TOTAL Sketch by a la mode

Area Calculations Summary

Living Area	Calculation Details	
First Floor	925.8 Sq ft	$38.3 \times 24.2 = 925.8$
Total Living Area (Rounded):	926 Sq ft	
Non-living Area		
Wood Deck	106 Sq ft	$10.1 \times 10.5 = 106$
Open Porch	49.6 Sq ft	$7.9 \times 6.3 = 49.6$