



Sketch of Real Property

LOCATED AT:

807 Walker Ave
Metes & Bounds as described in legal description in DB:920, PG:623
Elizabeth City, NC 27909

FOR:

Christina Rountree & Assigns

AS OF:

02/25/2025

BY:

Kim Jarvis

Building Sketch

Borrower				
Property Address	807 Walker Ave			
City	Elizabeth City	County	Pasquotank	State NC Zip Code 27909
Lender/Client	Christina Rountree & Assigns			

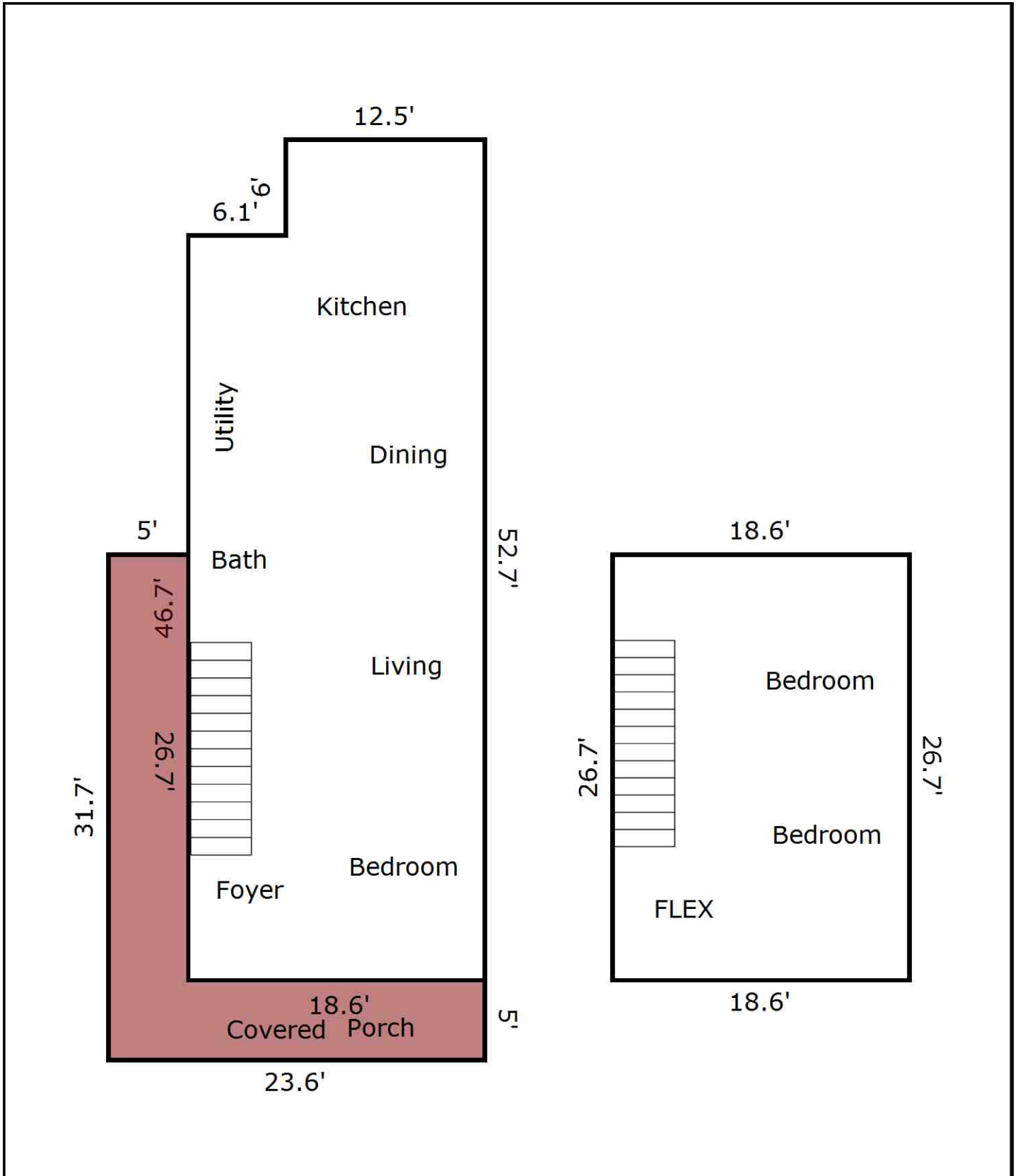

TOTAL Sketch by a la mode

Area Calculations Summary

Living Area	Calculation Details	
First Floor	943.62 Sq ft	12.5 × 6 = 75 18.6 × 46.7 = 868.62
Second Floor	496.62 Sq ft	26.7 × 18.6 = 496.62
Total Living Area (Rounded):	1440 Sq ft	
Non-living Area		
Covered Porch	251.5 Sq ft	5 × 18.6 = 93 5 × 31.7 = 158.5