

SKETCH/AREA TABLE ADDENDUM

SUBJECT INFO

File No.: Parcel No.:
 Property Address: 5011 Marathon Landing Ct
 City: Castle Hayne County: New Hanover State: NC ZipCode: 28429
 Owner:
 Client: Eric Sabourin Client Address:
 Verifier Name: Paul Hayden - Size Matters Inspection Date: 09/02/2025

SKETCH

5011 Marathon Landing Ct, Castle Hayne NC

1,413 SF

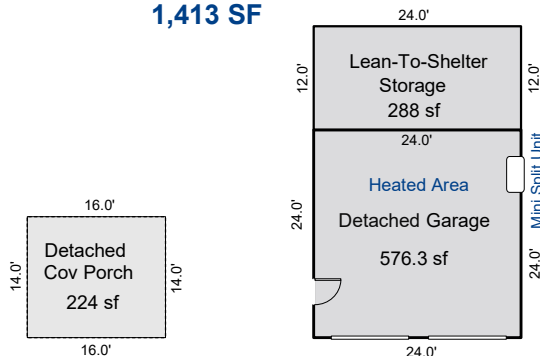

Sep 2, 2025

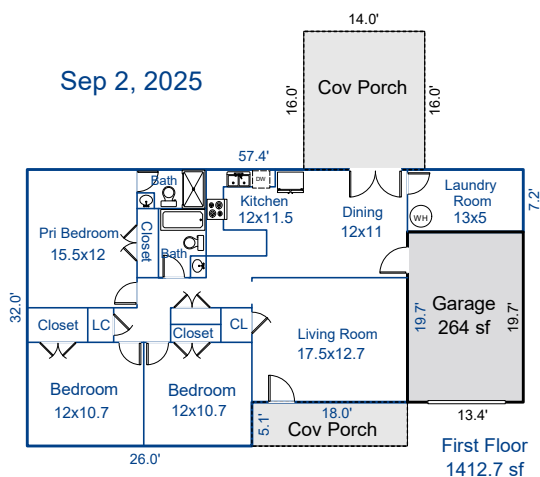

Disclosure: Interior walls and room sizes are approximate

Floor Plan by Size Matters 910-797-0439
 NC Real Estate License 249188

Sketch by ApexSketch

AREA CALCULATIONS SUMMARY						AREA CALCULATIONS BREAKDOWN				
Code	Description	Factor	Net Size	Perimeter	Net Totals	Name	Base x	Height x	Width =	Area
GLA1	First Floor	1.0	1412.7	178.8	1412.7	First Floor		44.0 x	26.9 =	1183.6
GAR	Garage	1.0	264.0	66.2				13.4 x	7.2 =	96.5
	Garage	1.0	576.3	96.0	840.3			26.0 x	5.1 =	132.6
OTH	Storage	1.0	288.0	72.0	288.0					
P/P	Cov Porch	1.0	91.8	46.2						
	Cov Porch	1.0	224.0	60.0						
	Cov Porch	1.0	224.0	60.0	539.8					
	Net LIVABLE	cnt	1 (rounded)		1,413	3 total items			(rounded)	1,413

SKETCH/AREA TABLE ADDENDUM

SUBJECT INFO

File No.: Parcel No.:
Property Address: 5011 Marathon Landing Ct
City: Castle Hayne County: New Hanover State: NC ZipCode: 28429
Owner:
Client: Eric Sabourin Client Address:
Verifier Name: Paul Hayden - Size Matters Inspection Date: 09/02/2025

SKETCH

First Floor (GLA1)

44.00 x 26.90 = 1183.60
13.40 x 7.20 = 96.48
26.00 x 5.10 = 132.60
Total area: 1412.68

Cov Porch (P/P)

18.00 x 5.10 = 91.80
Total area: 91.80

Cov Porch (P/P)

16.00 x 14.00 = 224.00
Total area: 224.00

Garage (GAR)

19.70 x 13.40 = 263.98
Total area: 263.98

Cov Porch (P/P)

16.00 x 14.00 = 224.00
Total area: 224.00

Storage (OTH)

24.00 x 12.00 = 288.00
Total area: 288.00

Garage (GAR)

24.01 x 24.00 = 576.31
Total area: 576.31