



Owner's Name: CLARK ROBERT L

Property Address: 440 STONE CHIMNEY RD SW 28462

Subdivision: _____ Lot: _____ Block: _____ Section: _____

Water Supply: Public Water or Private Water Project Type: Residential or Commercial

Existing System Reuse Authorization

- Maintain 10 feet minimum to any water line
 - Do not drive, park, pave, or build any structure over the initial septic system area or repair septic system area
 - Maintain 5 feet to any structure
 - Maintain gravity flow to the septic system
 - Maintain the following setback to any well: 50 feet or 100 feet
 - Type of Repair Wastewater System: N/A
 - The existing septic system appears to be functioning and continued use is approved per this authorization. Maintenance and/or repair may be necessary at any given time.
- The owner and a Public Management Entity/Subsurface System Certified Operator shall execute a contract which addresses all of the requirements for maintenance, monitoring, schedule and operation, and reporting in Section .1961. Provisions of said contract shall be in effect for as long as the system is in use. Management of the wastewater system should be provided at all times.
- Other: _____
- Other: _____

• Actions of local health services representatives, or the State, engaged in the evaluation and determination of measures required to effect compliance with the applicable laws and rules, shall in no way be taken as a warranty that sewage treatment and disposal systems approved and permitted will function in a satisfactory manner for any given period of time.

Existing System Reuse Issuance Date: 9/14/2022

REHS Signature: [Signature]

REHS Registration Number: 3077

See Existing System Reuse Site Plan for Septic System Location and Further Detail



Brunswick County Environmental Health Services
Onsite Wastewater Information

BCHS File Number: 1993032104A
Tax Parcel: 1680001001

Site Plan For (Check One):

- Improvement Permit
- Well Permit
- Fill Plan
- Proposal
- Authorization to Construct Permit
- Existing System Reuse
- Other: _____

SITE PLAN ONLY. THIS IS NOT A PERMIT

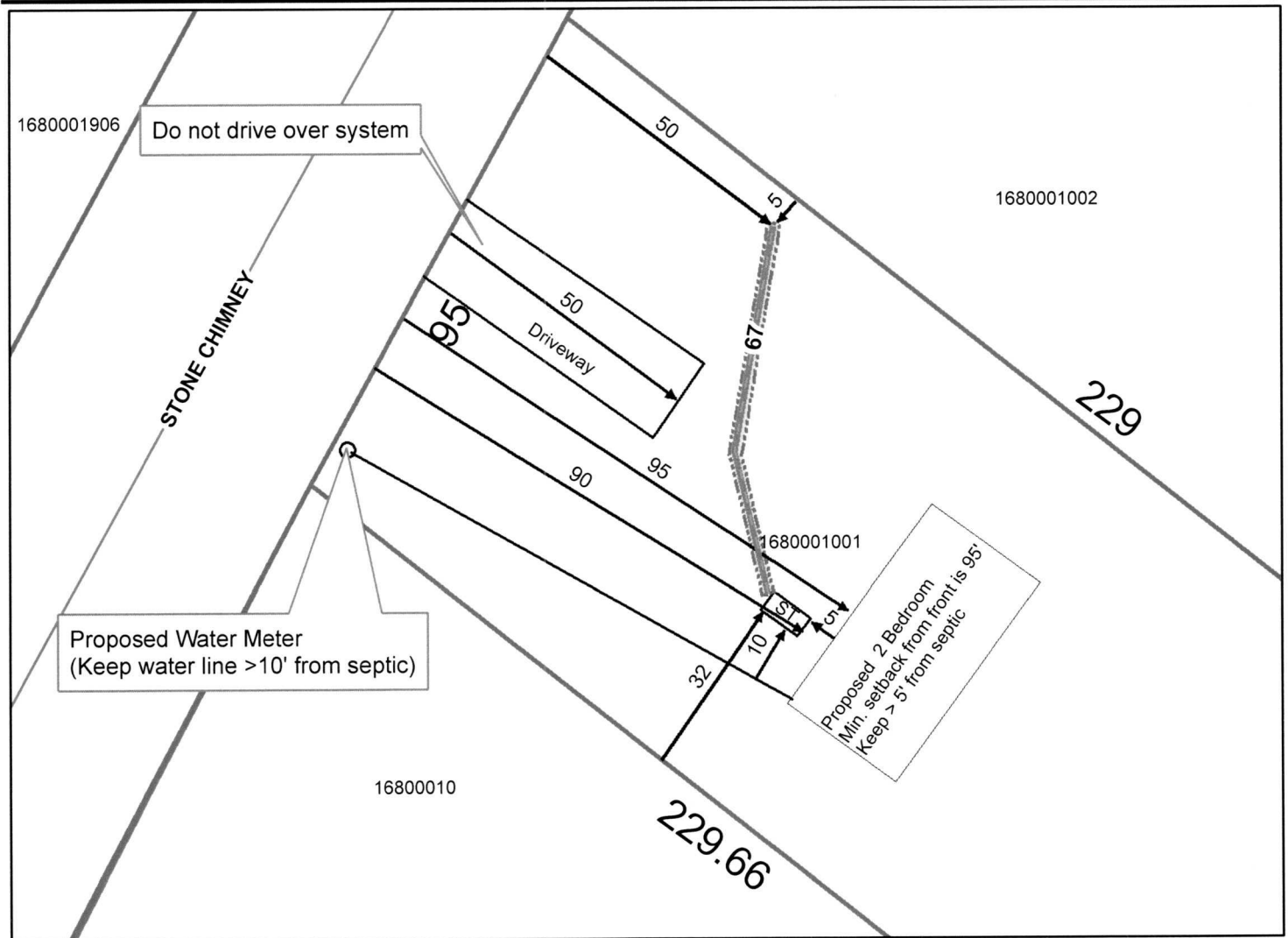

30 15 0 30 Feet

1 inch = 30 feet

Onsite Wastewater System Design Criteria

Type of Initial Wastewater System: II-A
 Number of Bedrooms (Max.): 2
 Design Flow (GPD): 240
 Number of Lines: 1
 Trench Bottom Depth (Max. Inches): existing
 Min. Size of Septic Tank (Gal.): existing
 Min. Size of Pump Tank (Gal.): _____
 Min. Size of Grease Trap (Gal.): _____

Number of Occupants Employees (Max.): 4
 LTAR (gpd/ft²): existing
 Length of Lines (Feet): ~67'
 Width of Lines (Feet): 3
 Drainfield Square Feet: existing
 Bed Dimensions (Feet x Feet): _____
 Other Information: _____
 Other Information: _____

REHS Signature

9/12/22
Date