

Building Sketch (Page - 1)

Client	Debi Gallo & Kat Potter - St James Properties LLC		
Property Address	3566 Sanderling Dr SE		
City	Southport	County Brunswick	State NC Zip Code 28461
Client	Debi Gallo & Kat Potter - St James Properties LLC		

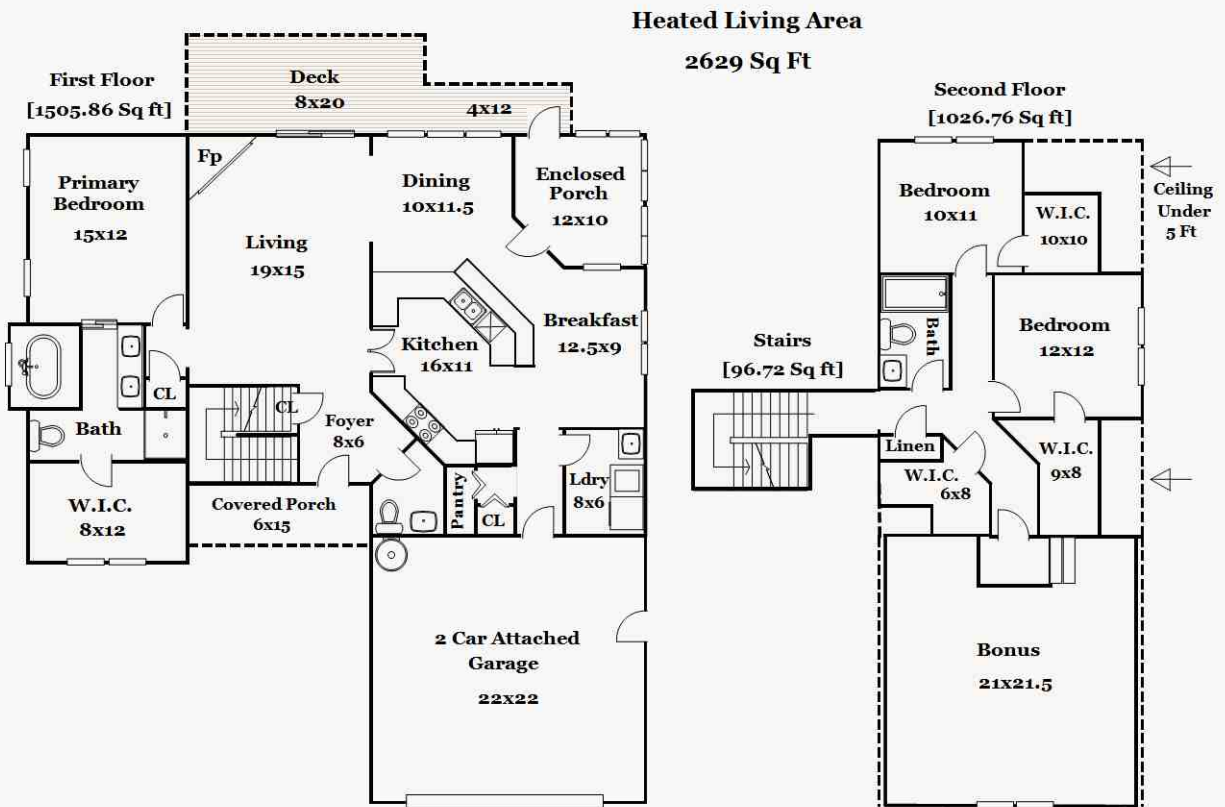

Note: This floor plan is for illustration purposes only. All measurements are rounded.
 Square footage is based on ANSI measurement standards from exterior dimensions.
 Floor plan produced by Precision Home Measuring (910) 620-9711

Building Sketch (Page - 2)

Client	Debi Gallo & Kat Potter - St James Properties LLC			
Property Address	3566 Sanderling Dr SE			
City	Southport	County Brunswick	State NC	Zip Code 28461
Client	Debi Gallo & Kat Potter - St James Properties LLC			

TOTAL Sketch by a la mode

Area Calculations Summary

Living Area	Calculation Details		
Stairs	96.72 Sq ft	8×9.5	$= 76$
		5.6×3.7	$= 20.72$
First Floor	1505.86 Sq ft	6.9×1.5	$= 10.35$
		13×6.4	$= 83.2$
		$0.5 \times 22.3 \times 0$	$= 0.01$
		$0.5 \times 4.2 \times 0$	$= 0$
		22.3×4.2	$= 93.66$
		$0.5 \times 17.6 \times 0.01$	$= 0.08$
		50.2×17.6	$= 883.5$
		$0.5 \times 4.1 \times 4.1$	$= 8.41$
		39.5×4.1	$= 162$
		39.5×6.7	$= 264.65$
Second Floor	1026.76 Sq ft	11.7×4.28	$= 50.07$
		17.9×6.5	$= 116.35$
		21.4×11.78	$= 252.09$
		17.9×7.12	$= 127.45$
		2.4×13.6	$= 32.64$
		17.4×0.08	$= 1.39$
		20.4×21.86	$= 445.95$
		$0.5 \times 20.4 \times 0.08$	$= 0.82$
Total Living Area (Rounded):	2629 Sq ft		
Non-living Area			
Deck	205.93 Sq ft	8.1×19.4	$= 157.14$
		4.1×11.9	$= 48.79$
Enclosed Porch	107.09 Sq ft	10.8×6.59	$= 71.16$
		4.1×6.7	$= 27.48$
		$0.5 \times 0.01 \times 6.7$	$= 0.03$
		$0.5 \times 4.1 \times 4.1$	$= 8.41$
2 Car Attached	483.91 Sq ft	22.3×21.7	$= 483.91$
Covered Porch	74.5 Sq ft	5×14.9	$= 74.5$