

Building Sketch

Borrower/Client Jenny King				
Property Address 354 R L Honeycutt Dr				
City	Wilmington	County	State NC	Zip Code 28412
Lender	Measured 3/19/26			

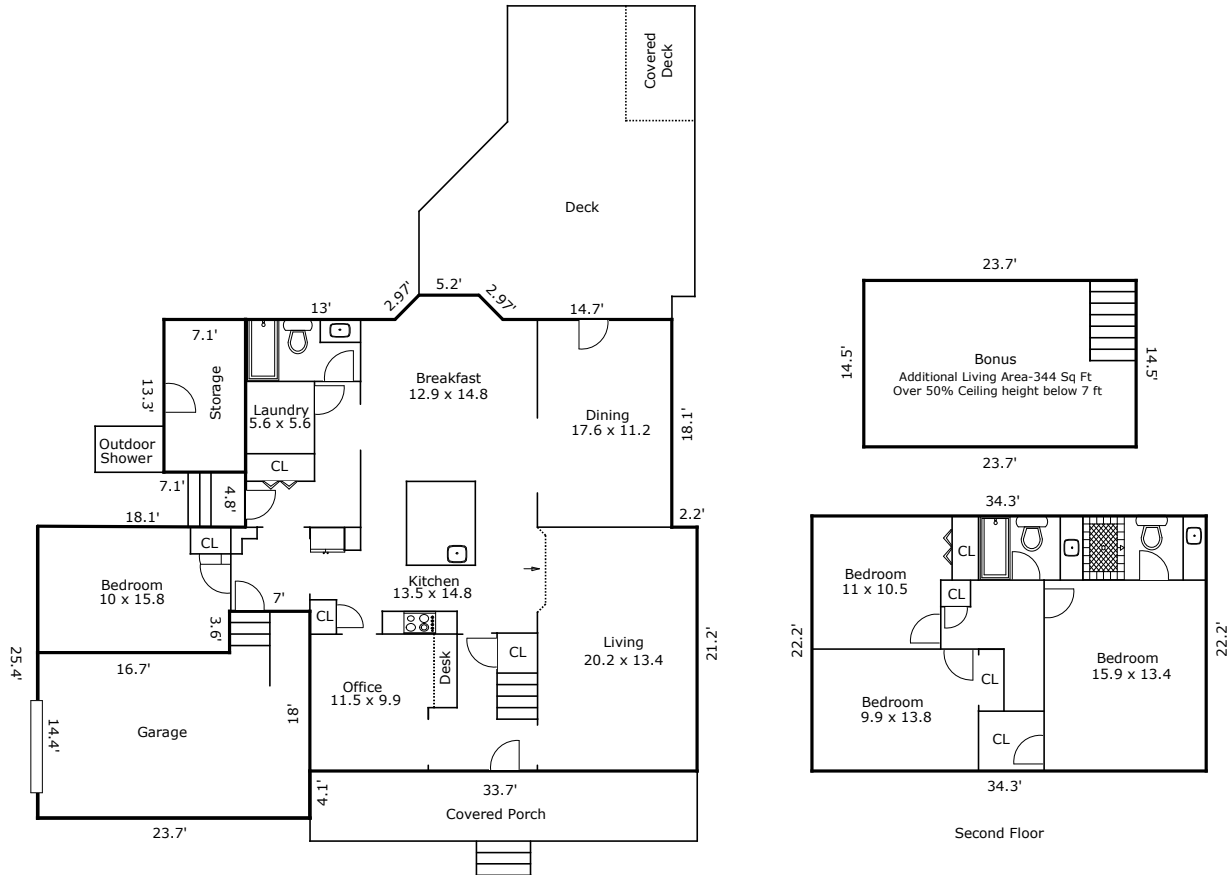

TOTAL Sketch by a la mode

Area Calculations Summary

Living Area	
Garage	-366.48 Sq ft
First Floor	2001.8 Sq ft
Second Floor	761.46 Sq ft
Total Living Area (Rounded):	2397 Sq ft
Non-living Area	
Storage	94.43 Sq ft
Second Floor - Additional Living Area (ceiling height over 50% below 7 ft)	343.65 Sq ft

Building Sketch

Borrower/Client Jenny King				
Property Address 354 R L Honeycutt Dr				
City	Wilmington	County	State NC	Zip Code 28412
Lender	Measured 3/19/26			

TOTAL Sketch by a la mode

Area Calculations Summary

Living Area	Calculation Details		
Garage	-366.48 Sq ft	14.4×16.7	= 240.48
		18×7	= 126
First Floor	2001.8 Sq ft	$0.5 \times 2.1 \times 2.1$	= 2.2
		$0.5 \times 2.1 \times 2.1$	= 2.2
		5.2×2.1	= 10.92
		37.1×18.1	= 671.51
		21.2×33.7	= 714.44
		23.7×25.3	= 599.61
		$0.5 \times 18.1 \times 0.1$	= 0.9
Second Floor	761.46 Sq ft	22.2×34.3	= 761.46
Total Living Area (Rounded):		2397 Sq ft	
Non-living Area			
Storage	94.43 Sq ft	13.3×7.1	= 94.43
Second Floor - Additional Living Area (ceiling height over 50% below 7 ft)	343.65 Sq ft	23.7×14.5	= 343.65