

MOORE COUNTY HEALTH DEPARTMENT
ENVIRONMENTAL HEALTH SECTION
OPERATION PERMIT

Lot 5072
4 Bedroom Septic

Owner: William & Jane Scholtes Address: 128 Morris Drive 74 West
Permit # _____ Receipt # 50922 LRK# 27044
Installer: Bob Hartzell Telephone: _____
Address: Pinehurst NC
System Type: Conventional Maximum Design Flow: 480 (gallons/day)
Wastewater Characteristics: Domestic
Septic Tank Capacity: 1000 (Gallons) Tank I.D. # 85B 7/25
Nitrification Line Dimensions: 2 @ 100 x 3
Effluent Distribution Device: 6 box Gravel Depth: 12" T.C.
Depth To: Top of Tanks: 3" (Inches) Trench Bottom: 20" (Inches)

Diagram of Actual Installation: (Depict Property Boundaries, Structures, Driveways, Trees, Water Lines, Water Supplies, Etc.)

Scale: _____ Inch = _____ Feet.

See REURAC

Comments and Conditions: _____

Issued By: Charles Riggs # of Attachments: 1
Date: 9/2/05

FINAL APPROVAL OF THIS SYSTEM SHALL INDICATE THAT THE SYSTEM HAS BEEN INSTALLED IN ACCORDANCE WITH APPLICABLE PERMIT CONDITIONS, LAWS AND RULES, BUT IN NO WAY SHOULD BE TAKEN AS A GUARANTEE THAT THE SYSTEM WILL FUNCTION SATISFACTORILY FOR ANY GIVEN TIME.

(1202 4/1/05 bja)

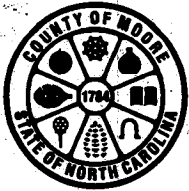

MOORE COUNTY HEALTH DEPARTMENT
ENVIRONMENTAL HEALTH SECTION
P.O. BOX 279, CARTHAGE, N.C. 28327
PHONE: 910-947-6283 FAX: 910-947-6253

IMPROVEMENT PERMIT

Receipt # 50922/28339 LRK# 27044
Owner William & Jane Schottes
Address PO Box 746, West End 27576 Phone No. 673-5504
Exact Directions to Property: Lot 5072 Morris Drive 74W / 128 Morris

Lot Area: 0.65 AC Maximum Long-Term Soil Application Rate: 0.8
Daily Design Wastewater Flow Rate (From Application): 480 / 4 bedrooms
Septic Tank Capacity: 1000 (Gallons) Type Distribution Device: bar
Maximum Trench Depth (From Original Grade): 18" - 28" Pump Tank — Pump Tank Capacity —
Dimensions of Nitrification Lines: 2 @ 109" x 3"
System Type (Initial Installation): CONVENTIONAL
Repair System Type (If Required): IMPROVED
Distance to Water Supplies: Wells, Springs, Etc. — Lakes, Streams, Etc. —
Water Lines 7' - 10' Interceptor/Storm Drains —
Easements Required: Yes — No — Tri-Party Agreement? Yes — No —

NOTE: Should errors or omissions be noted in the drawings or specifications; or if there is doubt as to their meaning, this office should be contacted at once for an interpretation or clarification. All systems are subject to "Laws and Rules for Sewage Treatment and Disposal Systems, North Carolina General Statutes," Article 11 of Chapter 130A and North Carolina Administrative Code (T.15A, 18A, 1901-1908).

System layout (use applicant's plat or attach to permit) Scale 1 inch = 50 feet North

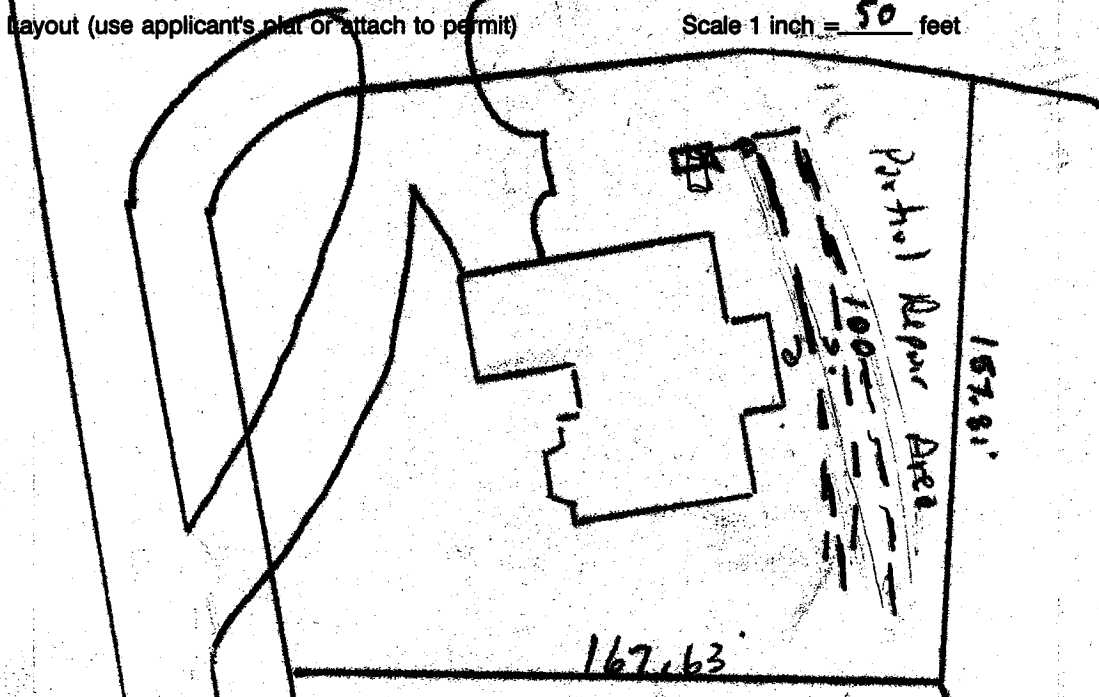

OK'd
9/2/05

Comments: _____
Issued by: Charles Riggs # Attachments: —
Date: 3/23/05
This Permit is Valid unless the Site, Site Plan, Plat or Intended Use of the Property Changes for a Period of Sixty (60) Months.

Authorization to Construct Wastewater System
Issued by: Charles Riggs Date: 3/23/05
This authorization is Necessary Prior to Obtaining a Building or Electrical Permit and Expires Sixty (60) Months From the Date Issued or Immediately if the Site, Site Plans or Intended Use of the Property Changes. Attachments: _____