

Pitt County Property Record Search

74303
2203 FRANKLIN DR

GARCIA, YOLANDA | BARTLETT, DABNEY L
2203 FRANKLIN DR WINTERVILLE NC 28590

Total Market Value
\$324,390

KEY INFORMATION

Property Use	RES	Lot Number	141
Zoning	R10	Land Class	RES
Land Size	1.20	Legal Description	Canterbury
Township	WINTERVILLE	Fire District	EMS
Neighborhood	007122A	Planning Jurisdiction	WV
Municipality	WINTERVILLE		

ASSESSMENT DETAILS

Land Value	\$40,000
Building Value	\$284,390
Misc Improvements Value	\$0
Use Value Deferred	\$0
Total Market Value	\$324,390
Total Taxable Value	\$324,390

BUILDING DETAILS

RESIDENTIAL BUILDING (1)

Card #	1	Style	01-SFR-CONST(01-SFR)
Living Area	2286	Exterior Wall	AL/VINYL
Internal Wall (1)	DRYWALL	Internal Wall (2)	-
Heat	HEAT-P	A/C	CENT
Bedrooms	0	Full Baths	2
Half Baths	1	Fireplace	1
Garage	Y	Carport	N
Grade	C+5	Foundation	CONFTOOT
Stories	1.80	Year Built	2007
Effective Year Built	2007		

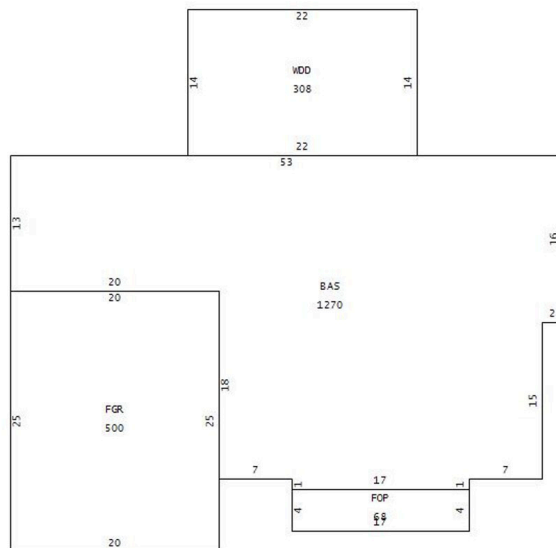

SALES HISTORY

SALE DATE	SALE PRICE	SALE TYPE	DEED / DOCUMENT DATE	QUALIFIED
-	-	-	004650,00557	-

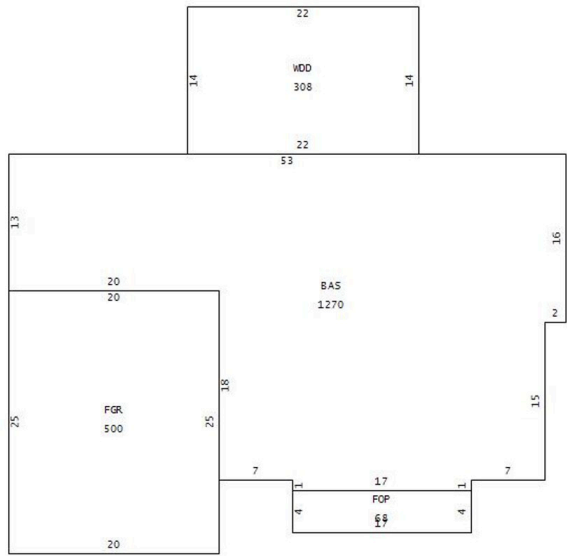
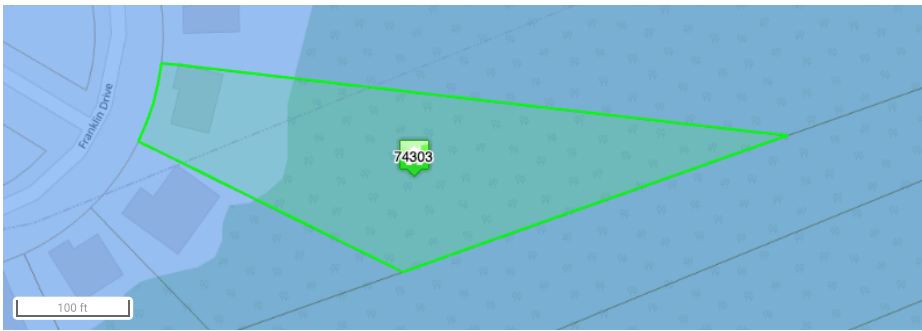

Data last updated: 06/23/2025