

pending RCL0

**SOIL/SITE EVALUATION
 For On-Site Wastewater Systems**

Owner: **MACON GARY**

Applicant: **STRICKLAND WILLIAM**

Application Date: 4/25/2017

Date Evaluated: 4/26/17

Proposed Facility: addition

Proposed Design Flow: 240 gpd

50 50 102 102

of Roof

7206 BANNER STREET SW

LOT 64 SEASIDE HEIGHTS

coll

Water Supply: PRIVATE Public Spring Other Eval. Method: Auger Boring Pit Cut

Profile Number	Horizon Depth (inches)	Soil Morphology (.1941)					Other Profile Factors
		(a)(1) Texture	(a)(2) Structure	(a)(3) Mineralogy Consistence	Soil Matrix Color	Soil Mottle Color	
							.1940 Landscape
							.1942 Wetness Condition
							.1943 Soil Depth
							.1944 Restrictive Horizon
							.1947 Profile Classification
							Profile LTAR
							.1940 Landscape
							.1942 Wetness Condition
							.1943 Soil Depth
							.1944 Restrictive Horizon
							.1947 Profile Classification
							Profile LTAR
							.1940 Landscape
							.1942 Wetness Condition
							.1943 Soil Depth
							.1944 Restrictive Horizon
							.1947 Profile Classification
							Profile LTAR
							.1940 Landscape
							.1942 Wetness Condition
							.1943 Soil Depth
							.1944 Restrictive Horizon
							.1947 Profile Classification
							Profile LTAR

Available Space (.1945) 5 Other Factors (.1946) 5 Site Classification S
 System Type(s) HA Site Long-Term Acceptance Rate(s) ca
 valuatedBy: MEW Other(s) Present: neighbors
 Comments: OK as proposed

Show profile location and other size features (dimensions, reference or benchmark and north arrow)

50' STORAGE

(50)

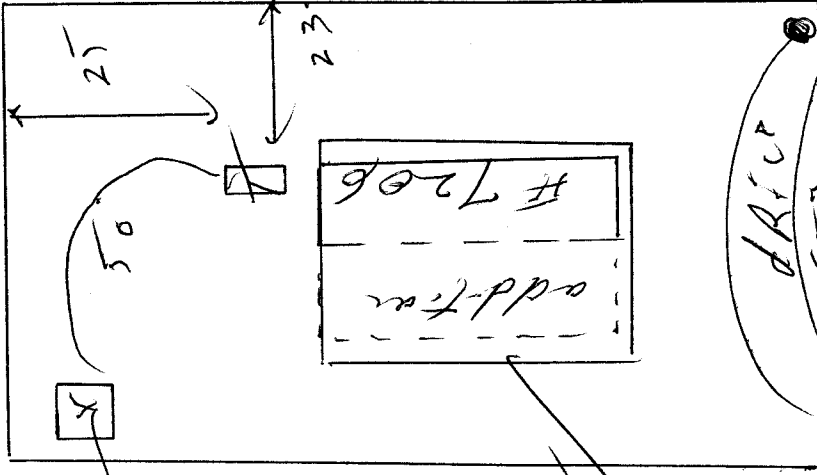

DRIVE

(50)

BENCHMARK ST. SW →

Legend

Use of the following abbreviations

Landscape Position	Clay Mineralogy		Structure Grade
	SEXP (slightly expansive)	EXP (expansive)	
CC (concave slope)	w	(weak)	
CV (convex slope)	m	(moderate)	
D (drainage way)	s	(strong)	
DS (debris slump)			
FP (flood plain)			
FS (foot slope)			
H (head slope)			
L (linear slope)			
N (nose slope)			
R (ridge)			
S (shoulder slope)			
T (terrace)			
TS (toe slope)			
Group	Soil Texture	Conventional LTAR	LPP LTAR
I	S (sand)	1.2 - 0.8	0.6 - 0.4
	LS (loamy sand)		
II	SL (sandy loam)	0.8 - 0.6	0.4 - 0.3
	L (loam)		
III	SCL (sandy clay loam)	0.6 - 0.3	0.3 - 0.15
	CL (clay loam)		
	SiCL (silty clay loam)		
	Si (silt)		
IV	SC (sandy clay)	0.4 - 0.1	0.2 - 0.05
	SIC (silty clay)		
	C (clay)		
	O (organic)		

*adjust LTAR due to depth, consistency, structure, soil wetness, landscape position, wastewater flow and quality units measured in gpd/sqft

Notes
 Horizon depth: in inches below natural soil surface
 Depth to fill: in inches from land surface
 Restrictive: thickness and depth from land surface
 Horizons: S (suitable) or U (unsuitable)
 Soil Wetness: inches from land surface to free water or inches from land surface to soil colors with chroma 2 or less - record Munsell color chip
 S (suitable), PS (provisionally suitable), or U (unsuitable)

Well Location Investigation: (note adjacent properties and locate wells, make a small inset drawing indicating properties surrounding evaluated property, if properties are not developed locate any files pertaining to adjacent properties and note setback requirements)

List Adjacent Lot Permit Numbers Here:
 FALLOK MILWA
 F/26/07

Required setbacks

Property Lines: _____
 SA Waters: _____ Ponds: _____
 Streams: _____ Embankments: _____
 Drainage Features: _____ Type: _____ Setback: _____
 Noted location of existing water lines on adjacent properties and possible location for water line on this property: _____
 Wells, sufficient space to install: _____

TO BENCH 75 FT

TO BENCH CK

UNDER 30'

HOME 24'

FROM

ROOT

(102) SUPPORT

LOCK 2' IN

GROUND UP

CONCRETE

PICKS

DRIVE

(50)

BENCHMARK ST. SW

shed

Block

root ark

rock

concrete

PICKS

DRIVE

(50)

BENCHMARK ST. SW

shed

Block

root ark

rock

concrete

PICKS

DRIVE

(50)

BENCHMARK ST. SW