

PRELIMINARY PLOT PLAN FOR
THREE SIX BUILDERS

LOT 153, SURREY MEADOWS

SWEET WILLIAMS LANE

REF: P.B. 44, PAGE 60

CITY OF WILSON

WILSON COUNTY, NORTH CAROLINA

MAY 9, 2023

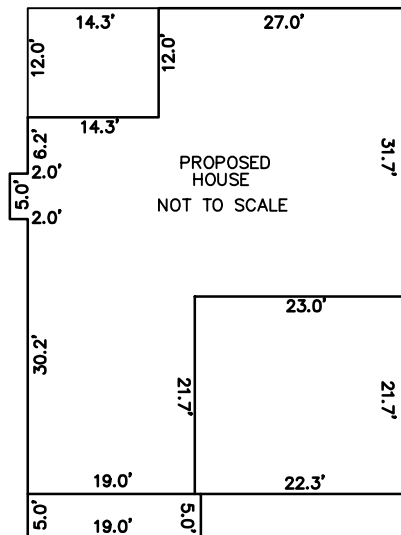

SCALE 1"=30'

N/F
 CITY OF WILSON
 D.B. 2292, PAGE 393
 PIN# 3703-42-4961

152

SURREY MEADOWS
 P.B. 44, PAGE 60

153

6,988 S.F.
 0.160 AC.

154

SURREY MEADOWS
 P.B. 44, PAGE 60

5' UTILITY
 EASEMENT

COVERED
 PORCH

PROPOSED
 HOUSE
 AMANDA

PROPOSED
 DRIVEWAY

SWEET WILLIAMS LANE 50' PUBLIC R/W

PROPOSED TREE

IMPERVIOUS SURFACE TABLE

HOUSE	2,137 S.F.
COVERED PORCH	172 S.F.
DRIVEWAY	468 S.F.
SIDEWALKS	66 S.F.
MISC/UTILITIES	36 S.F.
TOTAL IMPERVIOUS AREA	2,879 S.F.
TOTAL LOT AREA	6,988 S.F.
PERCENTAGE OF IMPERVIOUS AREA	41.19%

THIS SURVEYOR DOES NOT
 WARRANTY THE ACCURACY
 OF ARCHITECTURAL DIMENSIONS.
 THEY ARE TO BE VERIFIED BY
 THE CONTRACTOR.

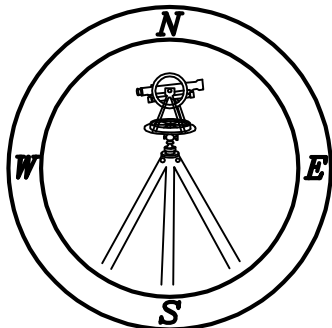

CMP

Professional Land Surveyors
 C-1525

333 S. White Street
 Post Office Box 1253
 Wake Forest, N.C. 27588
 (919)556-3148

NOTES:

-THIS PLAN DOES NOT REFLECT AN
 ACTUAL SURVEY. IT IS A PRELIMINARY
 PLAN AND SHOULD BE USED FOR ITS
 INTENDED PURPOSE ONLY.
 -NOT FOR RECORDATION, CONVEYANCES,
 OR SALES.