

Building Sketch (Page - 1)

Borrower					
Property Address	497 Main St				
City	Winterville	County	State	NC	Zip Code 28590
Lender/Client					

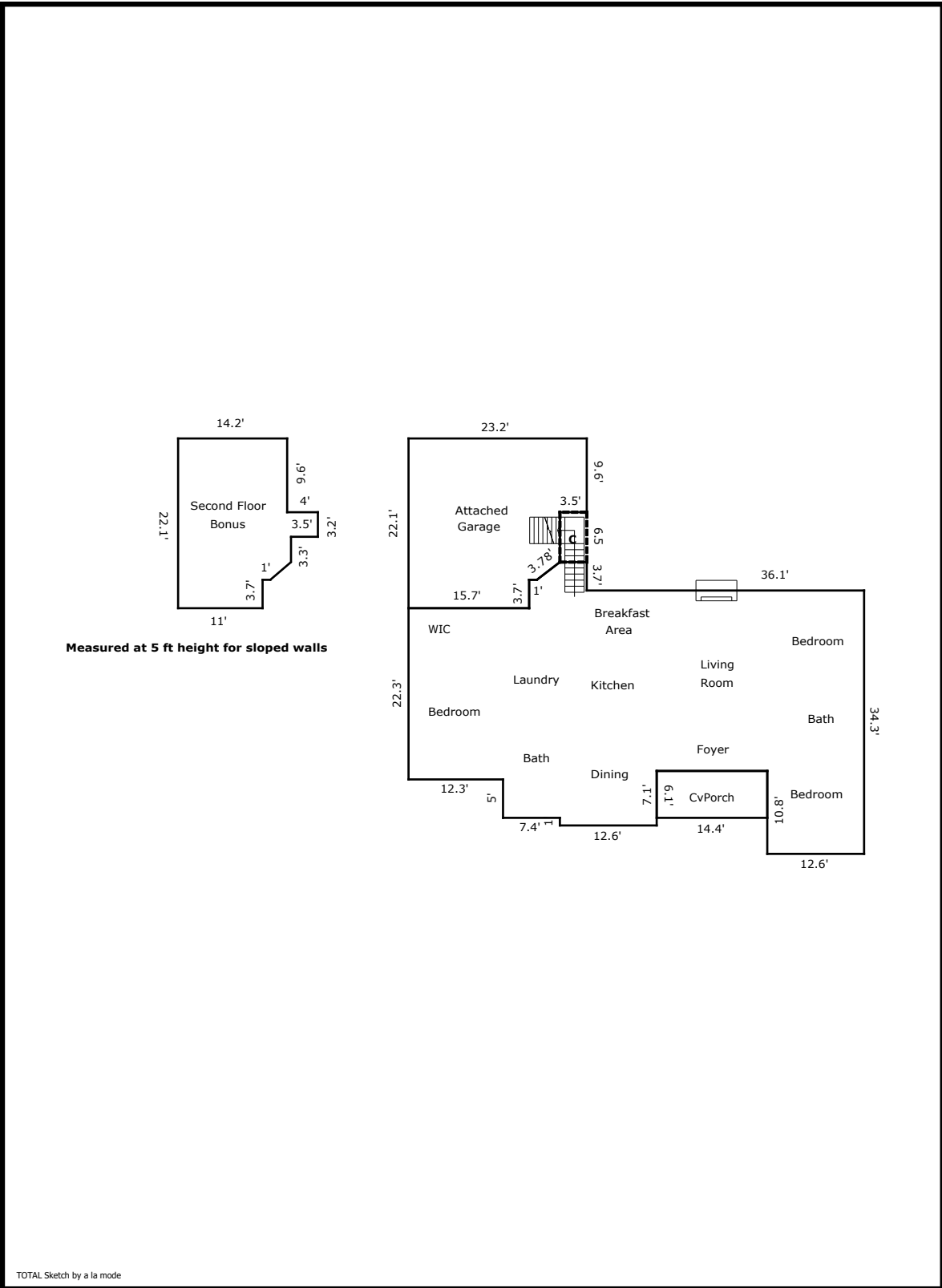

Building Sketch (Page - 2)

Borrower					
Property Address	497 Main St				
City	Winterville	County	State	NC	Zip Code 28590
Lender/Client					

TOTAL Sketch by a la mode

Area Calculations Summary

Living Area	Calculation Details	
First Floor (Above Grade)	1663.65 Sq ft	$12.6 \times 10.8 = 136.08$ $23.5 \times 27 = 634.5$ $22.3 \times 12.3 = 274.29$ $30.6 \times 9.1 = 278.46$ $3.5 \times 1 = 3.5$ $10.9 \times 27.3 = 297.57$ $6 \times 3.5 = 21$ $4 \times 3.7 = 14.8$ $0.5 \times 3 \times 2.3 = 3.45$
Second Floor (Above Grade)	314.48 Sq ft	$3.2 \times 3.5 = 11.2$ $14.2 \times 9.6 = 136.32$ $12.5 \times 11 = 137.5$ $3.7 \times 6.5 = 24.05$ $2.3 \times 1 = 2.3$ $0.5 \times 2.3 \times 2.7 = 3.1$
Total Living Area (Rounded):	1978 Sq ft	
Non-living Area		
Attached Garage	450.72 Sq ft	$22.1 \times 15.7 = 346.97$ $7.5 \times 9.6 = 72$ $4 \times 6.5 = 26$ $2.3 \times 1 = 2.3$ $0.5 \times 2.3 \times 3 = 3.45$
Front Covered Porch	87.84 Sq ft	$6.1 \times 14.4 = 87.84$
Storage Closet in garage	22.75 Sq ft	$3.5 \times 6.5 = 22.75$