

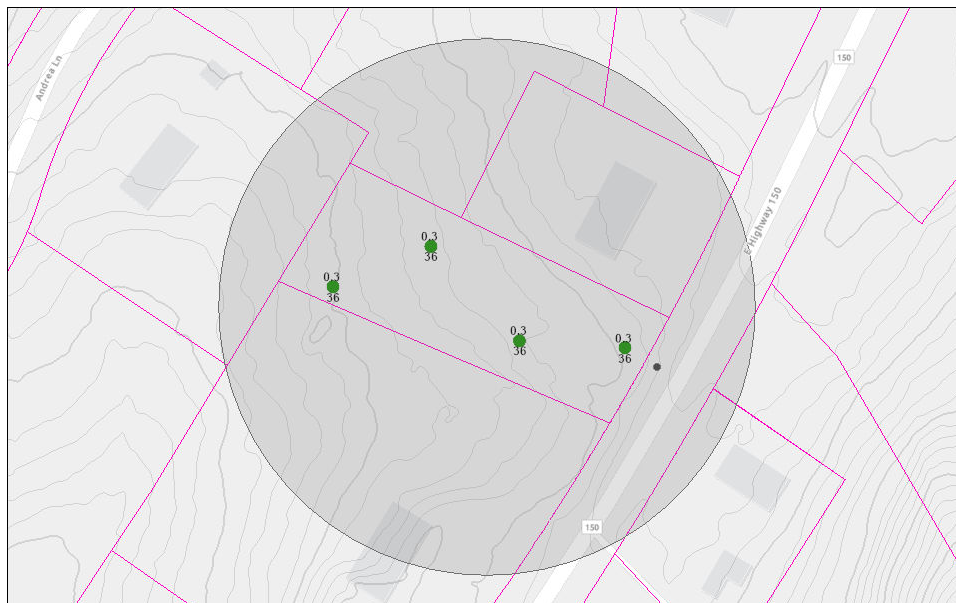

# 5093 E NC 150 HWY Soil Evaluation Report

## Area of Interest (AOI) Information

Nov 4 2025 16:14:18 Eastern Standard Time



**An area was identified that may be possible to use for a 360GPD/3BR subsurface wastewater system. The system type and exact location would need to be confirmed with a field layout/design. Client will need to confirm there are no restrictions, easements, right of ways or other encumbrances on the property that would limit the use of the area shown on the report.**

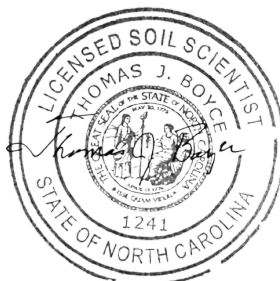

## Summary

Name	Count	Area(ft <sup>2</sup> )	Length(ft)
Borings	4	N/A	N/A
Points	0	N/A	N/A
System Description	0	N/A	N/A

## Borings

#	Boring Type	H1_Depth	H1_Mineral	H1_Moist_C	H1_Plastic	H1_Stickin	H1_Structu	H1_Texture
1	Conventional	8	Slightly Expansive	Friable	Plastic	Sticky	SBK	Clay Loam
2	Conventional	4	Slightly Expansive	Friable	Plastic	Sticky	SBK	Clay Loam
3	Conventional	4	Slightly Expansive	Friable	Plastic	Sticky	SBK	Clay Loam
4	Conventional	6	Slightly Expansive	Friable	Plastic	Sticky	SBK	Clay Loam

#	H2_Depth	H2_Mineral	H2_Moist_C	H2_Plastic	H2_Stickin	H2_Structu	H2_Texture	H3_Depth
1	36.00	Slightly Expansive	Friable	Plastic	Sticky	SBK	Clay	N/A
2	36.00	Slightly Expansive	Friable	Plastic	Sticky	SBK	Clay	N/A
3	36.00	Slightly Expansive	Friable	Plastic	Sticky	SBK	Clay	N/A
4	36.00	Slightly Expansive	Friable	Plastic	Sticky	SBK	Clay	N/A

#	H3_Mineral	H3_Moist_C	H3_Plastic	H3_Stickin	H3_Structu	H3_Texture	Landscape_	LTAR
1	N/A	N/A	N/A	N/A	N/A	N/A	Linear	0.30
2	N/A	N/A	N/A	N/A	N/A	N/A	Linear	0.30
3	N/A	N/A	N/A	N/A	N/A	N/A	Linear	0.30
4	N/A	N/A	N/A	N/A	N/A	N/A	Linear	0.30

#	Notes	Saprolite	Slope	Soil_Wetne	Usable_Dep	Count
1	N/A	N/A	5-8%	N/A	36	1
2	N/A	N/A	5-8%	N/A	36	1
3	N/A	N/A	5-8%	N/A	36	1
4	N/A	N/A	5-8%	N/A	36	1

# 5093 E NC 150 HWY 2025



11/4/2025

Borings

● Conventional

▭ North Carolina Parcels (Polygons) - Parcels (polys)

2' Contours

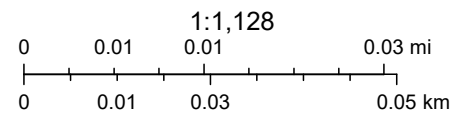
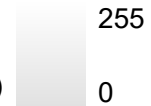

Sources: Esri, TomTom, Garmin, FAO, NOAA, USGS, (c) OpenStreetMap contributors, and the GIS User Community, Sources: Esri, TomTom, Garmin,