

10:50

**ONSLow COUNTY HEALTH DEPT.**

**OPERATIONS PERMIT (GS 130A-337)**

Permit No.: 19752  
Systems Type: IIa

Owner: Vista Cay  
Address: Lot 53  
Location: Magnolia Dr.  
Sr#:

**FINAL PLOT / REMARKS**  
System type \_\_\_\_\_  
Manufacturer \_\_\_\_\_  
Model# \_\_\_\_\_  
4BR / 480 gpd.

THIS DOES NOT CONSTITUTE A WARRANTY OR GUARANTEE.

Installed By: Daryl Parker  
Signed By: Richard Robinson  
Date: 8-19-2008

**ONSLow COUNTY HEALTH DEPT.**

**CONSTRUCTION AUTHORIZATION (GS 130A-336)**

Permit No.: 19752  
Fee: IIa

THIS AUTHORIZATION FOR WASTEWATER SYSTEM CONSTRUCTION SHALL BE VALID FOR A PERIOD EQUAL TO THE PERIOD OF VALIDITY OF THE IMPROVEMENT PERMIT. NOT TO EXCEED 5 YEARS.

Owner: Vista Cay  
Address: Lot 53  
Location: Magnolia Dr.  
Sr#:

System Type/Description: IIa / conventional LTAR: .8 gpd/sq. ft.  
Septic Tank Size: ≥ 1000 gallons  
Nitrification Area: 600 sq. ft. 200 lin. ft.  
No. of lines: 3 Line length 67'  
Trench bottom depth: 30" at deepest  
(SEE ATTACHED PAGES 1-1 of 1 FOR ADDITIONAL PERMIT CONDITIONS)  
Signed: John H. Kelly, P.E. Date: 10-31-07

**ONSLow COUNTY HEALTH DEPT.**

**IMPROVEMENT PERMIT (GS 130A-336)**

Permit No.: 19752  
Fee: IIa

- Valid for 5 years from date of issuance.
- Valid without expiration.

Owner: Vista Cay  
Address: Lot 53  
Location: Magnolia Dr.  
Sr#:

System Type/Description: IIa / conventional LTAR: .8 gpd/sq. ft.  
Facility/Daily design flow: 4BR / 480 gpd  
Water supply: On-site well  Comm. well  Public  Other   
(SEE ATTACHED PAGES 1-1 of 1 FOR ADDITIONAL PERMIT CONDITIONS)  
Signed: John H. Kelly, P.E. Date: 7-23-07

NOTE: Permit is subject to revocation if site plans or intended use change.

Buff Ledger: ORIGINAL Blue: BUILDING INSPECTION Pink: CLIENT

**PLOT PLAN**

Owner: Vista Cay  
 Address: Lot 53  
 Location: Magnolia Dr.

**Additional Permit Conditions**

1. Do not park or drive on any part of system or repair area
2. Nitrification trench aggregate shall be covered with straw, untreated paper or other approved materials prior to final cover/backfilling.
3. Do not install system under wet conditions.
4. Adhere to minimum set back requirements as stated in Rule .1950 and .1951 of NC Laws and Rules for Sewage Treatment and Disposal System (Article 11, G.S. Chapter 130A) unless otherwise indicated on this permit.
5. Rock used in soil absorption systems shall be clean, washed gravel or crushed stone and graded or sized in accordance with size numbers 3, 4, 5, 57, or 6 of ASTM D-448 (standard sizes of coarse aggregate) which is hereby adopted by reference in accordance with G.S. 150 B-14 (c). Documentation of aggregate size shall be available upon request.
6. All pump tanks shall be tested for water tightness. Septic tanks may be subject to a water tightness test.
7. The septic tank is designed to receive sewage or wastewater under gravity flow. However, if a system subject to the N.C. Plumbing Code is used to pump raw sewage to the septic tank, the sewage shall be reduced to gravity/non-turbulent flow by approved means at the inlet of the septic tank.
8. An accepted wastewater system may also be installed in accordance with the accepted wastewater system approval. (Maximum LTAR of 1.0 gpd/ft<sup>2</sup>)

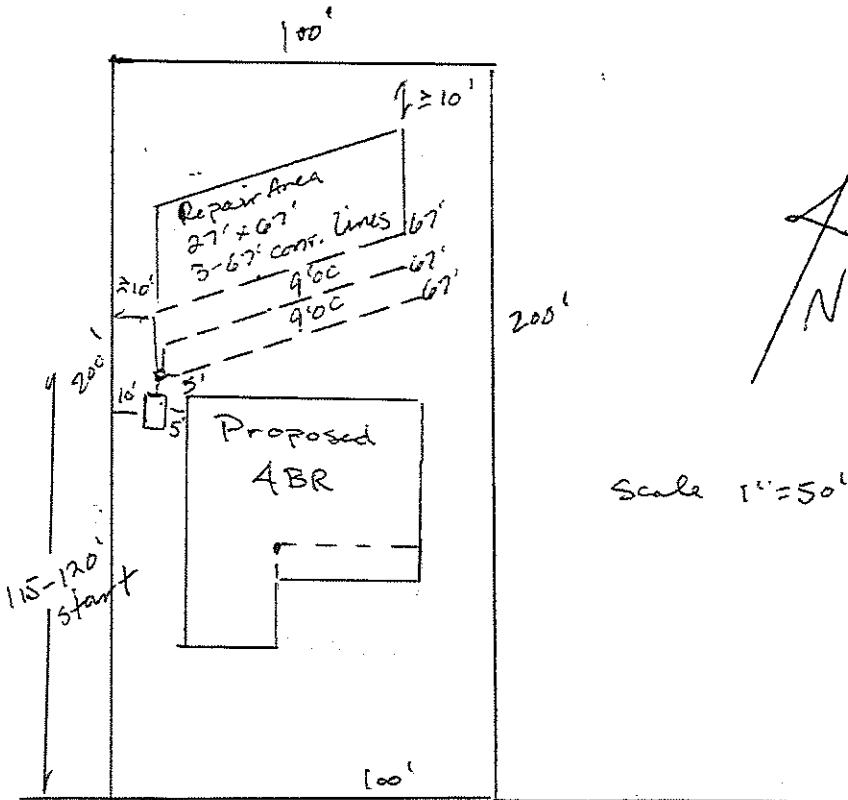

Magnolia Dr.