

Building Sketch (Page - 1)

Client	Kathy Ross - Palm Realty			
Property Address	212 NE 37th St			
City	Oak Island	County Brunswick	State NC	Zip Code 28465
Client	Kathy Ross - Palm Realty			

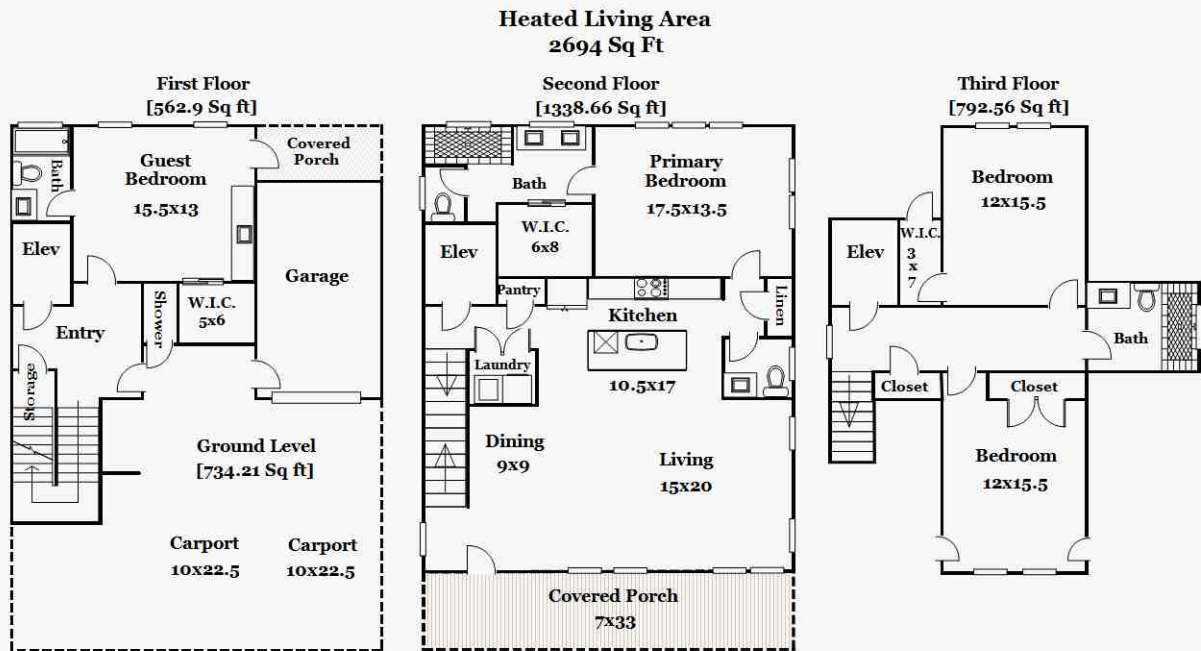

Note: This floor plan is for illustration purposes only. All measurements are rounded.
 Square footage was calculated based on the ANSI measurement standard.
 Floor plan produced by Precision Home Measuring (910) 620-9711

Building Sketch (Page - 2)

Client	Kathy Ross - Palm Realty			
Property Address	212 NE 37th St			
City	Oak Island	County Brunswick	State NC	Zip Code 28465
Client	Kathy Ross - Palm Realty			

TOTAL Sketch by a la mode

Area Calculations Summary

Living Area	Calculation Details		
First Floor	562.9 Sq ft	8×11.2	= 89.6
		11.8×10.5	= 123.9
		14.1×15	= 211.5
		19.7×7	= 137.9
Second Floor	1338.66 Sq ft	40.2×33.3	= 1338.66
Third Floor	792.56 Sq ft	8.1×10.2	= 82.62
		40.2×13	= 522.6
		10.1×16.3	= 164.63
		5.7×3.97	= 22.61
		$0.5 \times 5.7 \times 0.03$	= 0.09
Total Living Area (Rounded):	2694 Sq ft		
Non-living Area			
Ground Level	734.21 Sq ft	11.5×8	= 92
		25.3×22.7	= 574.31
		4.9×7	= 34.3
		10.5×3.2	= 33.6
Covered Porch	234.76 Sq ft	33.3×7	= 233.1
		$0.5 \times 33.3 \times 0.1$	= 1.66
1 Car Attached	221.48 Sq ft	11.3×19.6	= 221.48
Covered Porch	56.5 Sq ft	5×11.3	= 56.5