

## Building Sketch

Borrower	None			
Property Address	310 Porter Mills Rd			
City	Greenville	County Pitt	State NC	Zip Code 27858
Lender/Client	Erin Pierce			

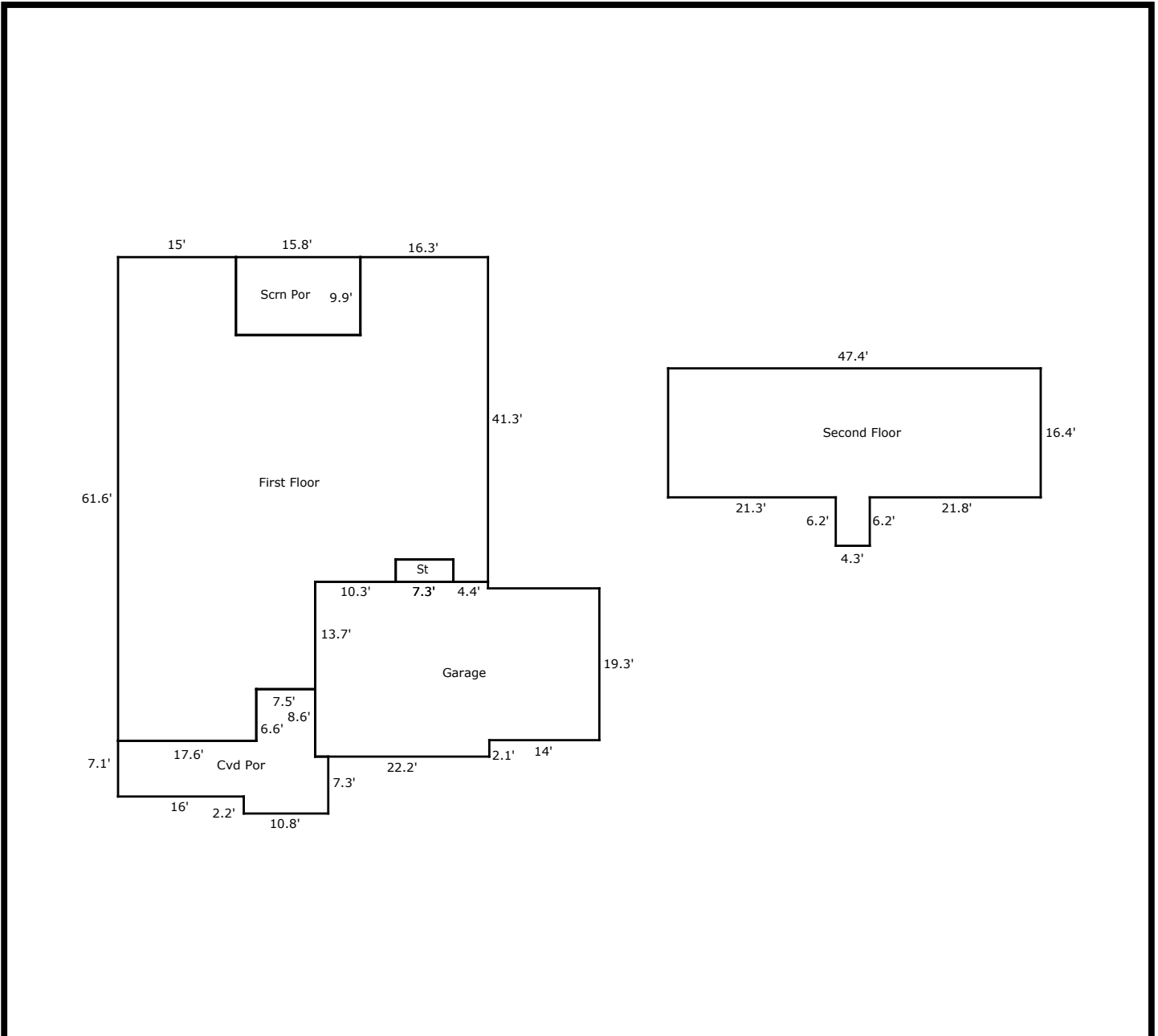

TOTAL Sketch by a la mode

### Area Calculations Summary

Living Area	Area	Calculation Details
First Floor	2226.9 Sq ft	$15 \times 9.9 = 148.8$ $16.2 \times 9.9 = 161.1$ $47.1 \times 28.6 = 1345.8$ $2.8 \times 4.4 = 12.5$ $23.1 \times 17.6 = 405.9$ $7.5 \times 13.7 = 102.5$ $2.8 \times 17.8 = 50.3$
Second Floor	805.1 Sq ft	$4.3 \times 6.2 = 26.7$ $16.4 \times 47.4 = 778.4$
<b>Total Living Area (Rounded):</b>		<b>3032 Sq ft</b>
<b>Non-living Area</b>		
2 Car Attached	763.7 Sq ft	$22.2 \times 22 = 489.5$ $14.2 \times 19.3 = 273.9$ $2.1 \times 0.2 = 0.3$
Storage Room	20.8 Sq ft	$2.8 \times 7.3 = 20.8$
Covered Porch	258.8 Sq ft	$7.5 \times 6.6 = 49.4$ $7.1 \times 16 = 113.3$ $9.2 \times 9.1 = 84$ $1.7 \times 7.2 = 12.1$
Screened Porch	157 Sq ft	$9.9 \times 15.8 = 157$