

Building Sketch (Page - 1)

Borrower	Betty S. Brown				
Property Address	455 Hogan Farm Road				
City	Seagrove	County	Montgomery	State	NC
Lender/Client	Betty S. Brown				
				Zip Code	27341

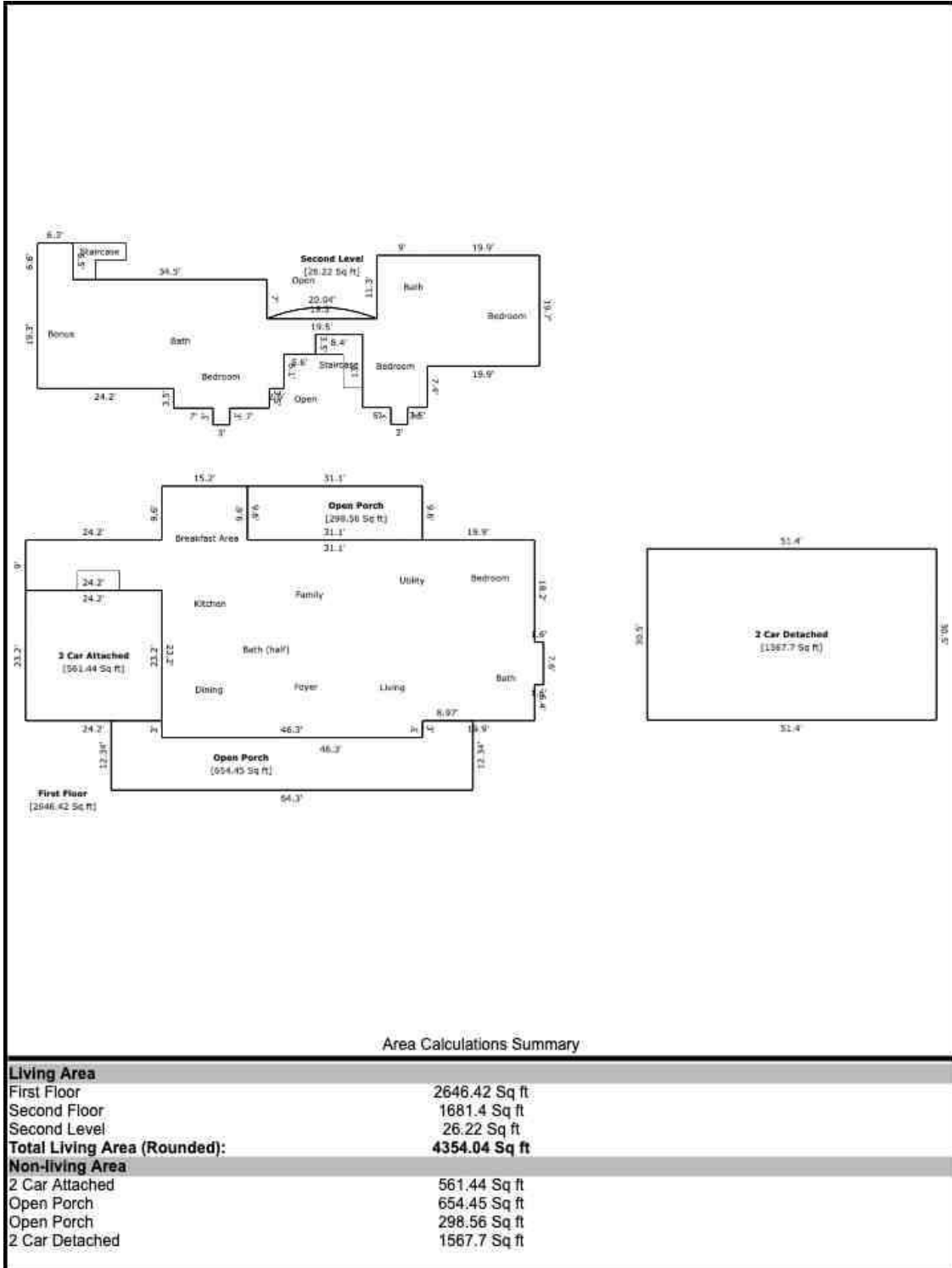

Building Sketch (Page - 2)

Borrower	Betty S. Brown				
Property Address	455 Hogan Farm Road				
City	Seagrove	County	Montgomery	State	NC
Lender/Client	Betty S. Brown				
				Zip Code	27341

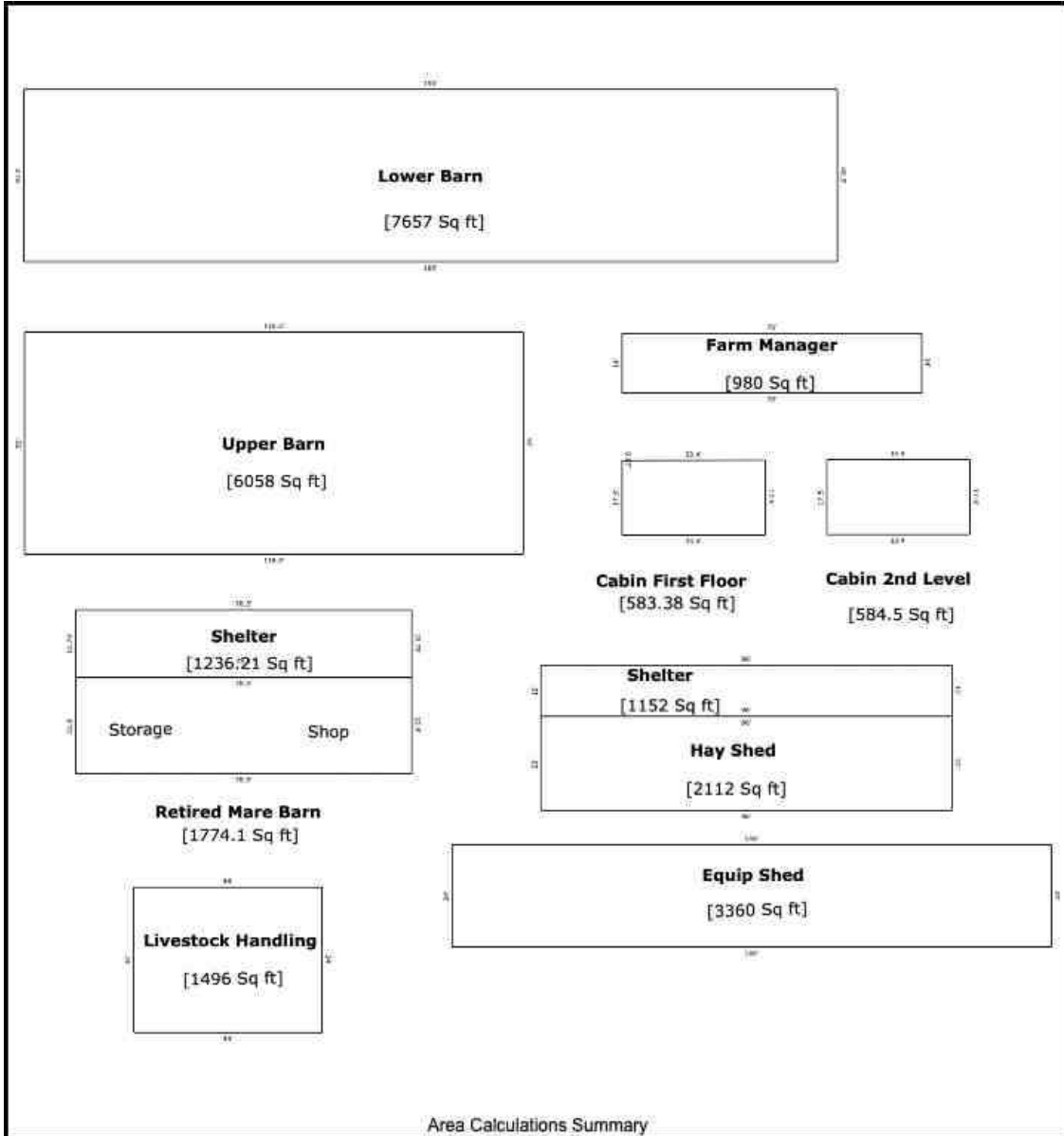

Area Calculations Summary

Non-living Area	
Lower Barn	7657 Sq ft
Upper Barn	6058 Sq ft
Farm Manager	980 Sq ft
Cabin First Floor	583.38 Sq ft
Cabin 2nd Level	584.5 Sq ft
Retired Mare Barn	1774.1 Sq ft
Shelter	1236.21 Sq ft
Hay Shed	2112 Sq ft
Shelter	1152 Sq ft
Equip Shed	3360 Sq ft
Livestock Handling	1496 Sq ft

Building Sketch (Page - 3)

Borrower	Betty S. Brown				
Property Address	455 Hogan Farm Road				
City	Seagrove	County	Montgomery	State	NC
Lender/Client	Betty S. Brown				
				Zip Code	27341

Area Calculations Summary			
Living Area			
First Floor	2646.42 Sq ft	Calculation Details	
		7.6×1.6	= 12.16
		15.2×9.6	= 145.92
		46.3×3	= 138.9
		66.2×23.2	= 1535.84
		90.4×9	= 813.6
Second Floor	1681.4 Sq ft	3×3	= 9
		3×3	= 9
		17×3.5	= 59.5
		11.5×7.4	= 85.1
		43.8×6.1	= 267.18
		31.4×5.6	= 175.84
		49.4×3.5	= 172.9
		89.2×2.8	= 249.76
		40.8×7	= 285.6
		6.3×6.5	= 40.95
		28.9×11.3	= 326.57
Second Level	26.22 Sq ft	Arc	= 26.22
Total Living Area (Rounded):	4354.04 Sq ft		
Non-living Area			
2 Car Attached	561.44 Sq ft	Calculation Details	
		24.2×23.2	= 561.44
Open Porch	654.45 Sq ft	64.3×9.34	= 600.45
		8.97×3	= 26.9
		9.03×3	= 27.1
Open Porch	298.56 Sq ft	31.1×9.6	= 298.56
2 Car Detached	1567.7 Sq ft	51.4×30.5	= 1567.7
Lower Barn	7657 Sq ft	190×40.3	= 7657
Upper Barn	6058 Sq ft	116.5×52	= 6058
Farm Manager	980 Sq ft	70×14	= 980
Cabin First Floor	583.38 Sq ft	$0.5 \times 33.4 \times 0.07$	= 1.12
		33.4×17.43	= 582.25
Cabin 2nd Level	584.5 Sq ft	33.4×17.5	= 584.5
Retired Mare Barn	1774.1 Sq ft	78.5×22.6	= 1774.1
Shelter	1236.21 Sq ft	78.5×15.75	= 1236.21
Hay Shed	2112 Sq ft	96×22	= 2112
Shelter	1152 Sq ft	12×96	= 1152
Equip Shed	3360 Sq ft	140×24	= 3360
Livestock Handling	1496 Sq ft	44×34	= 1496